



## Uxbridge Road, W13

### £399,950

This sleek two-bedroom flat offers a bright, contemporary lifestyle with a spacious reception room and a modern open-plan kitchen perfect for entertaining. Life here is all about ease, with the added perks of secure underground parking and lift access up to the first floor.

You couldn't be better placed to enjoy the vibrant energy of the local area, with the shops, bars, and restaurants of Ealing Broadway just a short stroll away. Whether you're grabbing a coffee at a nearby café or commuting via the Elizabeth Line, everything is within easy reach.

### Features

- Two Bedrooms
- First Floor
- Lift Access
- Underground Parking
- Modern
- No Onward Chain

# Uxbridge Road, London, W13

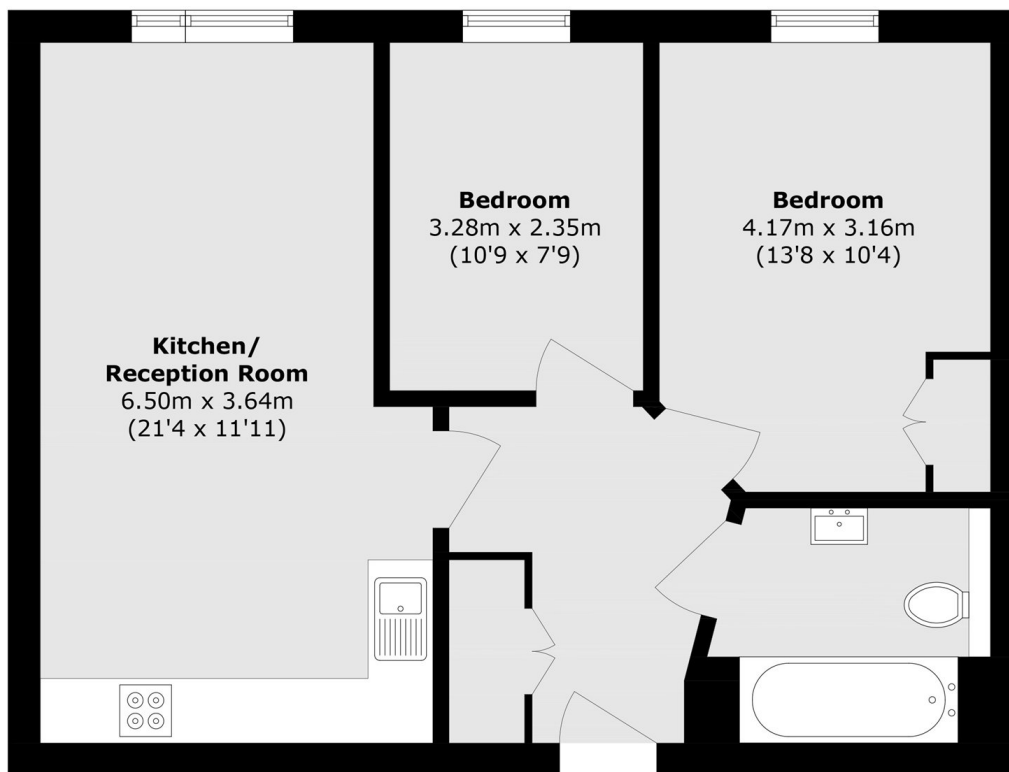

## First Floor

Total area (approx.): 57.3 sq. m (616.8 sq. ft)