



Chesterton Road, W10

£650,000

A two double bedroom garden flat in a Victorian Conversion, presented in good condition throughout. This will be an ideal purchase for anyone that loves summer entertaining and being close to amenities.

Wonderfully located on a quiet residential street just off Ladbroke Grove and close to the café's, bars, boutiques and restaurants of Portobello Road.

Features

- Two Double Bedrooms
- Garden
- Separate Kitchen
- Own Front Door
- Victorian Conversion
- Share Of Freehold

Chesterton Road, London, W10

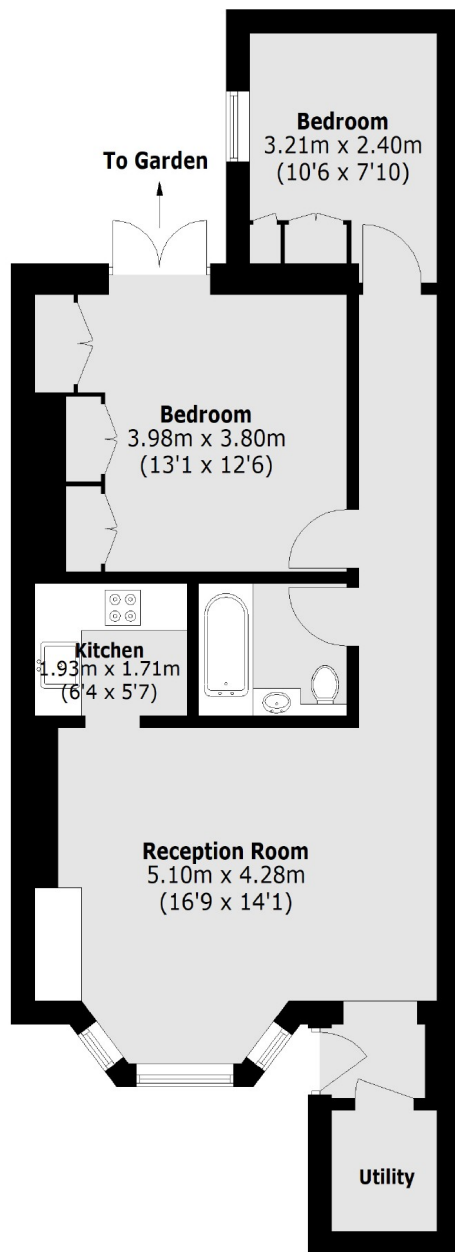

Total area (approx.): 60.7 sq. m (653.4 sq. ft)