

RESIDE

MANCHESTER



20 The Gallery 347 Moss Lane East
Hulme, Manchester, M14 4LB

Asking Price £145,000



2



1



1



3

D

20 The Gallery 347 Moss Lane East

Hulme, Manchester, M14 4LB

Two Bedroom apartment located in The Gallery development, with parking included.

Situated on the outskirts of Manchester City Center, this property is located a 5-minute walk from Oxford Road, where the universities can be found along with various independent shops, restaurants and bars. As well as being located a 12-minute walk to Hulme High Street Retail Park, where multiple retail stores can be found, such as Asda Superstore and the Market Hall. Whilst being a short walk away from the world-famous Curry Mile!

The Gallery is located close to Whitworth Park, home to the Whitworth Art Gallery and is only a brief walk away from Oxford Road where a variety of bars, restaurants and the university can be found. As well as being located along the bus routes for a short ride into the City Centre.

Vacant possession - viewings recommended.





The Tour

Apartment 20 is located on the 1st floor of The Gallery. The property benefits from a secure parking space. Entering into a spacious hallway with doors leading to the rest of the accommodation.

Living/Kitchen - Open plan living/kitchen area, laminate wooden floor throughout the apartment. Large windows allowing in lots of light.

Bedrooms - Wooden floor throughout, TV points and a double glazed window.

Bathroom - Panelled bath with wall mounted mixer shower, low level WC and a wash hand basin. Partial tiled wall and vinyl flooring.

The Area

Situated on outskirts of Manchester City Center, this property is located a 5 minute walk from Oxford Road, where the universities can be found along with various independent shops, restaurants and bars. As well as being located a 12 minute walk to Hulme High Street Retail Park, where multiple retail stores can be found, such as Asda Superstore and the Market Hall. Whilst being a short walk away from the world famous Curry Mile!

Lease Information

Length of lease - 125 years from January 2006

Service charge - £1,678.83

Ground rent - £200 per annum

- Two Bedrooms
- Parking
- Walking Distance to Manchester University
- Vacant Possession
- Lots of Natural Light
- EPC Rating D
- Short walk to hospital
- Chain Free

Floor Plan

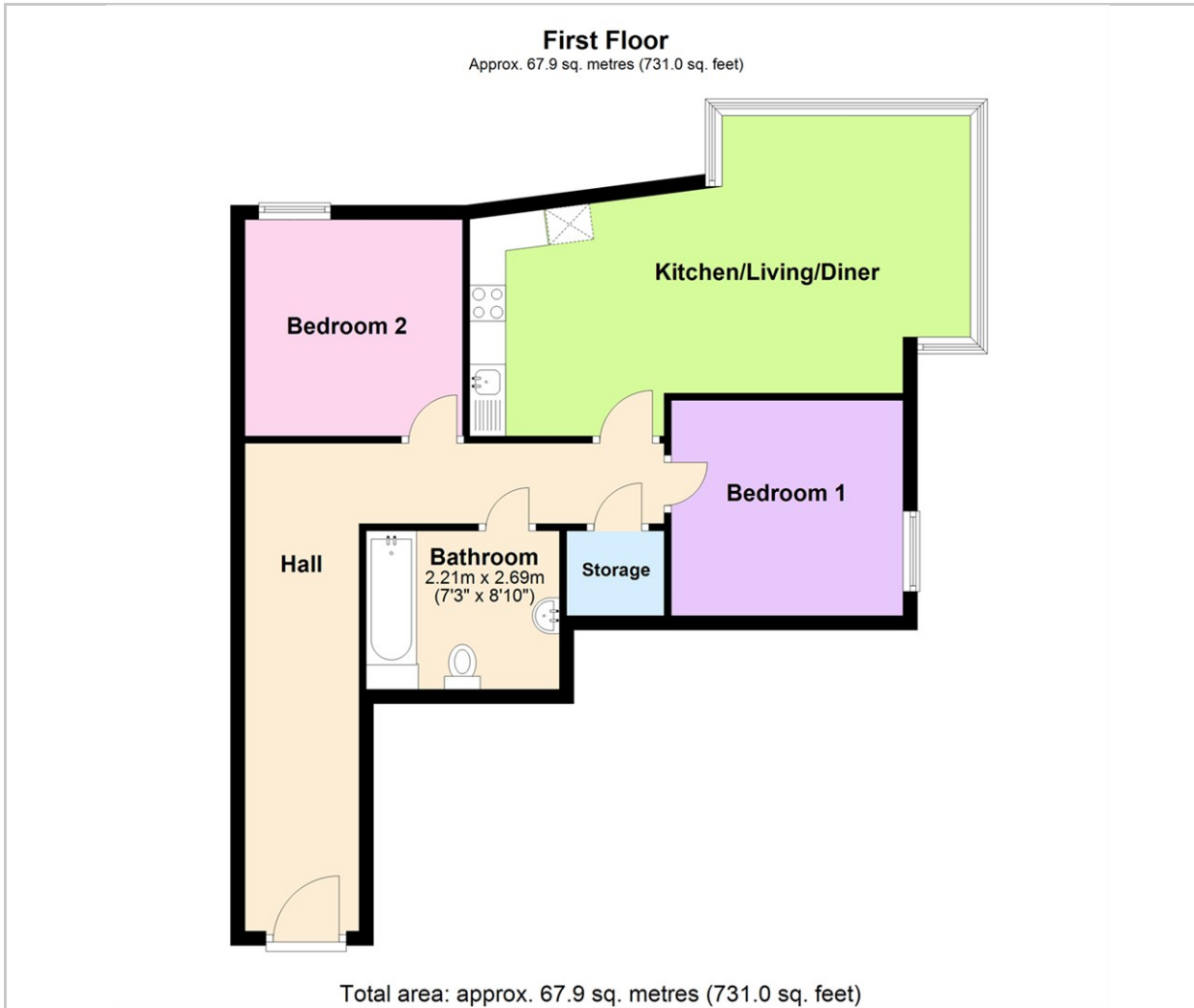

Viewing

Please contact our Reside Manchester Office on 0161 837 2840 if you wish to arrange a viewing appointment for this property or require further information.

These particulars, whilst believed to be accurate are set out as a general outline only for guidance and do not constitute any part of an offer or contract. Intending purchasers should not rely on them as statements of representation of fact, but must satisfy themselves by inspection or otherwise as to their accuracy. No person in this firm's employment has the authority to make or give any representation or warranty in respect of the property.

Area Map

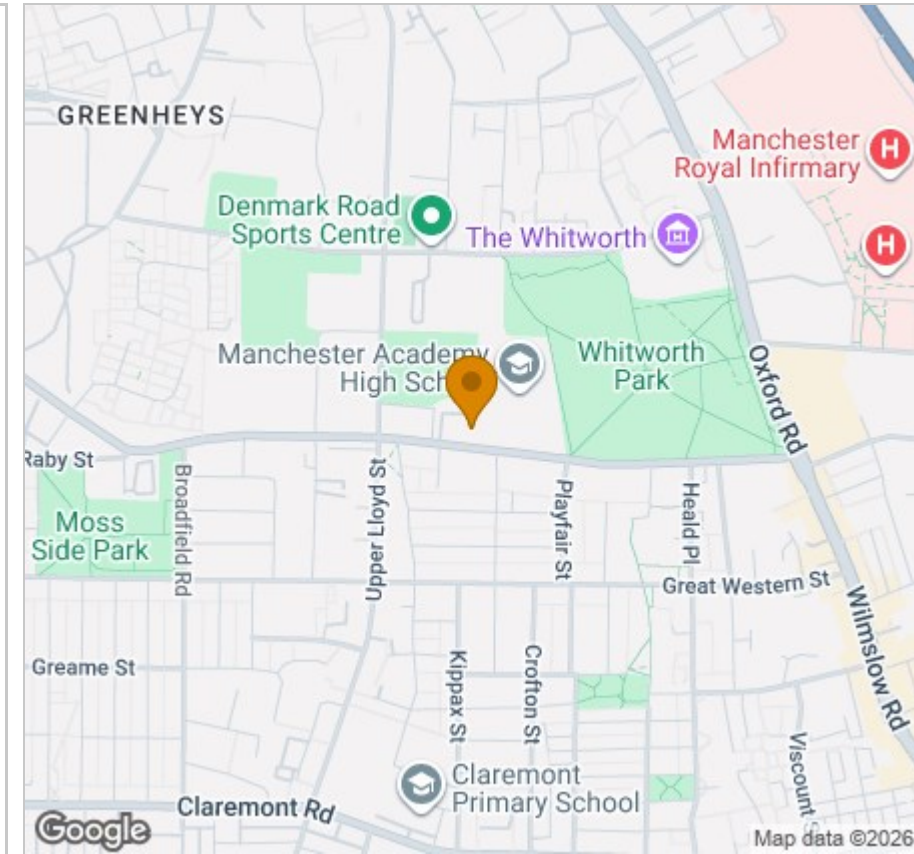

Energy Efficiency Graph

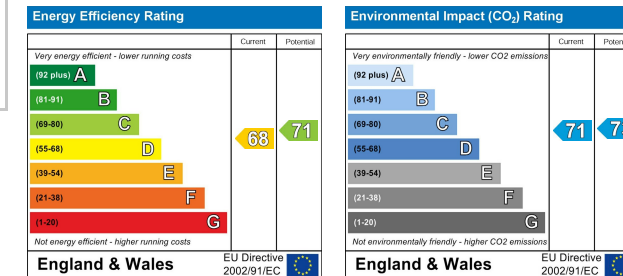

Upper Ground, 4 Jordan Street, Manchester, Greater Manchester, M15 4PY

Tel: 0161 837 2840 Email: info@residemanchester.com www.residemanchester.com