



SHOOT UP HILL, NW2

£646 per week

This spacious three bedroom mansion flat is ideally situated on the borders of West Hampstead and Cricklewood. The property has three double bedrooms, one with an en suite shower room, a well-sized

Three Bedrooms
Spacious Reception
Separate Kitchen

Two Bathrooms
Good Storage
Off Street Permit Parking

@marshandparsons
marshandparsons.co.uk

MARSH &
PARSONS

STEP INSIDE SHOOT UP HILL

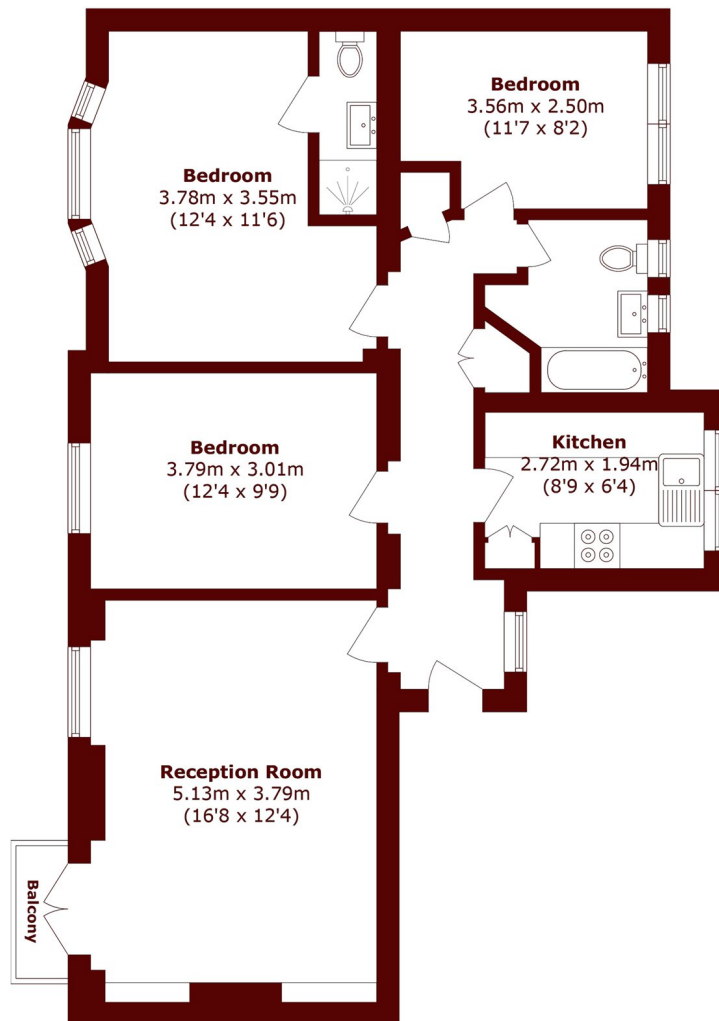

Total area (approx.): 77.9 sq. m (838.5 sq. ft)

Balcony area (approx.): 1.2 sq. m (12.9 sq. ft)

Willesden Green
020 8939 1780

Energy Rating: We aim to make our particulars both accurate and reliable. However, they are not guaranteed; nor do they form part of an offer or contract. If you require clarification on any points then please contact us, especially if you're traveling some distance to view. Please note that appliances and heating systems have not been tested and therefore no warranties can be given as to their good working order

**MARSH &
PARSONS**