 **3**
Bedrooms

 **2**
Bathrooms

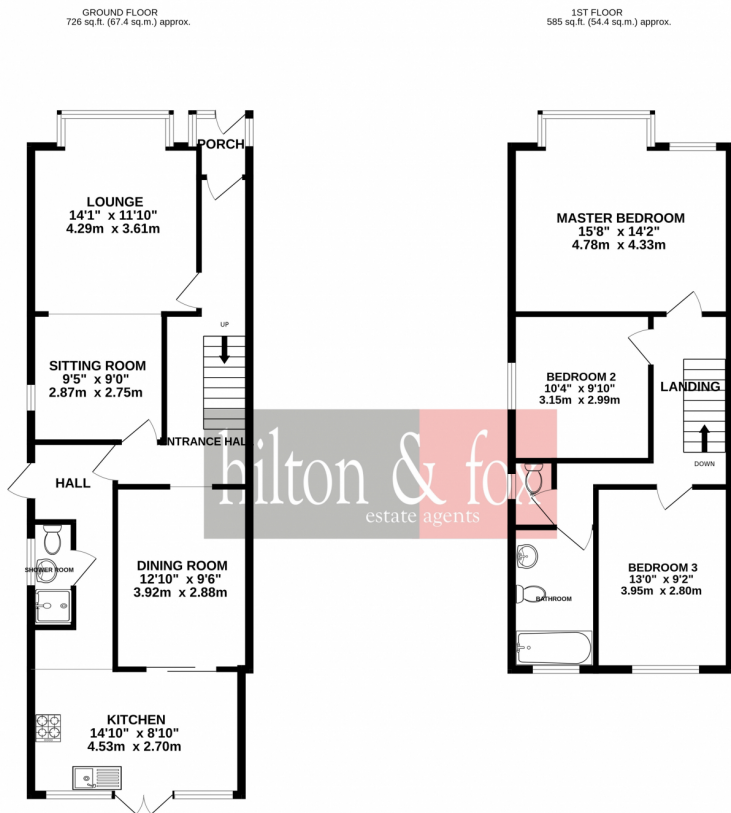

Located just a short distance from Sudbury Town Station is this Three Double Bedroom extended semi-detached family home. Internally to the ground floor you will find a lounge, sitting room, dining room, guests shower room and large family kitchen. To the first floor there are all three bedrooms, the family bathroom and separate WC. Externally there is off street parking to the front whilst to the rear there is a private North Facing Family Garden. Call now to book your appointment.



hilton & fox
estate agents

TOTAL FLOOR AREA: 1311 sq.ft. (121.8 sq.m.) approx.
 Whilst every attempt has been made to ensure the accuracy of the floorplan contained here, measurements of doors, windows, rooms and any other items are approximate and no responsibility is taken for any error, omission or mis-statement. This plan is for illustrative purposes only and should be used as such by any prospective purchaser. The services, systems and appliances shown have not been tested and no guarantee as to their operability or efficiency can be given.
 Made with Metropack 62012.

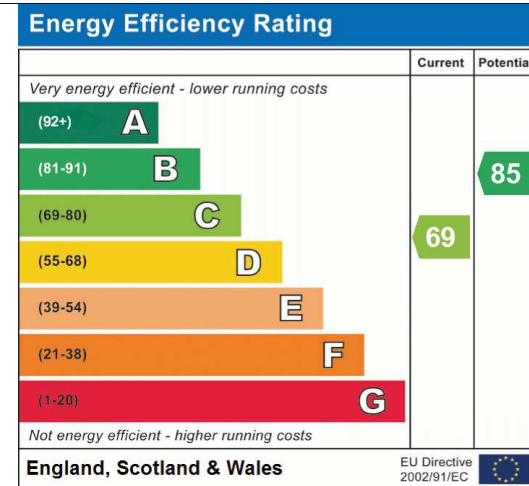

Address: Central Road, Wembley, Middlesex HA0





Vale Farm Sports Centre

Partyman World of Play

Mumbai Junction Restaurant Wembley |...

The Aura

Arena Lounge UK

Barham Park

Sudbury Town

Wembley Centre for Health and Care

Horsenden Hill Activity Centre

Sudbury Golf Club

LNER Sports and Social Club

Sudbury & Harrow Road

Rugby Ave

Beaumont Ave

Sudbury Ave

Sylvester Rd

Crawford Ave

Harrow Rd

Talbot Rd

Sudbury Heights Ave

Eli's Hair & Beauty Salon

Whitton Ave E

Oakwood Cres

Robin Hood Way