



RESIDENCE

1 Dunlop Court, Strathaven, ML10 6LW

www.residencestateagents.co.uk



Viewing by appointment with Residence Strathaven

T: 01357 572222 | E: strathaven@residencestateagents.co.uk | A: 3 Bridge Street, Strathaven, ML10 6AN





2 Bedrooms | 1 Public Rooms | 1 Bathrooms

Set within one of Strathaven's most charming traditional sandstone buildings, this beautifully modernised two-bedroom ground floor apartment perfectly blends period character with contemporary style. Ideally located just a short walk from the picturesque Strathaven Common Green, it offers a peaceful setting with easy access to local amenities.

The stylish, upgraded accommodation is arranged over one level and comprises a bright and welcoming entrance hallway, complete with excellent storage and elegant herringbone flooring that flows seamlessly into the impressive front-facing lounge. The lounge benefits from two large picture windows with fitted shutters, creating a light-filled and inviting living space.

The beautifully appointed modern kitchen/dining area has been thoughtfully designed, featuring a range of base and wall-mounted units, integrated appliances, and direct access to the rear communal gardens via a convenient rear door.

There are two generous double bedrooms, both offering excellent built-in storage, while a contemporary family bathroom completes the accommodation.

Further benefits include gas central heating, double glazing, well-maintained communal gardens to the rear, ample residents' parking, and a private garage.

Strathaven is a charming market town located just south of East Kilbride and Hamilton. It offers a strong sense of community along with a wide range of local amenities, including shops, cafés, restaurants, pubs, and a large Sainsbury's. The town also boasts excellent leisure facilities, such as swimming baths, bowling clubs, golf courses, scenic parks, and picturesque country walks. Highly regarded for its school catchment and convenient commuting options, Strathaven benefits from excellent road links to nearby towns and beyond.



871.88 sq ft | EER = C



RESIDENCE





Dunlop Court

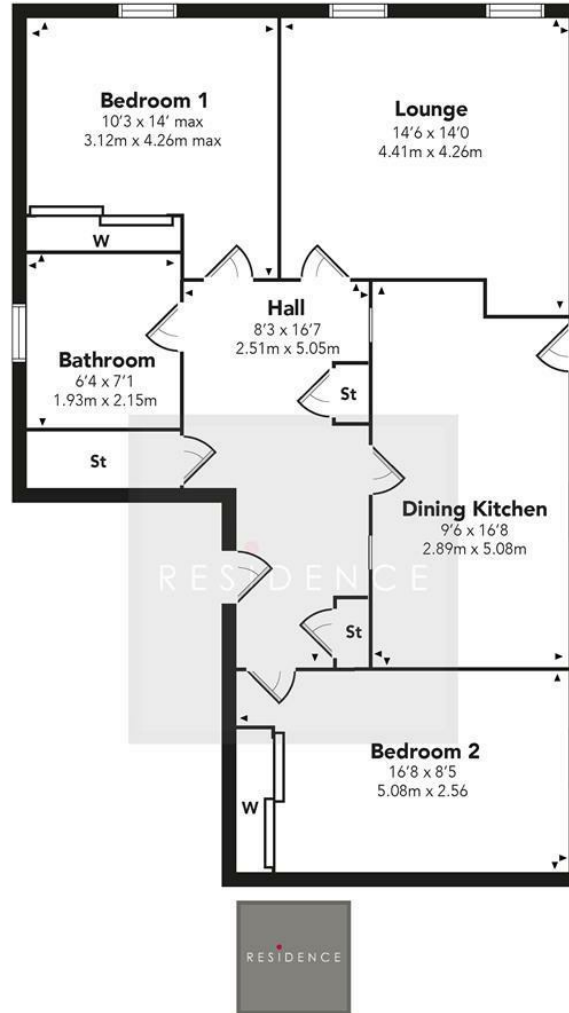

Floor Plan measurements are approximate and are for illustrative purposes only. While we do not doubt the floor plans accuracy, we make no guarantee, warranty or representation as to the accuracy and completeness of the floor plan. You or your advisors should conduct a careful, independent investigation of the property to determine to your satisfaction as to the suitability of the property for your space requirements.

Produced by Plush Plans Ltd

We believe these details to be accurate; however, they do not form any part of a contract. Fixtures and fittings are not included unless specified in the enclosed. Photographs are for general information and it must not be inferred that any item is included for sale with the property. All distances and measurements are approximate. Floorplans may not be to scale and are for illustration purposes only.