

Grantham Road, Reading

£450,000 Freehold

Fully Refurbished Throughout • No Onward Chain • Three Bedroom Home • Stunning Family Bathroom • Private Rear Garden • Driveway And Garage • Planning Permission Granted • Immaculate Home

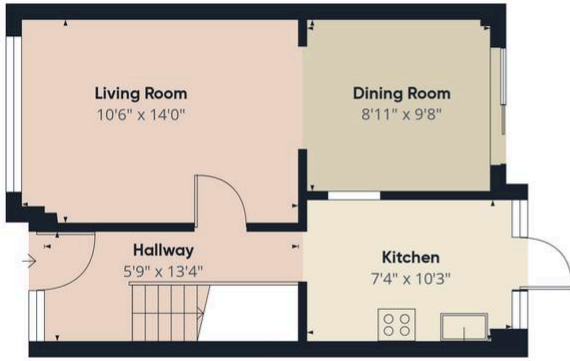



Floor 0 Building 1



Floor 1 Building 1



Floor 0 Building 2

Approximate total area⁽¹⁾
903 ft²

(1) Excluding balconies and terraces

Calculations reference the RICS IPMS 3C standard. Measurements are approximate and not to scale. This floor plan is intended for illustration only.

GIRAFFE360

You can include any text here. The text can be modified upon generating your brochure.



- Hallway**
5' 9" x 13' 4" (1.75m x 4.06m)
- Kitchen**
7' 4" x 10' 3" (2.24m x 3.12m)
- Dining Room**
8' 11" x 9' 8" (2.72m x 2.95m)
- Living Room**
10' 6" x 14' 0" (3.20m x 4.27m)
- Landing**
6' 9" x 9' 6" (2.06m x 2.90m)

- Family Bathroom**
8' 0" x 5' 6" (2.44m x 1.68m)
- Master Bedroom**
9' 11" x 13' 0" (3.02m x 3.96m)
- Bedroom Two**
8' 9" x 9' 7" (2.67m x 2.92m)
- Bedroom Three**
6' 8" x 5' 6" (2.03m x 1.68m)
- Garage**
8' 4" x 15' 10" (2.54m x 4.83m)

