



Whatman Drive  
Maidstone ME14 5FZ  
Guide Price £300,000



COUNTRY HOMES

## Maidstone ME14 5FZ

\* Guide price £300,000- £310,000 \*

We are excited to introduce our new listing in Weaving, Maidstone.

This modern home comes with three bedrooms, over three floors.

Downstairs there's an open-plan kitchen/living/dining room with French doors to the patio garden.

On the first floor you'll find a double bedroom, family bathroom and a 3rd bedroom ideal for an office or nursery. Your main bedroom with dressing area can be found on the top floor.

This "ready to move straight into" home, has a garage for a single car, visitor parking bays and on road parking.

Perfect location for everything, close by to Mote park, shopping amenities like M&S and next, as well as Maidstone town centre, local primary and secondary schools and close to the M20 Junction 7.

Call now to arrange a viewing!

- Close to schools
- Close to shops
- M20 junction 7



GROUND FLOOR  
269 sq.ft. (25.0 sq.m.) approx.

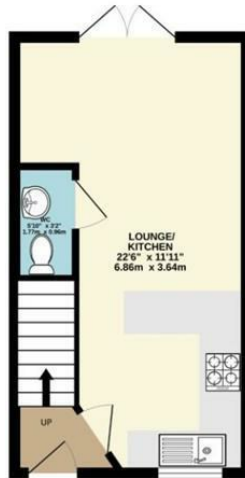

1ST FLOOR  
270 sq.ft. (25.0 sq.m.) approx.

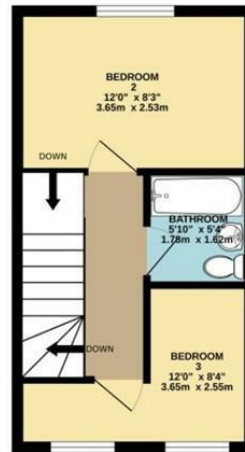

2ND FLOOR  
214 sq.ft. (19.9 sq.m.) approx.

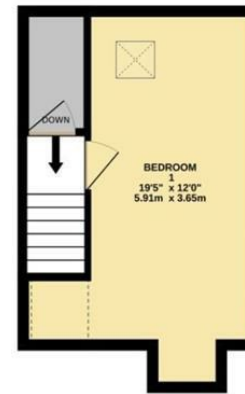

184 sq.ft. (17.1 sq.m.) approx.



TOTAL FLOOR AREA : 936 sq.ft. (86.9 sq.m.) approx.

Whilst every attempt has been made to ensure the accuracy of the floorplan contained here, measurements of doors, windows, rooms and any other items are approximate and no responsibility is taken for any error, omission or mis-statement. This plan is for illustrative purposes only and should be used as such by any prospective purchaser. The services, systems and appliances shown have not been tested and no guarantee as to their operability or efficiency can be given.  
Made with Metropix ©2025

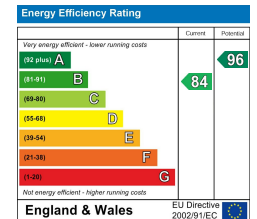





## Location Map

Tenure: Freehold

Council tax band: D

Charges

Management Charge- £320 PA  
Reviewed Annually

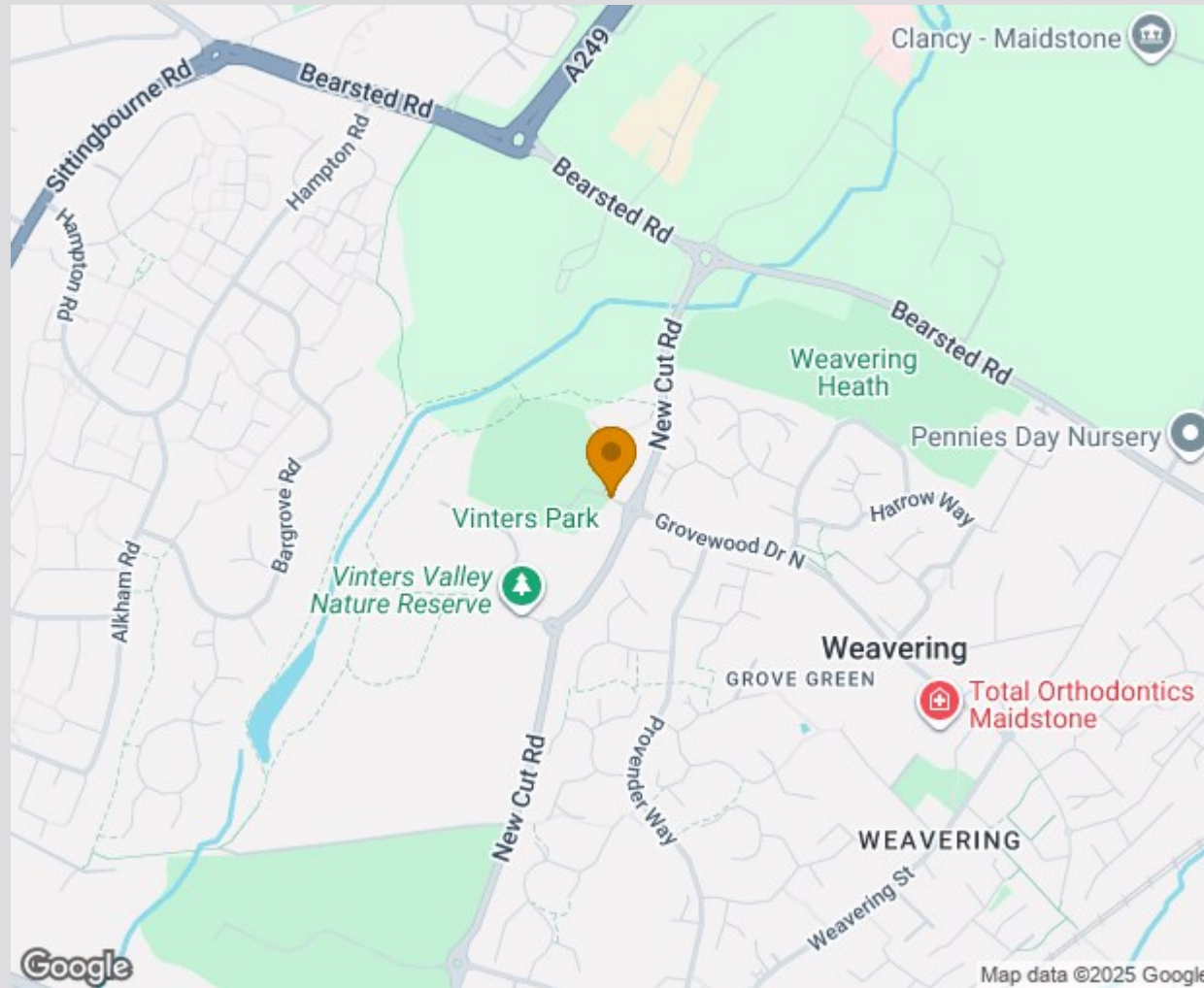

TO VIEW CONTACT: 01622 94 22 22 [allington@khp.me](mailto:allington@khp.me)

[www.khp.me](http://www.khp.me)



**Zoopla.co.uk**  
Smarter property search

