



Saville Road, Romford, RM6 6DT

£2,300 Per Calendar Month





£2,300 Per Calendar Month

Saville Road

Romford, RM6 6DT

- Four Bedrooms
- Two Bathrooms
- Great Location
- End of Terrace
- Chadwell Heath Train Station (Elizabeth Line)

A four bedroom end of terrace house on Saville Road, Chadwell Heath.

On the ground floor consists of a reception/dining room, one bedroom, shower room and kitchen that leads onto the garden. The first floor houses the principal bedroom, two other bedrooms and a family bathroom. The property further benefits from having a private driveway.

Chadwell Heath train station (Elizabeth Line) is within close proximity, allowing easy access to Central London and beyond. The property also benefits from the open green spaces of St Chad's Park being nearby. The area is renowned for its excellent schools, making it an ideal location for families.



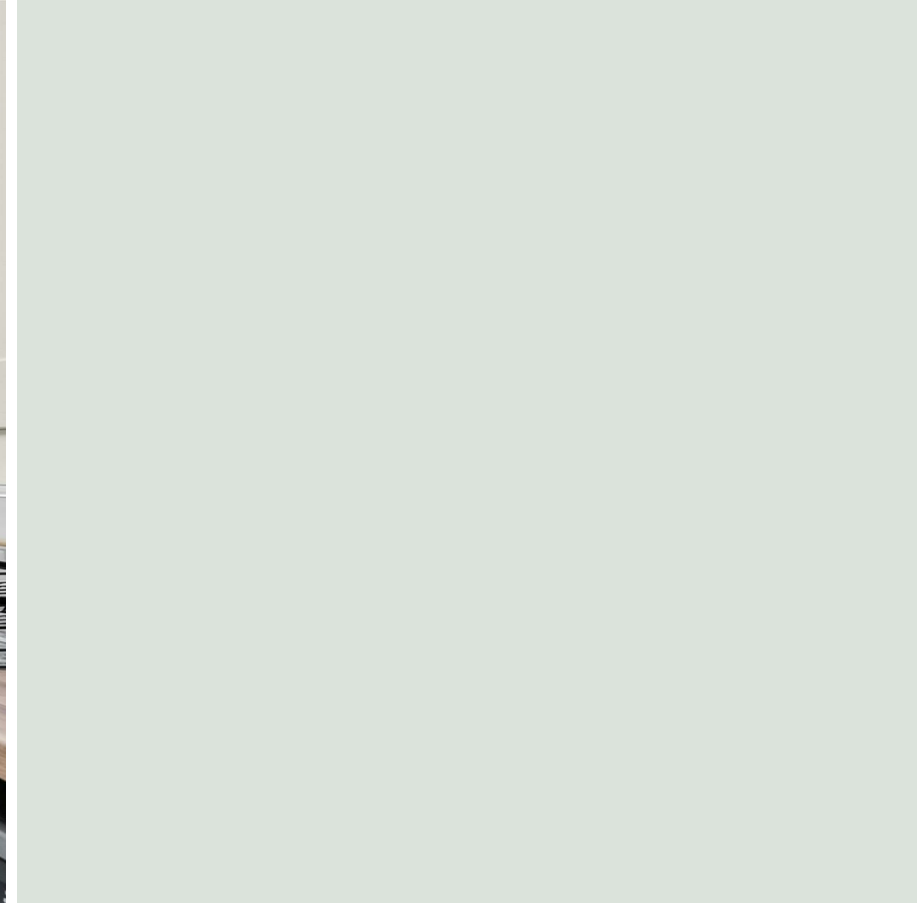

Directions





Floor Plans

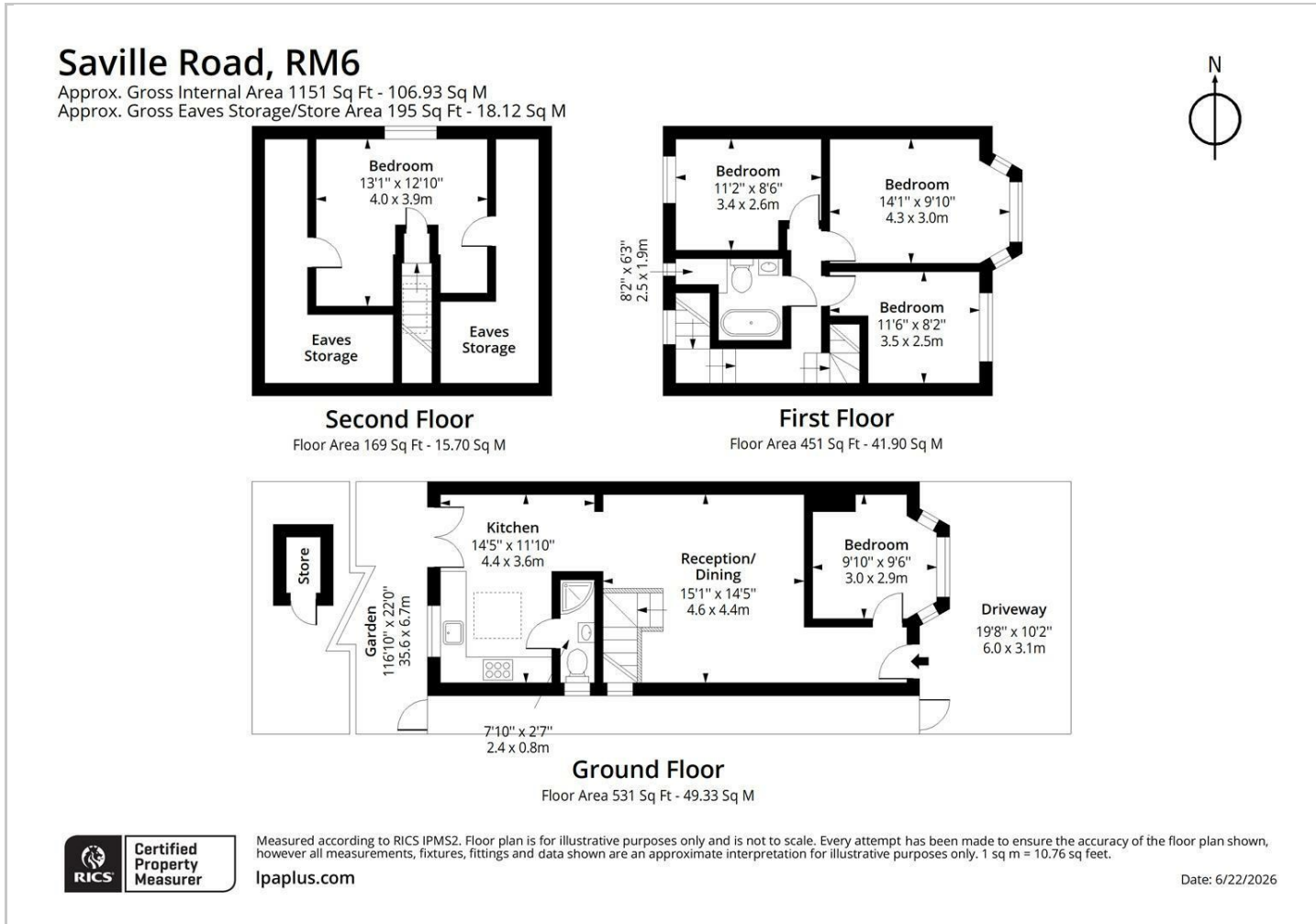

Location Map

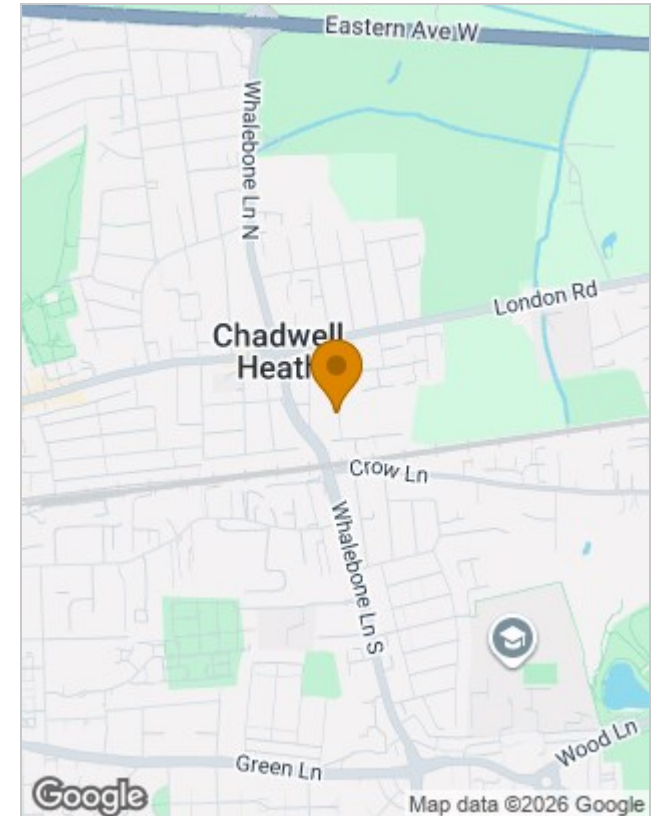

Energy Performance Graph

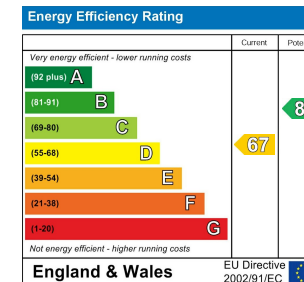

Viewing

Please contact our Redbridge Lettings Office on 020 8551 0211 if you wish to arrange a viewing appointment for this property or require further information.

The particulars are set out as a general outline only for the guidance of intended purchasers or lessees, and do not constitute, any part of a contract. Nothing in these particulars shall be deemed to be a statement that the property is in good structural condition or otherwise nor that any of the services, appliances, equipment or facilities are in good working order. Purchasers should satisfy themselves of this prior to purchasing.