

# DAVID CHARLES

ESTATE AGENTS • VALUERS • SURVEYORS  
THE ESTATE OFFICE • 34 HIGH STREET • PINNER • MIDDLESEX HA5 5PN  
TELEPHONE 020 8866 0222 • FAX 020 8868 3544  
WEBSITE [www.david-charles.co.uk](http://www.david-charles.co.uk) • E-MAIL [enquiries@david-charles.co.uk](mailto:enquiries@david-charles.co.uk)

## ALANDALE DRIVE, PINNER, MIDDLESEX, HA5 3UY



**PRICE....£335,000....LEASEHOLD**

A bright two bedroom ground floor garden maisonette (573 sq. ft/53.2 sq. m) is well located within half a mile of Northwood Hills Town Centre with its array of shops, restaurants, coffee houses and the Metropolitan Line Station. Pinner Wood Primary School and Northwood High School are also within the catchment area. The accommodation comprises of a 13'7ft reception room with a French door to garden, modern fitted kitchen, 15'7ft bedroom one with fitted wardrobes, 12'7ft bedroom two, and a bathroom WC. Outside, there is a well maintained front garden and 32'10ft rear garden with a paved patio leading to lawn with shrub and flower borders. The property benefits from being sold with no upper chain and a unexpired lease terms of 104 years.

**020 8866 0222**







## COUNCIL TAX

London Borough of Hillingdon - Band C - £1,818.19

## LEASE & SERVICE CHARGE

Lease - 104 Years  
Ground Rent - £150 per annum

## LOCAL SCHOOLS

Pinner Wood School - 0.35 Miles  
Hillside Infant & Junior School - 0.39 Miles  
Northwood School - 0.28 Miles  
Haydon School - 0.83 Miles

## LOCAL TRANSPORT

Northwood Hills Station (Metropolitan Line) - 0.5 Miles

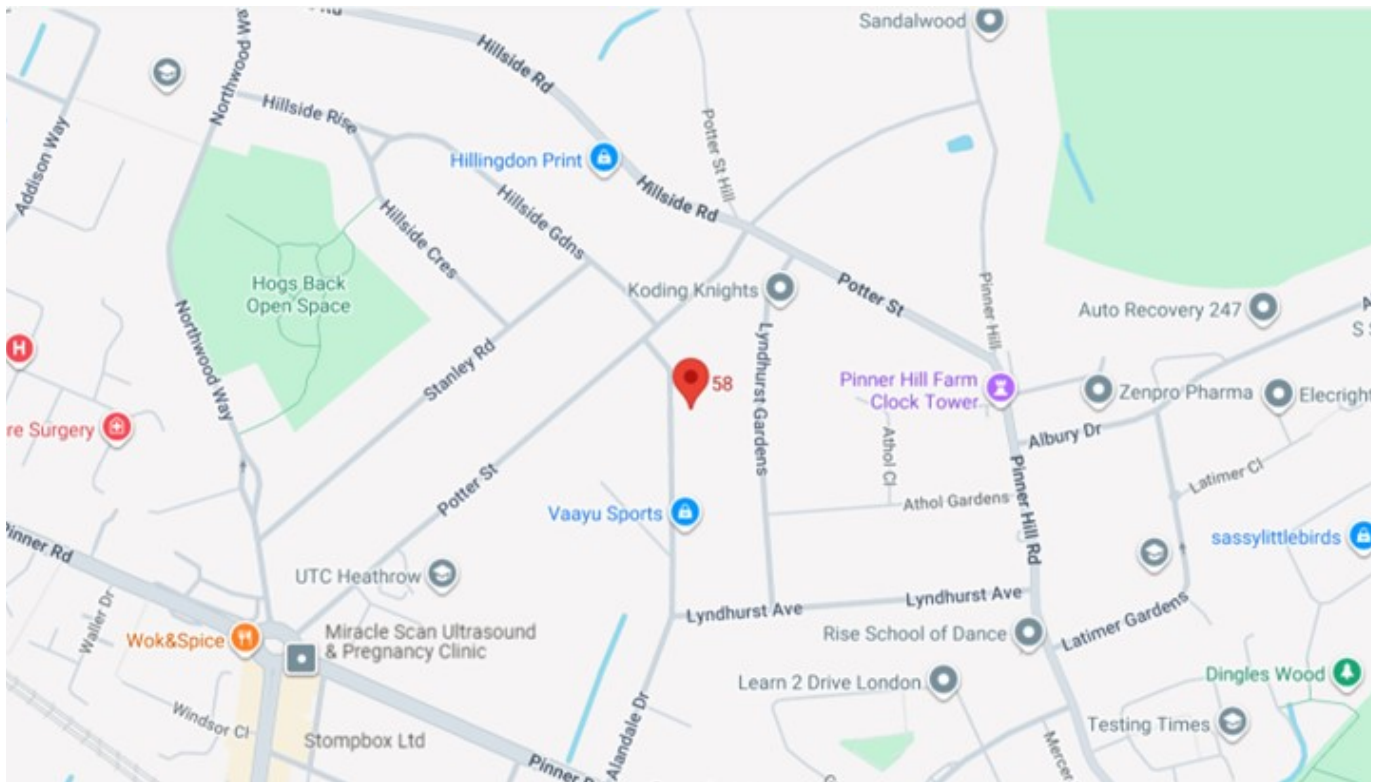

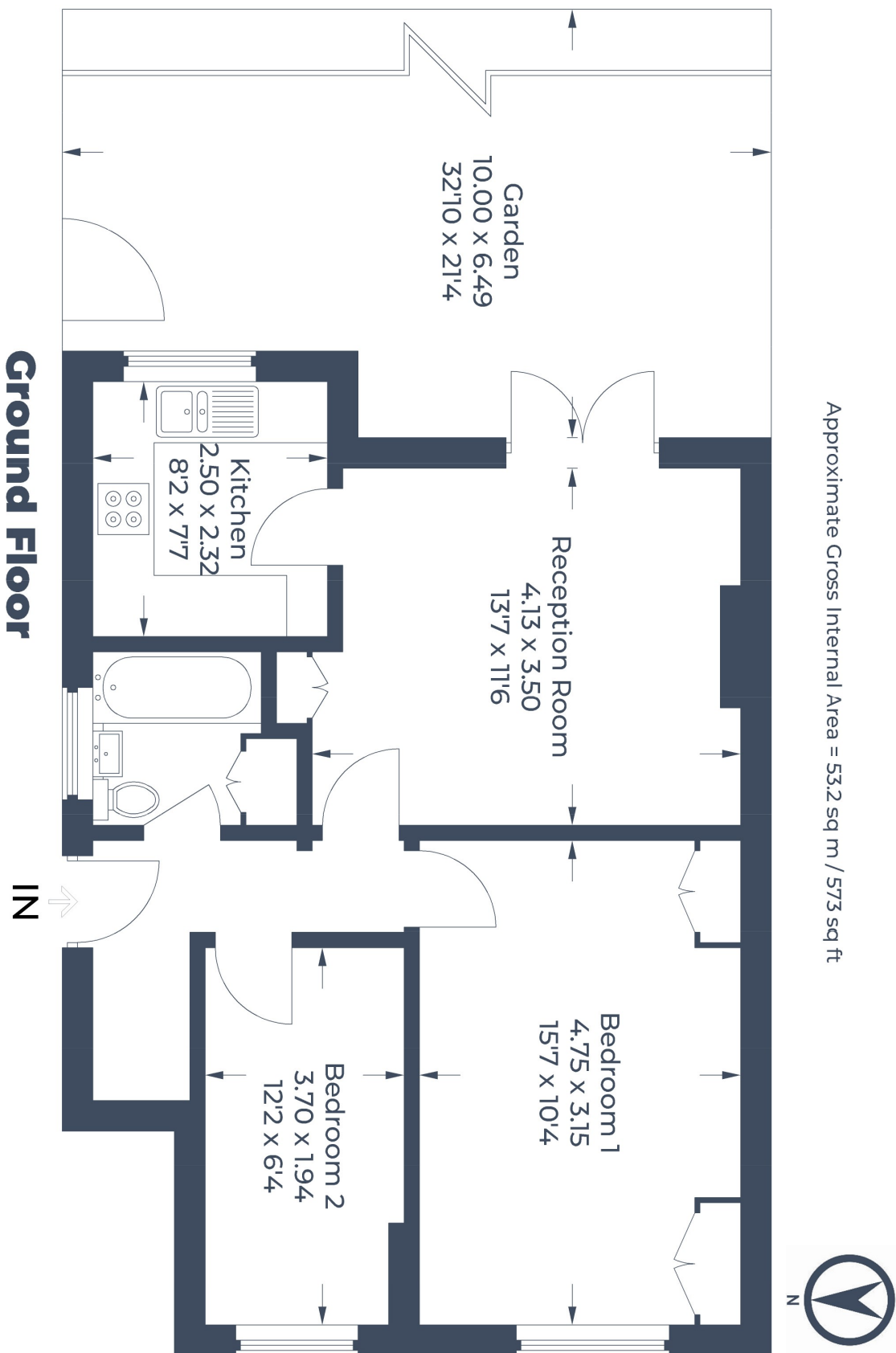

Illustration for identification purposes only,  
measurements are approximate, not to scale.  
© CJ Property Marketing Produced for David Charles

***For appointments to view please call David Charles 020 8866 0222***

*All measurements are taken manually and whilst every care is taken with their accuracy they must be considered approximate and should not be relied upon when purchasing carpets or furniture. No responsibility is taken for any error, omission or misunderstanding in these particulars which do not constitute an offer or contract. Services and appliances have not been tested and therefore no warranty is offered on their operational condition.*