

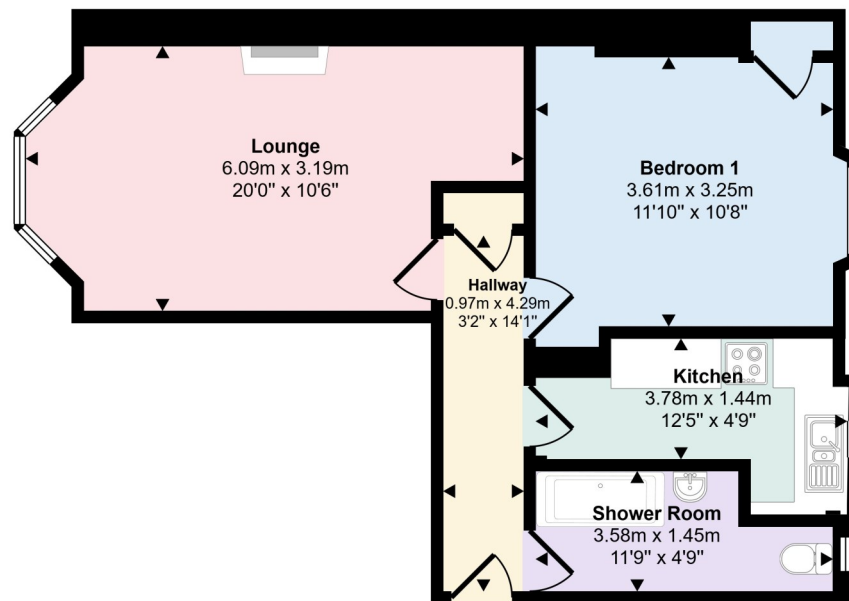

Flat 6, 8 Williamson Avenue, Dumbarton, G82 2AE

A beautifully presented one-bedroom first-floor flat forming part of a traditional tenement on ever-popular Williamson Avenue. Offering generous proportions, classic period character and superb everyday convenience, this property is ideally positioned close to a wide range of local amenities and excellent public transport links.

**Approx Gross Internal Area
49 sq m / 531 sq ft**



Floorplan

This floorplan is only for illustrative purposes and is not to scale. Measurements of rooms, doors, windows, and any items are approximate and no responsibility is taken for any error, omission or mis-statement. Icons of items such as bathroom suites are representations only and may not look like the real items. Made with Made Snappy 360.



David Muir Estate Agents
2 Church Street, Dumbarton,
G82 1QL



Tel 01389 734366
Fax 01389 742476



tracy@davidmuirestates.co.uk



davidmuirestates.com



davidmuirestates

Travel Directions

From the agents office in Church Street proceed to the roundabout. Take the 3rd exit onto Strathleven Place. Continue under the railway bridge onto Bonhill Road. Take the second road on your left onto Hamilton Street and veer right into Williamson Ave. No 8 is on your left and the flat is located on the first floor right hand door .

Additional Information

Home Report Valuation: £90,000
Asking Price: Offers Over £85,000
Council Tax Band: B
Energy Efficiency Rating: C
Gas Central Heating
Double Glazing

Home Report

This property benefits from a Home Report which can be obtained from davidmuirestates.com or onesurvey.org

Disclaimer

These property details are set out as a general outline only and do not constitute any part of an Offer or Contract. All fixtures and fittings mentioned in these particulars are included in the sale. All others in the property are specifically excluded. Photographs are reproduced for general information and it must not be inferred that any item is included for sale with the property. All measurements, distances and areas are approximate and for guidance only.