

## Royal Arch Court, Earlham Road, Norwich - Retirement property - second resident can be over 55.

Guide Price £60,000

 1  1  1



Moneyproperties presents this charming one bedroom apartment offering picturesque views of the impressive St Johns Cathedral. Situated in the heart of Norwich and located in the Royal Arch Court complex, features a spacious 23ft living room with stunning Cathedral views, a well-equipped kitchen, a spacious bedroom with built-in wardrobes, a modern bathroom, and an airing/store cupboard. Residents of Royal Arch Court enjoy the benefits of a secure gated complex with a Court manager, residents lounge, laundry facilities, and beautiful gardens.

**Tenure: Leasehold EPC: C Council Tax: B**

## Key Features

- Secure gated complex with a Court manager offering one bedroom
- Offering approximately 550 sq ft of living space Residents have access to laundry, function room and gardens
- Close to the City centre with all its amenities with impressive views of St Johns Cathedral Norwich
- Newly redecorated and carpet cleaned, ready to move into
- Owner must be over 60 years of age, second owner can be 55 years.
- For Sale by Modern Auction, T & C's apply, Subject to Reserve Price, Buyers fees apply
- Regular bus and rail serves. Parking for visitors
- No Forward chain / quick sale possible
- See our full online listing for further details including flood risk, broadband speed and other material information.

GROUND FLOOR

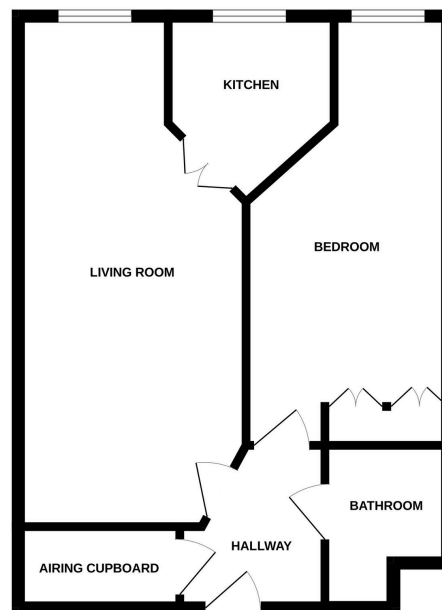

Whilst every attempt has been made to ensure the accuracy of the floorplan contained here, measurements of doors, windows, rooms and any other items are approximate and no responsibility is taken for any error, omission or misstatement. This plan is for illustrative purposes only and should be used as such by any prospective purchaser. The services, systems and appliances shown have not been tested and no guarantee as to their quality or efficiency can be given.  
Made with Metropix ©2025