



**Connells**

Ploughmans End  
Welwyn Garden City



# Ploughmans End Welwyn Garden City AL7 2JG

for sale  
**£275,000**



## Property Description

A well presented one bedroom cluster house, ideally positioned in the ever popular Panshanger area of Welwyn Garden City.

The property offers a bright and welcoming living space with a modern fitted kitchen, designed to make the most of the layout and natural light. Upstairs, the bedroom is well proportioned and benefits from access to the loft, providing useful additional storage, while the bathroom is neatly arranged to serve the home.

Externally, the property enjoys its own front garden, creating a pleasant outdoor space, along with allocated parking close by. Further benefits include gas central heating and a location that offers easy access to local shops, countryside walks and Welwyn Garden City town centre.

An ideal purchase for first time buyers or investors alike.

## Lounge

Double glazed door to the front, radiator, stairs to first floor.

## Kitchen Area

Cupboards at wall and base level, double glazed window to the side, understairs storage, space for washing machine,

integrated oven with extractor over, stainless steel sink with mixer taps.

## First Floor Accomodation

### Bedroom 1

Double glazed window to the front, radiator.

### Bathroom

Three piece suite comprising of panel end bath, low level w/c and wash hand basin.

## Parking

One Allocated parking space









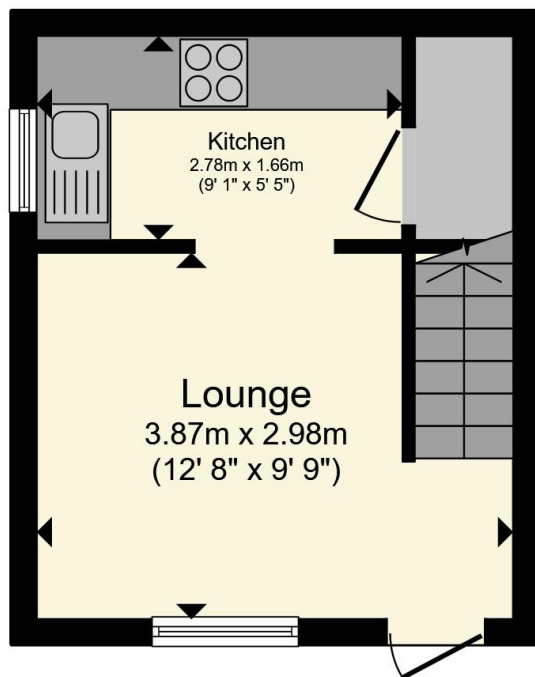

**Ground Floor**

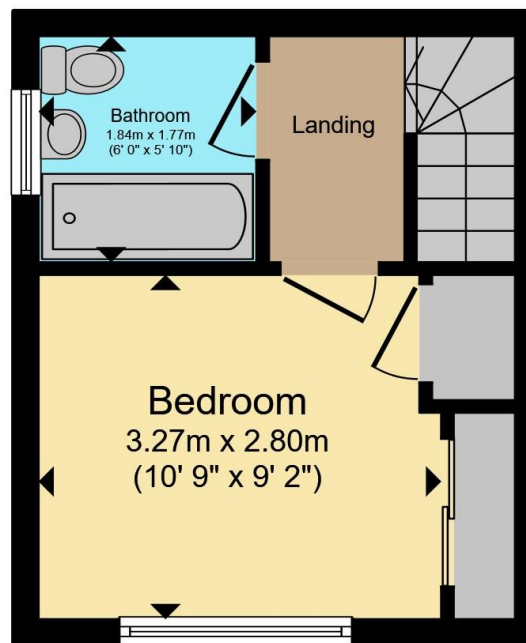

**First Floor**

Total floor area 36.7 m<sup>2</sup> (395 sq.ft.) approx

This floor plan is for illustrative purposes only. It is not drawn to scale. Any measurements, floor areas (including any total floor area), openings and orientation are approximate. No details are guaranteed, they cannot be relied upon for any purpose and they do not form part of any agreement. No liability is taken for any error, omission or misstatement. A party must rely upon its own inspection(s). Powered by [www.propertybox.io](http://www.propertybox.io)

**Connells**

To view this property please contact Connells on

**T 01707 322 903**

**E [welwyngardencity@connells.co.uk](mailto:welwyngardencity@connells.co.uk)**

38 Wigmores North  
WELWYN GARDEN CITY AL8 6PH

EPC Rating: C Council Tax  
Band: B

Tenure: Freehold

**view this property online [connells.co.uk/Property/WWY307485](http://connells.co.uk/Property/WWY307485)**



1. MONEY LAUNDERING REGULATIONS Intending purchasers will be asked to produce identification documentation at a later stage and we would ask for your co-operation in order that there will be no delay in agreeing the sale. 2. These particulars do not constitute part or all of an offer or contract. 3. The measurements indicated are supplied for guidance only and as such must be considered incorrect. Potential buyers are advised to recheck measurements before committing to any expense. 4. We have not tested any apparatus, equipment, fixtures, fittings or services and it is in the buyers interest to check the working condition of any appliances.

Connells Residential is registered in England and Wales under company number 1489613, Registered Office is Cumbria House, 16-20 Hockliffe Street, Leighton Buzzard, Bedfordshire, LU7 1GN. VAT Registration Number is 500 2481 05.

**See all our properties at [www.connells.co.uk](http://www.connells.co.uk) | [www.rightmove.co.uk](http://www.rightmove.co.uk) | [www.zoopla.co.uk](http://www.zoopla.co.uk)**

Property Ref: WWY307485 - 0004