



The Green, Bearsted, Maidstone, , ME14 4EB
Offers In Excess Of £780,000



Situated on a private road opposite the picturesque Bearsted Green, this immaculately presented four-bedroom detached home was built in the 1980's with reclaimed materials from the neighbouring Oast houses, and enjoys a truly enviable position within the conservation area. Blending character with a modern finish, the property offers stylish and flexible living.

Upon entering through the inviting porch, you are welcomed by a bright, open-plan living/dining room which leads through to the versatile family room, with bifold doors opening onto a South East facing private garden, perfect for both entertaining and relaxing. The modern shaker style fully integrated kitchen provides both functionality and convenience finished with premium stone surfaces, and benefiting from convenient side access to the property. A contemporary cloakroom completes the ground floor.

Upstairs, the sense of flexibility continues. The principal bedroom benefits from built-in wardrobes and an en-suite shower room, while three further well-proportioned bedrooms are served by a family bathroom. A simple and inexpensive stud partition wall between bedroom two and four would reinstate their original form if required.

Externally, the property offers a garage and off-street parking for two vehicles. Its sought-after location, within easy reach of local amenities and surrounded by the charm of the Green, makes it ideal for convenient and comfortable living. Tenure: Freehold. Council Tax Band: G. EPC rating: D.

*The family room has been virtually staged.



LOCATION:

The property is ideally positioned on the highly desirable Green, in the heart of Bearsted, providing excellent access to London via the mainline train station which is within a short walk, and the M20 motorway. It is also conveniently close to top-rated schools, including Sutton Valence private school, local grammar schools, and the prestigious Thurnham and Roseacre junior schools. The charming Village Green has a fantastic selection of gastro pubs and restaurants. Residents can enjoy a range of leisure activities at Bearsted's golf, bowls, and tennis clubs. Additionally, the breath-taking landscapes of The Woodland Trust, Leeds Castle, and Mote Park are all within easy reach, further enhancing the appeal of this exceptional location.

ACCOMODATION

GROUND FLOOR:

- Dining Area
- Sitting Area
- Kitchen
- Cloakroom
- Family Room

FIRST FLOOR:

Bedroom 1

En-Suite

Bedroom 2

Bedroom 3

Bedroom 4

Family Bathroom

EXTERNALLY:

Front & Rear Gardens

Garage

Driveway

VIEWING:

Strictly by arrangement with the Agent's Bearsted Office, 132 Ashford Road, Bearsted, Maidstone, Kent ME14 4LX. Tel: 01622 739574.

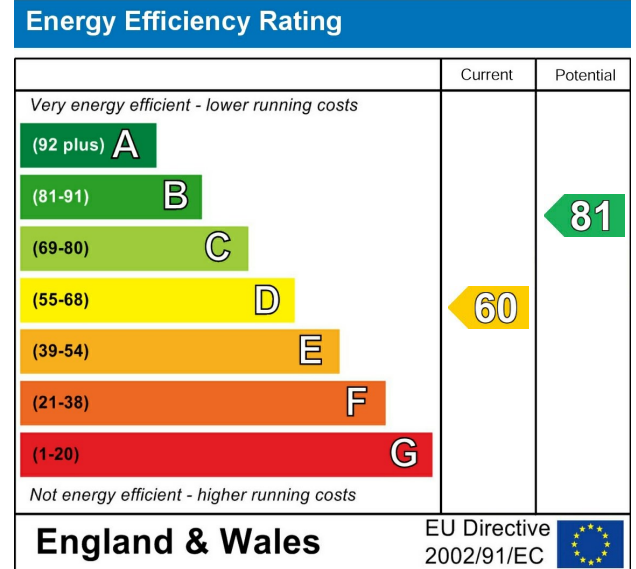

Page & Wells limited for themselves and for the vendors of this property whose agents they are give notice that: 1. These particulars do not constitute any part of, an offer or a contract. 2. All statements contained in these particulars as to this property are made without responsibility on the part of Page & Wells Limited or the Vendor. 3. None of the statements contained in these particulars as to the property is to be relied on as statements or representations of fact. 4. Any intending purchaser must satisfy himself by inspection or otherwise as to the correctness of each of the statements contained in these particulars. 5. The vendor does not make or give, and neither Page & Wells Limited nor any person in their employment has any authority to make or give any representation whatsoever in relation to this property. These particulars are supplied on the understanding that all negotiations are carried out throughout Page & Wells Limited. Properties with a reference prefixes EAA are those which Page & Wells Limited disclose an interest in accordance with the provisions of the Estates Agents Act 1979

The Green, Bearsted, Maidstone
Approximate Gross Internal Area
Main House = 1410 Sq Ft/131 Sq M
Garage = 152 Sq Ft/14 Sq M
Total = 1562 Sq Ft/145 Sq M

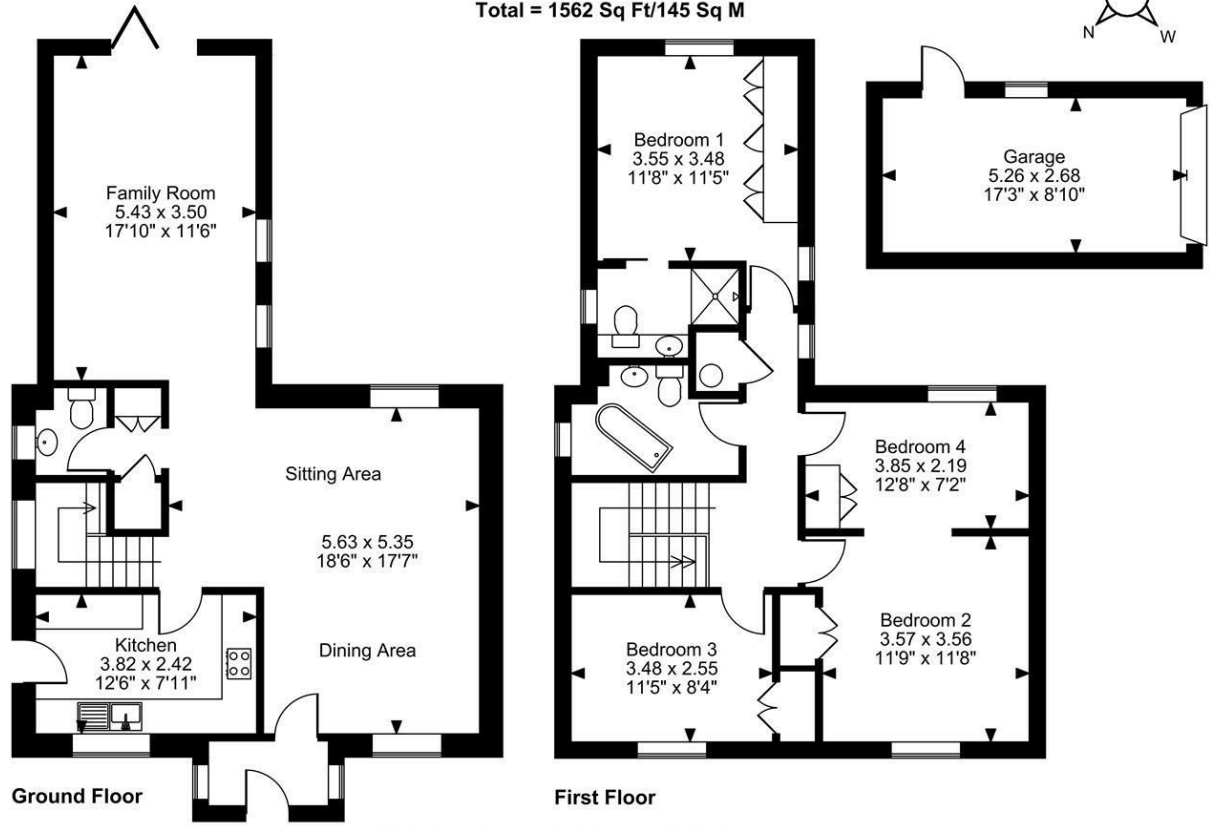
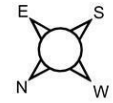

FOR ILLUSTRATIVE PURPOSES ONLY - NOT TO SCALE

The position & size of doors, windows, appliances and other features are approximate only.
 © ehouse. Unauthorised reproduction prohibited. Drawing ref. dig/8687462/LCO

