



WESTMORELAND TERRACE, SW1V

£530 per week

One-bedroom
Seperate Kitchen
Built in storage
Walk in shower
High ceilings
Energy rating: D

@marshandparsons
marshandparsons.co.uk

MARSH &
PARSONS



ABOUT THE PROPERTY

This charming one-bedroom apartment is ideally located on the fringe of the sought after Pimlico Grid' and a short walk to Sloane Square. The property has recently been refurbished throughout and comprise a large living room with large sash windows and natural wooden flooring, a large bedroom with built-in storage and a beautiful contemporary bathroom. The property further benefits from an abundance of natural light and is perfect for a single professional or a couple alike.

Westmoreland Terrace sits on the edge of the Pimlico Grid moments from the transport links of Sloane Square Underground (District and Circle Lines), Victoria Station (District, Circle and Victoria Lines) offering National



STEP INSIDE WESTMORELAND TERRACE

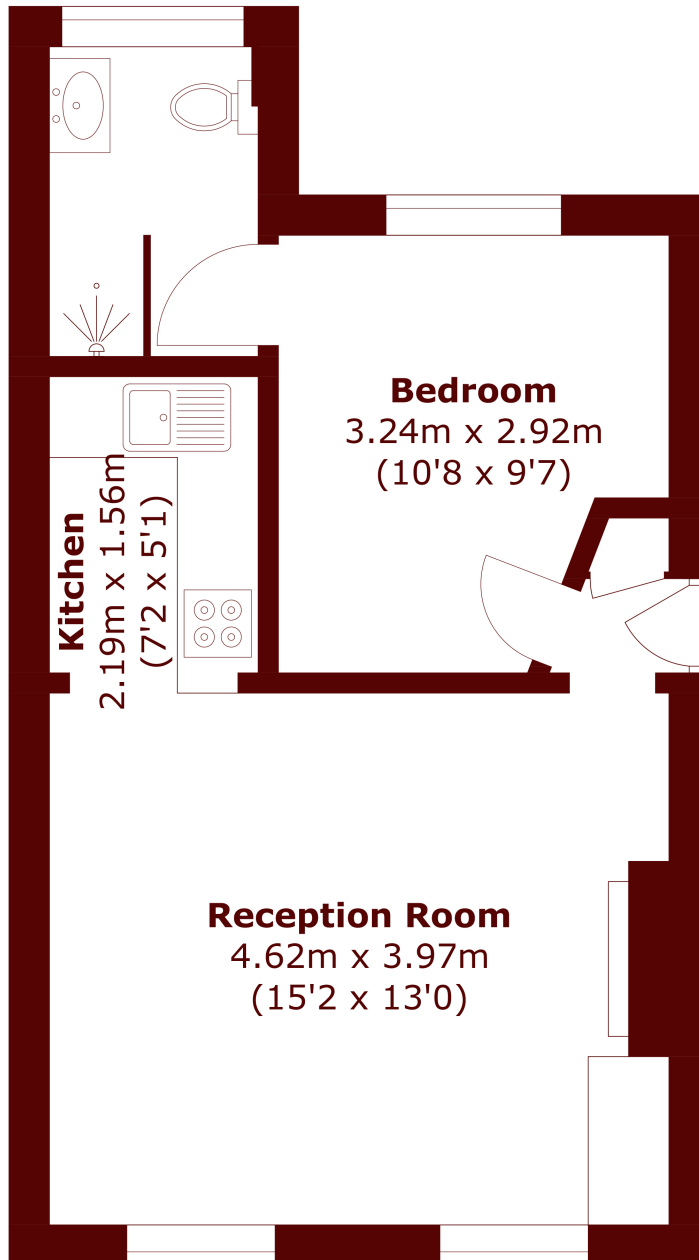

Total area (approx.): 36.1 sq. m (388.6 sq. ft)

Pimlico & Westminster
020 7828 8100

Energy Rating: We aim to make our particulars both accurate and reliable. However, they are not guaranteed; nor do they form part of an offer or contract. If you require clarification on any points then please contact us, especially if you're traveling some distance to view. Please note that appliances and heating systems have not been tested and therefore no warranties can be given as to their good working order

**MARSH &
PARSONS**