



Sadler House

Spa Green Estate, EC1R

Asking Price £500,000

A 2 double bedroom apartment set on the third floor of this architecturally significant Grade II listed development located opposite Sadlers Wells Theatre and within a short distance to Angel Underground station.

CHESTERTONS



Sadler House

Spa Green Estate, EC1R

- Bright 3rd floor apartment
- 2 Double bedrooms
- Architecturally significant development
- Grade II Listed
- Sold with no onwards chain
- Within a short distance to Angel Underground station



A 2 double bedroom apartment set on the third floor of this architecturally significant Grade II listed development located opposite Sadlers Wells Theatre and within a short distance to Angel Underground station.

This Grade II Berthold Lubetkin designed property is a fantastic opportunity to make it your own and accommodation comprises, a large bright reception room space, 2 double bedrooms, kitchen with storage and a family bathroom. The development benefits from secure entry and lift access.

Sadler House & the Spa Green estate are supremely well positioned for access to a plethora of amenities including Sadlers Wells Theatre, the gardens of Myddelton Square, the renowned eateries and bars of Exmouth Market, Upper Street and Camden Passage. The City & the West End are both within easy access. The nearest public transport links are Angel (Northern Line), Farringdon Station (London Underground Circle Line, Hammersmith & City Line and Metropolitan Line and National Rail services). Kings Cross/ St Pancras International is just 1 stop from Angel, with the Eurostar Terminus offering trains to mainland Europe.

Tenure: Leasehold 82 years 2 months
Service Charge: £3328
Ground Rent: £10
Local Authority: Islington
Council Tax Band: D

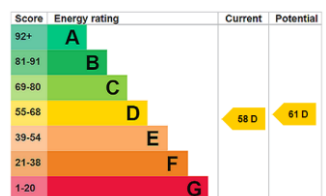

Chestertons Islington Sales

327-329 Upper Street
 Islington
 London
 N1 2XQ
 islington@chestertons.co.uk
 020 7359 9777
 chestertons.co.uk

Sadler House,
Spa Green Estate, EC1R



○ - Ceiling Height

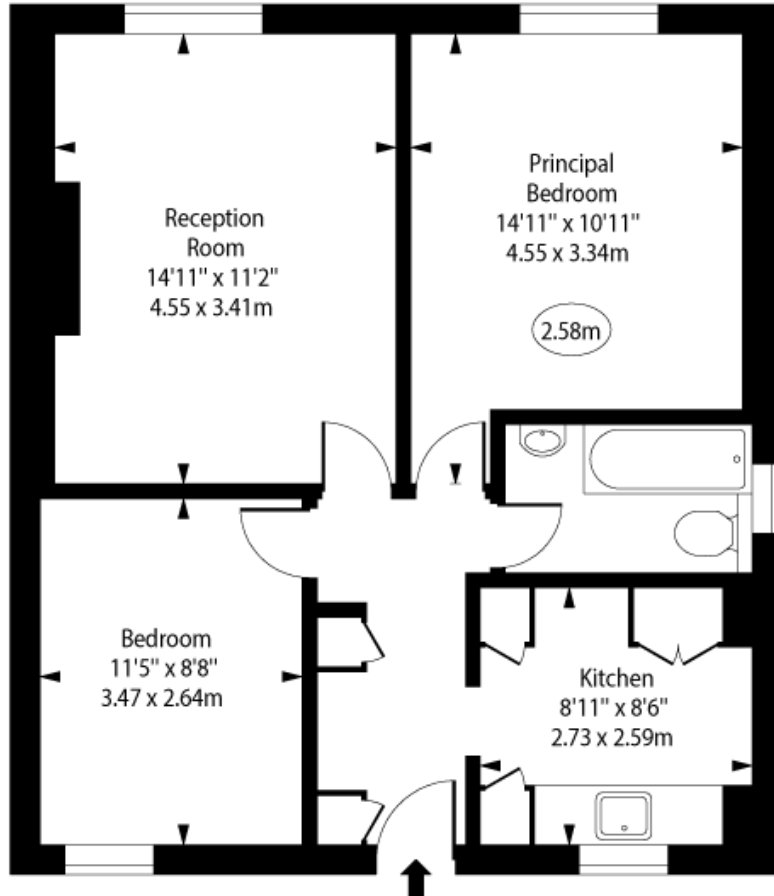

Third Floor

Approx Gross Internal Area 622 Sq Ft - 57.78 Sq M

Every attempt has been made to ensure the accuracy of the floor plan shown. However, all measurements, fixtures, fittings, and data shown are approximate interpretations and for illustrative purposes only. Measured according to the RICS. Not To Scale.

www.goldlens.co.uk
Ref. No. 030142.1WI

