



Middleton Road, E8

£400,000

A one double bedroom apartment on the ground floor of a purpose built apartment block on Middleton Road. This property measures in excess of 488 Sqft. Has a semi open plan kitchen and living room overlooking a shared garden. The bedroom has a large bespoke sash window overlooking a manicured front garden. There is good storage, a large centralised bathroom and this property is being offered chain free.

This property is ideally located under half a mile from London Fields which leads onto Broadway Market. The Windrush Line is less than half a mile away as well as Kingsland road a quarter of a mile away.

Features

- One double bedroom
- Sash Windows
- Lease of 188 Years
- Over 488 square feet
- Chain Free
- Shared Garden

Middleton Road,
London, E8

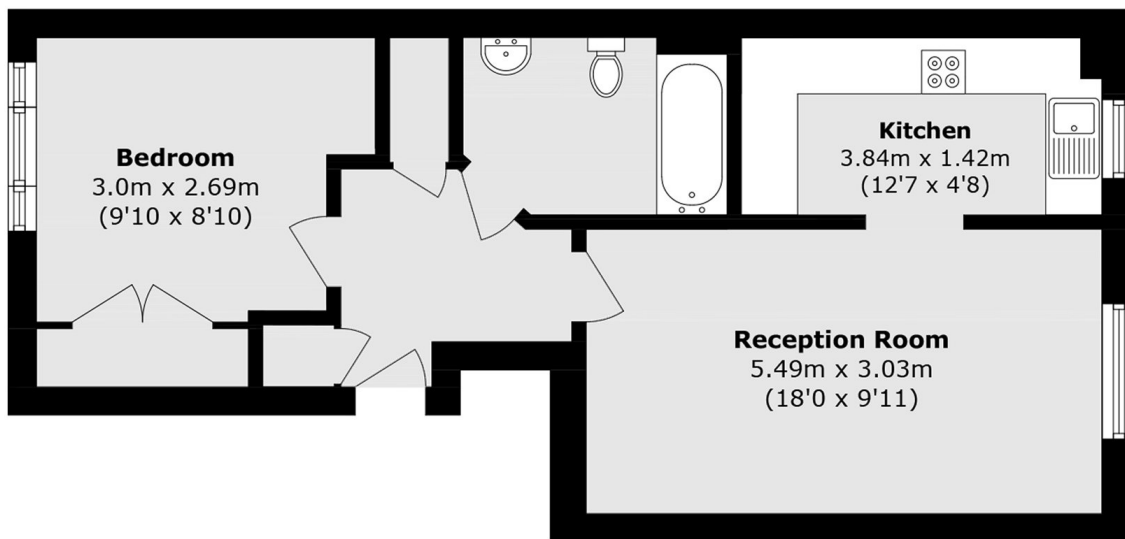

Total area (approx.): 48.9 sq. m (489.7 sq. ft)