

28 Bryn Derwen, Abergele, LL22 8DE

£259,950

2 1 1



This delightful bungalow is beautifully presented, 'ready to move into' and viewings are recommended to appreciate this. With neutral decor, uPVC double glazing and gas central heating throughout and offering a porch, hallway, lounge, conservatory, modern kitchen/diner, two double bedrooms and a shower room. There are easy to maintain gardens to the front and back, the rear being fully enclosed and extremely private. The much sought after location, within this popular residential estate, is within walking distance of Abergele town centre. Schools for all age groups, the leisure centre, woodland walks and the local golf club are all nearby. The A55 Expressway can be accessed at Abergele and the beach is also within two miles. There are regular bus services too, with trips to the nearby resorts of Colwyn Bay and Llandudno.

Key Features

- Detached bungalow
- Immaculate inside and out
- No forward chain
- Kitchen/diner
- Conservatory
- Two double bedrooms
- Single garage
- Freehold
- Council tax band - D
- EPC rating -TBC

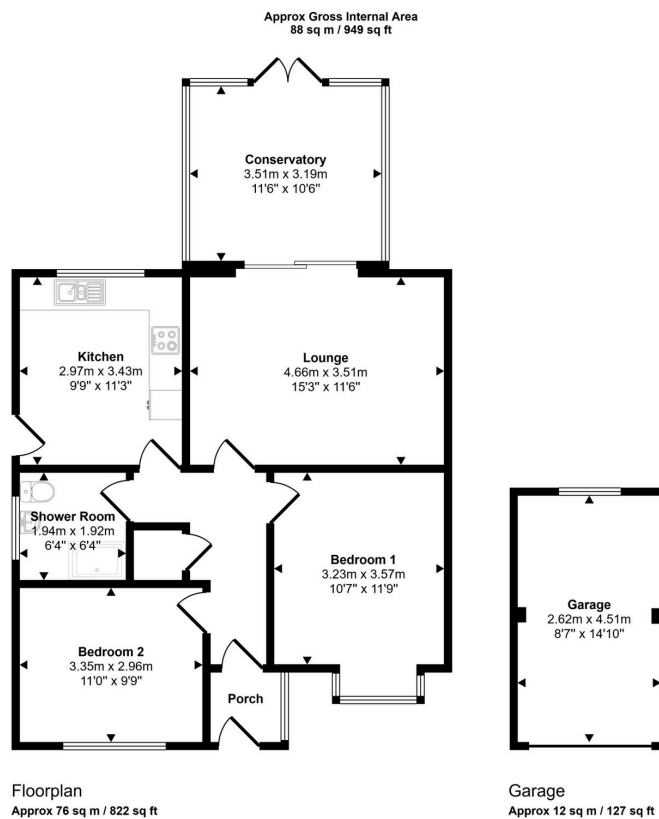

This floorplan is only for illustrative purposes and is not to scale. Measurements of rooms, doors, windows, and any items are approximate and no responsibility is taken for any error, omission or mis-statement. Icons of items such as bathroom suites are representations only and may not look like the real items. Made with Made Snappy 360.