

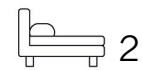

Living
made
better

Adriatic Apartments
Royal Victoria Dock, E16 1BU



Offers In Excess Of £520,000

Adriatic Apartments, Royal Victoria Dock, E16 1BU

Madison Brook

Property Summary

A striking two-bedroom penthouse set across two floors, featuring an expansive private terrace with panoramic views of Canary Wharf. This beautifully designed home offers a spacious open-plan kitchen, bright reception and dining area with floor-to-ceiling windows, principal suite with en suite bathroom, second double bedroom, cloakroom, and generous hallway. Adriatic Apartments provides 24-hour concierge, gated parking, and is perfectly located near Thames Barrier Park, Royal Docks, and excellent transport links including Royal Victoria DLR and the Elizabeth Line.

Floorplan

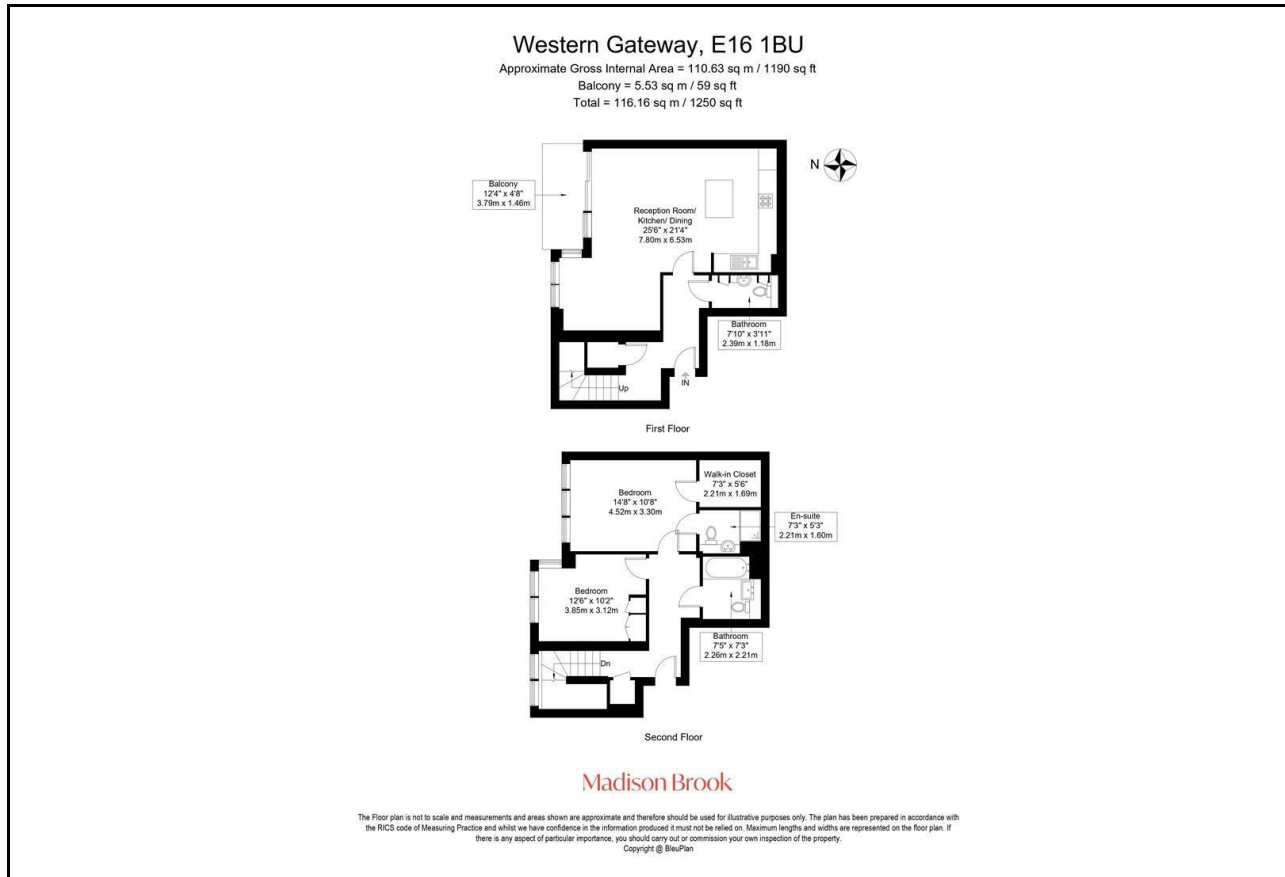

Area Map

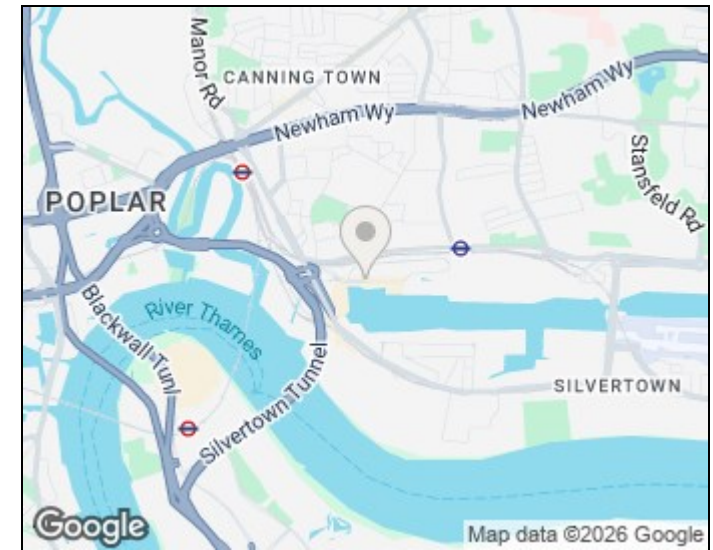

Energy Efficiency Graph

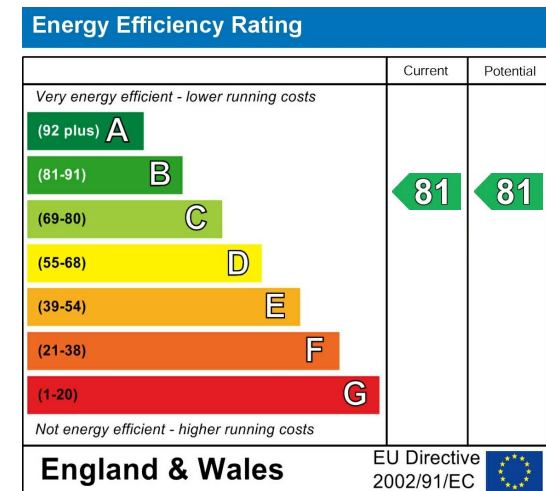

These particulars, whilst believed to be accurate are set out as a general outline only for guidance and do not constitute any part of an offer or contract. Intending purchasers should not rely on them as statements of representation of fact, but must satisfy themselves by inspection or otherwise as to their accuracy. No person in this firm's employment has the authority to make or give any representation or warranty in respect of the property.

Unit B 20 Western Gateway, Royal Victoria Dock, London, E16 1BS
 Tel: 020 3946 6000 Email: docklands@madisonbrook.com
<https://madisonbrook.com/>