



## Grange Park, W5

£370 pw (£1,600 pcm)

This immaculate one bedroom conversion flat features a spacious reception room, well-equipped kitchen and a modern shower room. Additional perks include a communal garden and inclusive heating and hot water.

The property is ideally located within walking distance to the stations (Ealing Broadway, Ealing Common and South Ealing) shops and parks( Ealing Common, Lammas and Walpole).

## First Floor

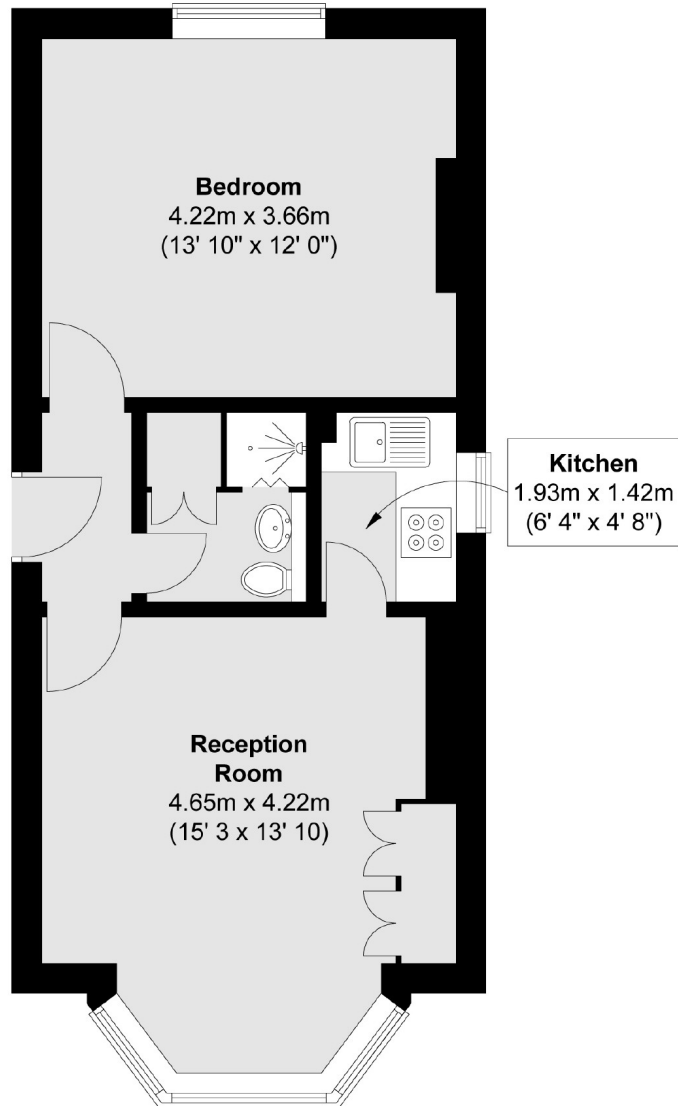

Total area (approx.) : 42.5 sq. m (457 sq. ft)

Robertson Smith & Kempson Ealing Lettings  
1 The Broadway,  
London, W5 2NT  
020 8840 7885  
ealinglettings@robertsonsmithandkempson.co.uk

Energy Rating: C. We aim to make our particulars both accurate and reliable. However they are not guaranteed; nor do they form part of an offer or contract. If you require clarification on any points then please contact us, especially if you're traveling some distance to view. Please note that appliances and heating systems have not been tested and therefore no warranties can be given as to their good working order.