



## Henry Macaulay Avenue, KT2

### £1,350,000

A stunning three bedroom, three bathroom riverside apartment positioned on the sixth floor of this landmark development, enjoying panoramic views over the River Thames and beyond. The apartment has been cleverly designed to maximise its exceptional outlook, with a spacious open plan living, dining and kitchen area forming the heart of the home. An array of river-facing windows floods the space with natural light and frames an ever-changing and impressive backdrop, creating a superb setting for both everyday living and entertaining.

Located in the heart of Kingston Riverside, with Kingston's vibrant town centre, the River Thames and excellent transport links to London Waterloo all on your doorstep, this apartment is the perfect blend of luxury, convenience, and unrivalled views.

### Features

- Incredible Panoramic Views
- Three Double Bedrooms
- Two Bathrooms
- Under Floor Heating
- Lift And Concierge Service
- Communal Roof Garden





## Henry Macaulay Avenue, KT2

From the moment you arrive, you are welcomed into the elegant entrance lobby, where the resident concierge provides a warm greeting. The elevator whisks you effortlessly to the ninth floor, setting the tone for the luxury that awaits.

Each of the three well appointed bedrooms offer impressive views, creating a sense of space, light, and connection with the picturesque surroundings. Two bedrooms benefit from an en suite bathroom, while the additional modern family bathroom serves the third bedroom.

As well as the well manicured gardens on the ground floor with direct access to the river, there is also a lovely rooftop garden for the residents to enjoy.





# Henry Macaulay Avenue, Kingston Upon Thames, KT2

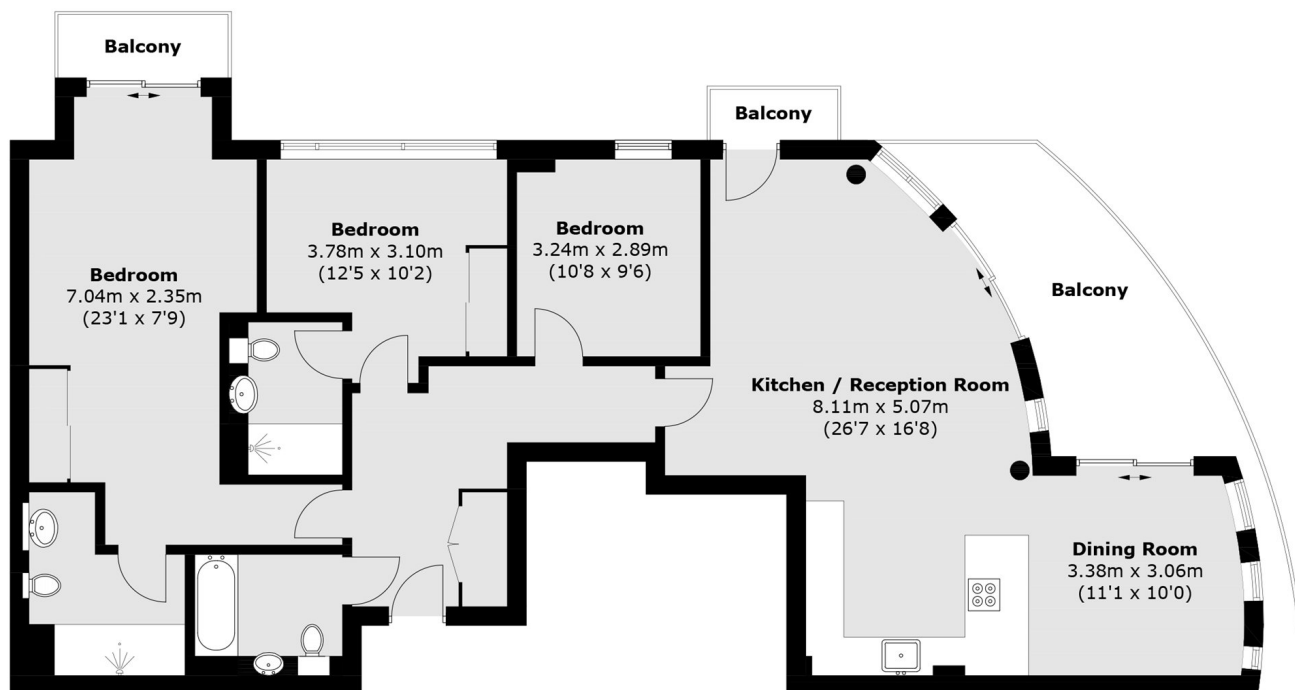

Total area (approx.): 118.5 sq. m (1,275.5 sq. ft)  
Balcony (approx.): 20.8 sq. m (223.9 sq. ft)