



JON KEYTE

exp<sup>®</sup> UK

@ [jon.keyte@exp.uk.com](mailto:jon.keyte@exp.uk.com)

🌐 [jonkeyte.exp.uk.com](http://jonkeyte.exp.uk.com)

☎ 07445 265 314

# Gillard Road, Brixham, TQ5 9EP

Offers Over £40,000

🛏️ 2 🍽️ 2 🚗 1



- Please Quote JK1243
- Situated in Popular Brixham
- Lovely Open Plan Living Accommodation
- Holiday Home that Sleeps 6
- Modern Fitted Kitchen with Built-In Appliances
- Spacious Composite Sun Deck
- Overlooking Wildlife Area
- Allocated Parking
- Close to St. Marys Bay & The South West Coast Path
- Excellent Onsite Facilities including Heated Indoor Swimming Pool, Bar/ Restaurant, Picnic Area & Childrens Playground



Please Quote JK1243 - Located in the sought-after Landscope Holiday Park, Brixham, this charming 2-bedroom caravan offers comfortable coastal living with a touch of nature. Featuring an open-plan layout, it includes a well-equipped kitchen, dining area, and comfortable lounge area perfect for relaxing or entertaining. The master double bedroom boasts an En-suite bathroom, while the second bedroom includes twin beds with a modern shower room adjacent. Step outside to a maintenance free composite sun deck overlooking a peaceful wildflower nature area—perfect for unwinding. With allocated parking to the front and close proximity to St. Mary’s Bay and the South West Coast Path, this is a perfect holiday retreat or investment.

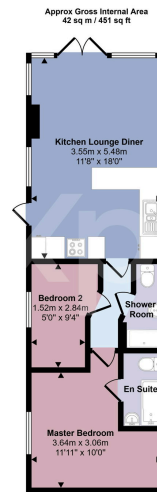

Floorplan

This floorplan is only for illustrative purposes and is not to scale. Measurements of rooms, doors, windows, and any items are approximate and no responsibility is taken for any error, omission or mis-statement. Icons of items such as bathroom suites are representations only and may not look like the real items. Made with Made Snappy 360.

