



33 Saxhorn Road, Lane End, Buckinghamshire. HP14 3JN
£390,000

33 Saxhorn Road

Lane End, High Wycombe

- Extended End Of Terrace Home
- Improved & Stylishly Presented Accommodation
- Kitchen/Breakfast Room & Lounge/Dining Room
- Three Bedrooms, Bathroom & Seperate W.C.
- Well Kept Front & Rear Gardens
- Offered With No Onward Chain

Situated in the village of Lane End approximately 5 miles from High Wycombe and 5 miles from Thameside Marlow. The village provides a good range of facilities, local school and buses connect Lane End with High Wycombe, from where there is a 25 minute rail service to London Marylebone as well as direct links to Oxford and Birmingham. Chiltern countryside literally surrounds Lane End, while in contrast, junctions 4 and 5 of the M40 are reached in about ten minutes.

Council Tax band: C

Tenure: Freehold

EPC Energy Efficiency Rating: C



33 Saxhorn Road

Lane End, High Wycombe

A beautifully presented extended three-bedroom end-of-terrace home offering spacious accommodation throughout and offered with no onward chain.

Situated in a quiet cul-de-sac within the popular village of Lane End, this spacious and thoughtfully extended end-of-terrace home offers stylishly presented accommodation and convenient access to local amenities and open countryside. The accommodation comprises an entrance hall, a contemporary cloakroom/W.C., a generous kitchen/breakfast room, and a bright dual-aspect living/dining room with double doors opening onto the rear garden. To the first floor are three well-proportioned bedrooms, a family bathroom, and a separate W.C. Further benefits include gas-fired central heating, double glazing throughout, and residents' parking to the front. The front garden is mainly laid to lawn, while the enclosed rear garden is beautifully maintained and features a well-kept lawn, three separate patio areas ideal for outdoor entertaining, and timber fencing providing privacy and security.







Approx Gross Internal Area
86 sq m / 928 sq ft

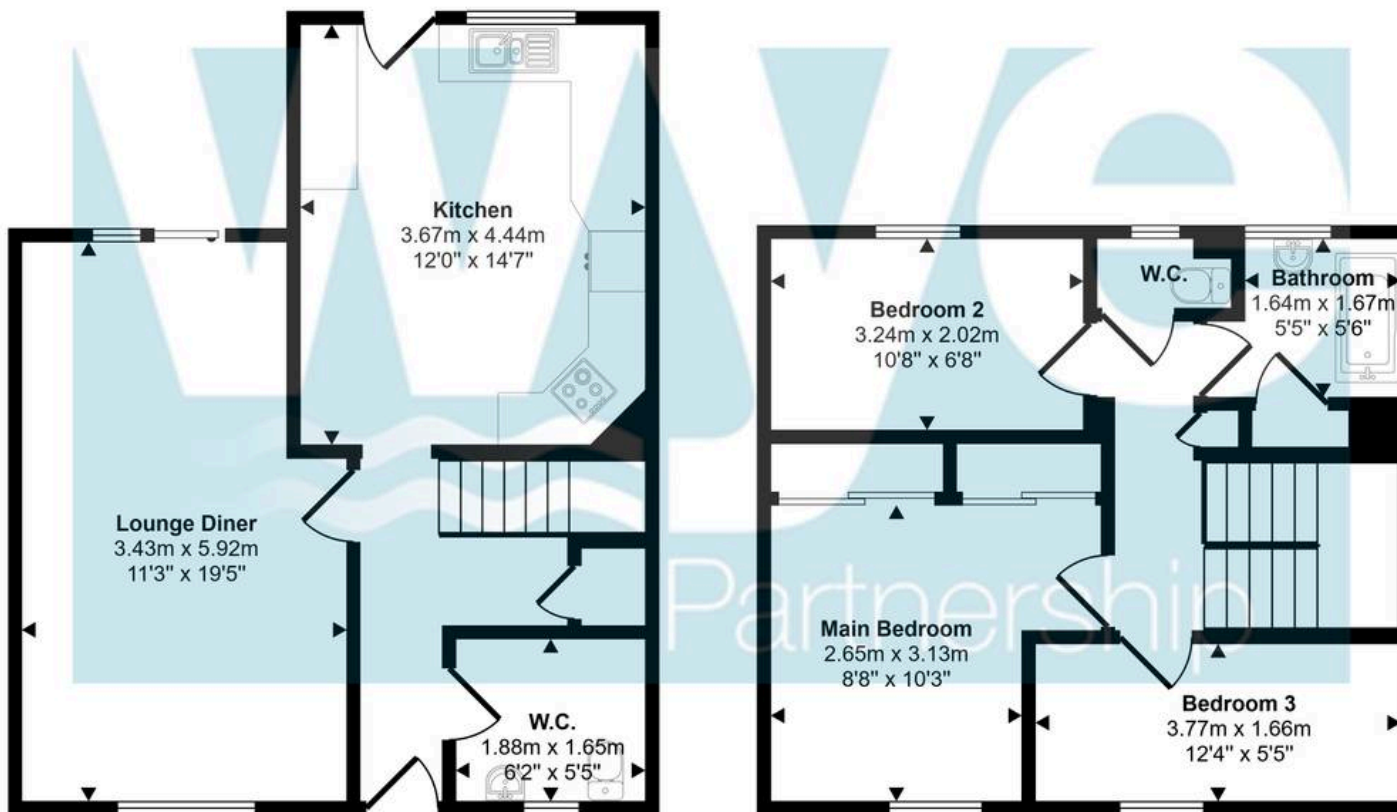

Ground Floor
Approx 47 sq m / 504 sq ft

First Floor
Approx 39 sq m / 423 sq ft

This floorplan is only for illustrative purposes and is not to scale. Measurements of rooms, doors, windows, and any items are approximate and no responsibility is taken for any error, omission or mis-statement. Icons of items such as bathroom suites are representations only and may not look like the real items. Made with Made Snappy 360.

The Wye Partnership Stokenchurch

Kingston House, Oxford Road, Stokenchurch - HP14 3TA

01494 509377 • stokenchurch@wyeres.co.uk • www.wyeres.co.uk/

By law, each person involved in the sale/purchase of a property must have their identification verified to comply with Anti Money Laundering Regulations. These checks are outsourced and a charge of £36 (inc of VAT) is charged for each individual and paid directly to our supplier.

