

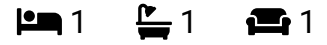

HOMES BY VICTORIA
ESTATE AGENCY

105 High Trees Close, Redditch, B98 7XL

Offers Over £130,000



Welcome to High Trees Close, an exceptional one-bedroom residence nestled within the highly sought-after area of Oakenshaw. This beautifully presented home offers an impressive sense of space and natural light throughout, making it an ideal choice for first-time buyers, professionals, or those seeking a stylish retreat.

[homesbyvictoria.co.uk](https://www.homesbyvictoria.co.uk)

victoria@homesbyvictoria | 07833 136521

FOR M HOMES MIDLANDS LIMITED trading as Homes By Victoria Company Number: 13688840 VAT no: 470190115



HOMES BY VICTORIA
ESTATE AGENCY



Key Features

- An exceptional one-bedroom residence
- Tastefully decorated throughout
- Kitchen and pantry
- Spacious composite decked balcony
- Communal parking
- Highly sought-after area of Oakenshaw
- Generous lounge
- Master bedroom with built in wardrobe
- Double glazing and gas central heating
- Council Tax Band A

Approx Gross Internal Area
47 sq m / 503 sq ft

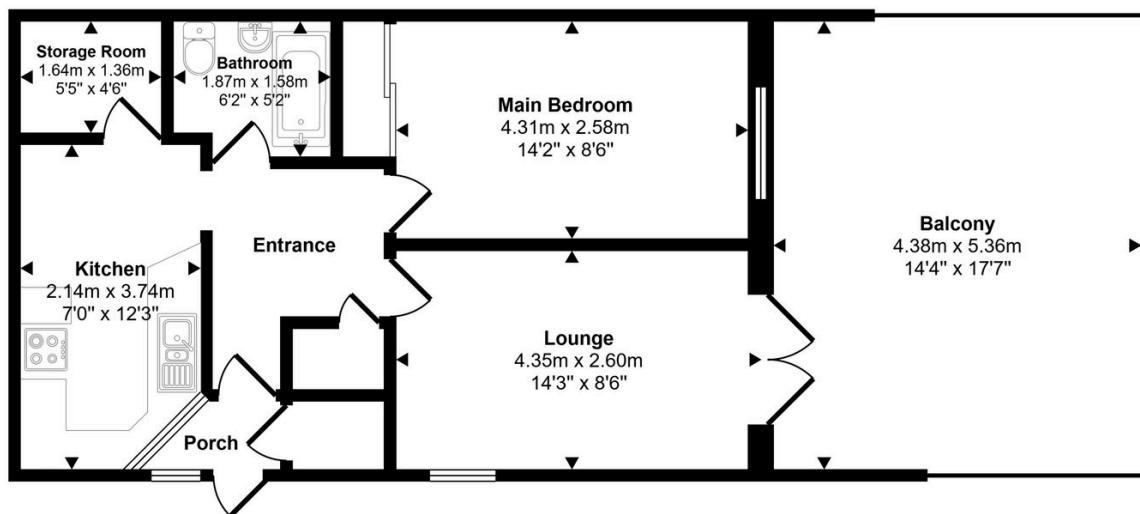

Floorplan

This floorplan is only for illustrative purposes and is not to scale. Measurements of rooms, doors, windows, and any items are approximate and no responsibility is taken for any error, omission or mis-statement. Icons of items such as bathroom suites are representations only and may not look like the real items. Made with Made Snappy 360.