



LITTLETON STREET, SW18

£1,250,000

- Freehold house
- Three bedrooms
- Private garden
- No onward chain
- Desirable location
- Energy rating: D







## ABOUT THE HOME

A truly wonderful three-bedroom Victorian home, offering exceptional scope to extend and further enhance, located in a prime residential setting.

This charming mid-terrace property is being offered to the market with no onward chain and comprises an inviting entrance hall, bright front reception room with bay window and a spacious second reception overlooking the side return. The modern kitchen is open plan to the dining area, creating an ideal space for entertaining with doors leading out to a large private garden. On the first floor you'll find a contemporary family bathroom and three well-proportioned bedrooms, including a principal bedroom with ample built-in storage. High ceilings and abundant natural light enhance every room throughout the home.

Littleton Street is a quiet residential road just moments from Earlsfield High Street, with its independent cafés, excellent restaurants, and vibrant pubs. Earlsfield station is only 0.4 miles away, providing fast and reliable services into central London.





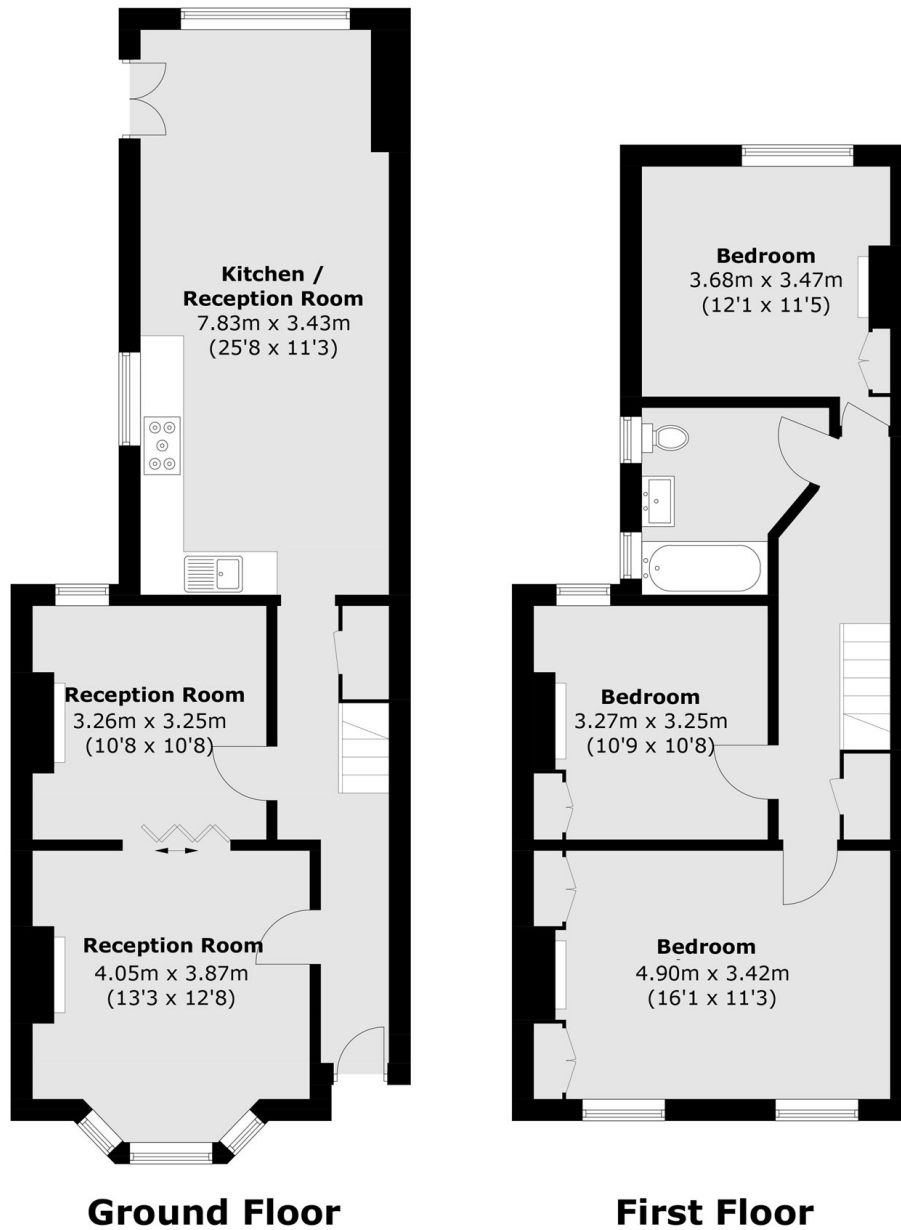

Total area (approx.): 117.3 sq. m (1262.5 sq. ft)

#### JACKSONS EARLSFIELD

372-374 Garratt Lane,  
Earlsfield, London, SW18 4ES  
Sales: 020 8971 7979  
Lettings: 020 8971 7070

Energy Rating: D We aim to make our particulars both accurate and reliable. However they are not guaranteed; nor do they form part of an offer or contract. If you require clarification on any points then please contact us, especially if you're traveling some distance to view. Please note that appliances and heating systems have not been tested and therefore no warranties can be given as to their good working order.