

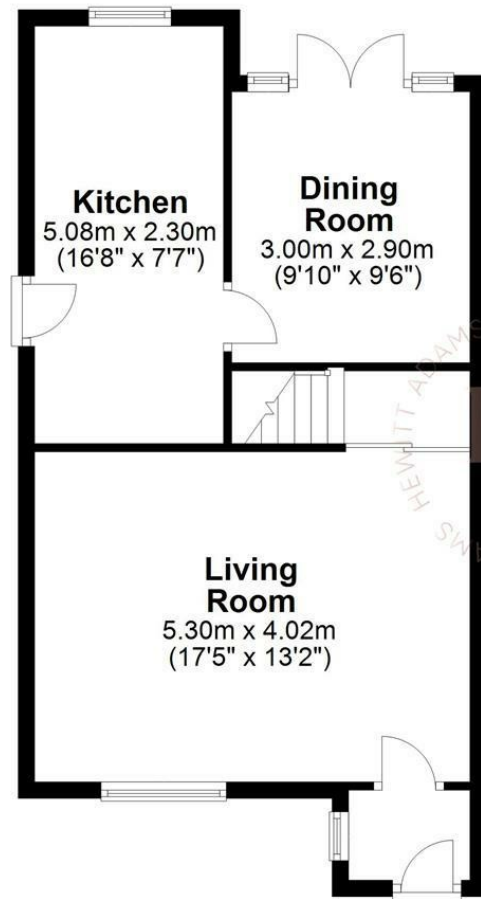

Ground Floor

Approx. 47.2 sq. metres (508.5 sq. feet)



First Floor

Approx. 44.4 sq. metres (478.3 sq. feet)

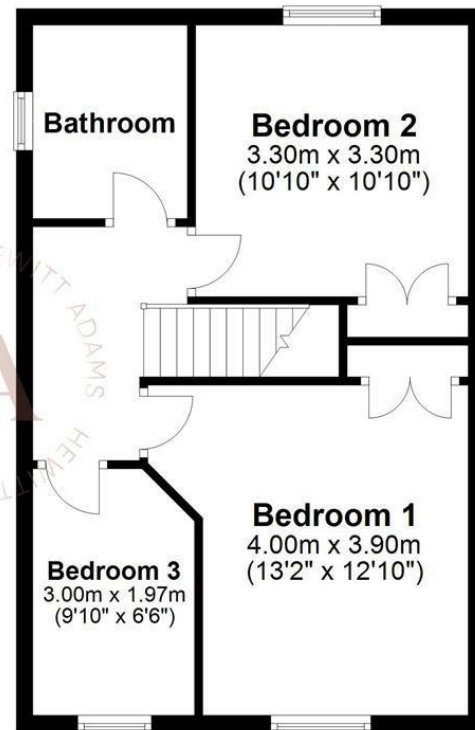

Total area: approx. 91.7 sq. metres (986.8 sq. feet)
For illustration purposes only - not to scale

Rydal Close, Pensby, Wirral CH61 5XR
Offers Over £249,950

 3 Bedroom  2 Reception  1 Bathroom 

****Three Bedroom Semi - Well Maintained - No Onward Chain - South Facing Garden - Ideal First Time Buy****

Hewitt Adams is pleased to offer to the market this THREE BEDROOM semi on the ever popular Rydal Close in Pensby. Located at the head of the cul-de-sac the property has a SOUTH FACING garden with a sunny aspect. Number 17 Rydal Close has been a cherished family home for over 35 years, with the owners sad to leave after many happy years - but excited at the prospect of a new family making their own memories inside its walls!

Sold with NO ONWARD CHAIN the property comes to the market in well maintained condition and a new buyer could move in very comfortably and then just put their own stamp on the property.

In brief the accommodation affords; entrance porch, lounge, dining room, kitchen. Upstairs there are three bedrooms and a bathroom.

With a good sized driveway, detached garage and a SOUTH FACING garden with patio and lawn.

Call Hewitt Adams on 0151 342 8200 to view.

Front Entrance

Into;

Porch

Door into;

Lounge

Double glazed window, radiator, power points, log-burner, wooden flooring

Dining Room

9'10" x 8'10" (3.00 x 2.7)

Double glazed door to garden, radiator, power points, door into kitchen, wooden flooring

Kitchen

7'6" x 16'7" (2.3 x 5.08)

Wall and base units, inset sink, cooker and white-goods, double glazed window, side door, tiled floor

UPSTAIRS

Bedroom One

13'1" x 13'1" (4.00 x 3.99)

Fitted wardrobes, double glazed window, radiator, power points

Bedroom Two

10'9" x 10'9" (3.3 x 3.3)

Integral wardrobes, double glazed window, radiator, power points

Bedroom Three

9'10" x 6'5" (3.00 x 1.97)

Double glazed window, radiator, power points

Bathroom

Comprising shower, low level W.C, wash hand basin, double glazed window, tiled floor

Loft

Fully floored with electric lighting

EXTERNALLY

Front Aspect - Driveway, Garage

Rear Aspect - SOUTH FACING garden with patio and lawn, pond, greenhouse.

