



Woodley Crescent, NW2

£380,000

Situated on the second floor of a recently built development, this one bedroom flat boasts an open-plan reception with family kitchen leading on to a private balcony, a large twin bathroom and ample storage cupboards. The property benefits from a communal garden.

Located on Woodley Crescent, situated a short distance from Cricklewood Station (Thameslink) and David Lloyds Gym as well as numerous road connections including the A406, A41 and the M1.

Features

- One Bedroom
- Open Plan Reception
- Family Kitchen
- Twin Bathroom
- Private Balcony
- Excellent Condition

Woodley Crescent, London, NW2

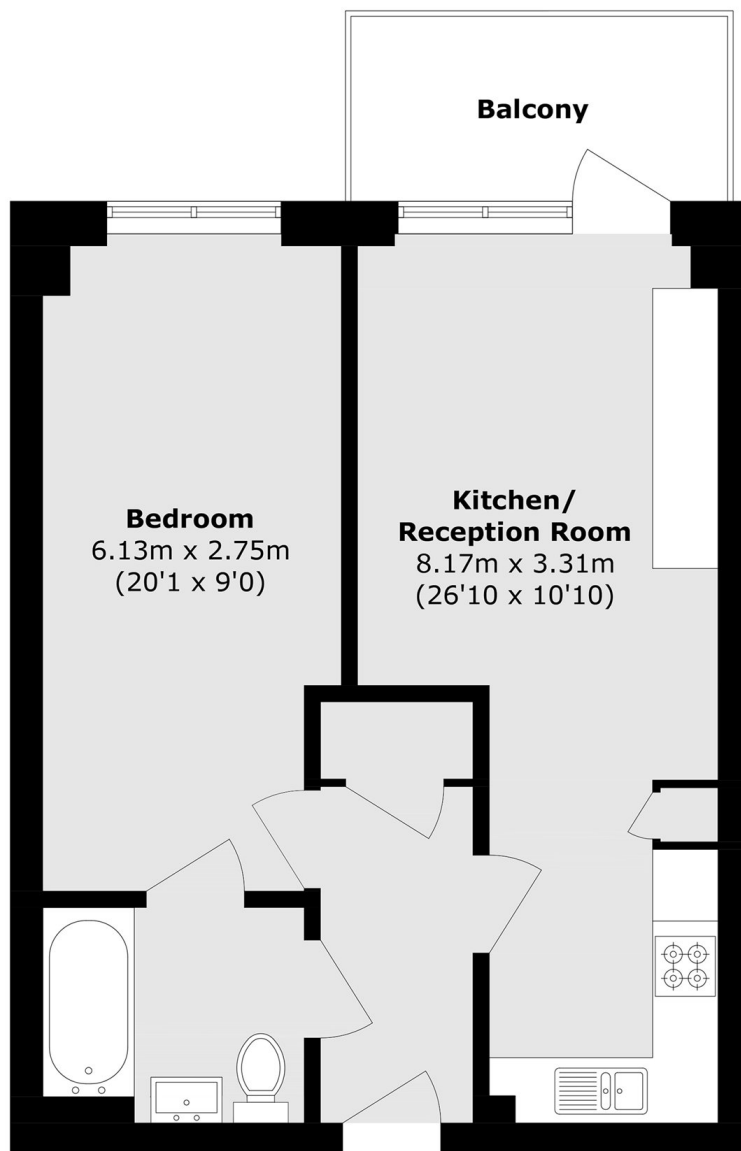

Total area (approx.): 50.6 sq. m (544.6 sq. ft)

Balcony area (approx.): 6.2 sq. m (66.7 sq. ft)