

**FOR SALE**



**Binsey Lane, Oxford**

Offers Over £575,000

  
**MARTIN&CO**

# Binsey Lane, Oxford

## Key Notes:

- Three Bedrooms
- Bay Fronted Reception Room
- Potential to Extend STPP
- Permit Parking
- Short Stroll to Centre of Oxford
- Enclosed Rear Garden with Rear Access
- Walking Distance to Oxford Train Station
- Council Tax Band: D
- No Onward Chain
- Tenure: Freehold



Score	Energy rating	Current	Potential
92+	A		
81-91	B		84 B
69-80	C		
55-68	D	60 D	
39-54	E		
21-38	F		
1-20	G		

Martin & Co are delighted to bring to market this charming three-bedroom mid-terraced home, ideally located on the sought-after Binsey Lane in Oxford.

Offered with vacant possession and no onward chain, this property combines character and convenience, making it an appealing choice for both families and investors.

Stepping inside, the ground floor unfolds with a light-filled bay-fronted reception room, a welcoming dining room and a spacious kitchen that serves as the heart of the home. The first floor provides three well-proportioned bedrooms and a shower room, creating comfortable and versatile living space.

Outside, the property enjoys an enclosed rear garden with the benefit of rear access, while permit parking adds extra convenience.

Perfectly positioned within walking distance of Oxford Train Station and the city centre, the house is ideally placed for those seeking easy access to local amenities, excellent transport links and the vibrant life of the city.

In addition to being a family home, the property also holds an HMO licence for four sharers, presenting a ready-made investment opportunity in one of Oxford's most desirable areas.

*Please note: some images within this brochure are computer-generated and are used for marketing purposes only.*



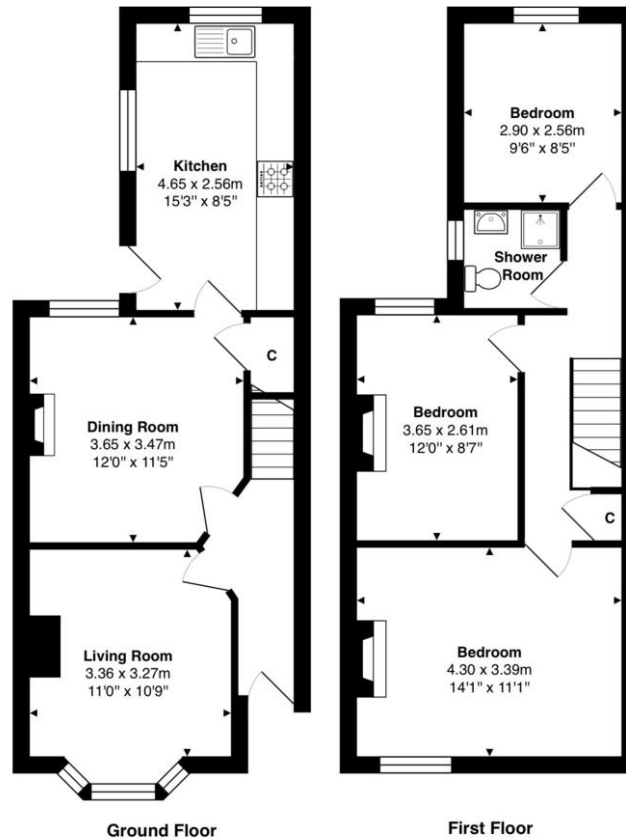

#### Approximate Gross Internal Area

85.3 m<sup>2</sup> ... 919 ft<sup>2</sup>

Whilst every attempt has been made to ensure the accuracy of the floor plan contained here, measurements of doors, windows, rooms, and any other items are approximate. No responsibility is taken for any error, omission, or mis-statement. This plan is for illustrative purpose only and should be used as such.  
 Drawn by E8 Property Services. [www.e8ps.co.uk](http://www.e8ps.co.uk)



## Martin & Co Oxford

31 Woodins Way • Paradise Street • • OX1 1HD  
 T: 01865 812110 • E: [oxford@martinco.com](mailto:oxford@martinco.com)

# 01865 812110

<http://www.martinco.com>



**Accuracy:** References to the Tenure of a Property are based on information supplied by the Seller. The Agent has not had sight of the title documents. A Buyer is advised to obtain verification from their Solicitor. Items shown in photographs including but not limited to carpets, fixtures and fittings are not included unless specifically mentioned within the sales particulars. They may however be available by separate negotiation. Buyers must check the availability of any property and make an appointment to view before embarking on any journey to see a property. No person in the employment of the agent has any authority to make any representation about the property, and accordingly any information given is entirely without responsibility on the part of the agents, sellers(s) or lessors(s). Any property particulars are not an offer or contract, nor form part of one. **Sonic / laser Tape:** Measurements taken using a sonic / laser tape measure may be subject to a small margin of error. **All Measurements:** All Measurements are Approximate. **Services Not tested:** The Agent has not tested any apparatus, equipment, fixtures and fittings or services and so cannot verify that they are in working order or fit for the purpose. A Buyer is advised to obtain verification from their Solicitor or Surveyor.