



21, Shrubbery Road
Drakes Broughton
Pershore
WR10 2AX

£1,100 PCM



CHRISTIAN
LEWIS
— PROPERTY —



21 Shrubby Road, Drakes Broughton, Pershore, WR10 2AX

£1,100 PCM

LET OFF MARKET

Important Application & Tenancy Costs Information

A refundable holding deposit equivalent of one weeks rent will be required upon provisional acceptance of application to secure the property until all checks have been completed.

Following successful completion of all referencing checks the one weeks deposit will be transferred to your tenancy account and used towards the first months rent, unless otherwise agreed.

The holding deposit is non refundable in the following situations and instead used to contribute towards incurred costs;

- You and/or any of your co-applicants decide to withdraw from the process after this application is submitted to us.
- No legal authority to rent (Failing Right to Rent Checks)
- False, inaccurate, missing, or misleading information is supplied by you
- Failure by the applicants, referees and/or guarantors to complete the process
- Failure to sign a Tenancy agreement within 14 days from the date of application unless otherwise previously agreed. Should extension be permitted, a maximum of 21 days from payment of holding deposit is required

A full deposit equating to five weeks rent is payable upon signature of agreement and before move in.

Other Permitted Payments to Us During Tenancy

- Variation to Tenancy At Tenant Request - £50
- Cost of Replacement Keys - Cost of replacement
- Early Termination of Tenancy - Landlords reasonable costs
- Refundable Holding Deposit - equal to 1 weeks rent
- Full Deposit - rent under £50,000 per year equal to 5 weeks rent
- Full Deposit - rent over £50,000 per year equal to 6 weeks rent
- Company Let (Non Housing Act Tenancy) - £500
- Unpaid Rent (chargeable after 14 days of due date) - 3% over the bank of England base rate

Other Permitted Payments to Providers During Tenancy

- Utilities (gas, electricity, water, oil)
- Council Tax
- Internet & Phone Subscriptions
- TV License (Where applicable)

About Us

Christian Lewis are members of The Property Ombudsman (TPO) which is a redress scheme, and our client money is protected via a 3rd Party. More information can be obtained by visiting our website, or calling the office.



Floor Plans

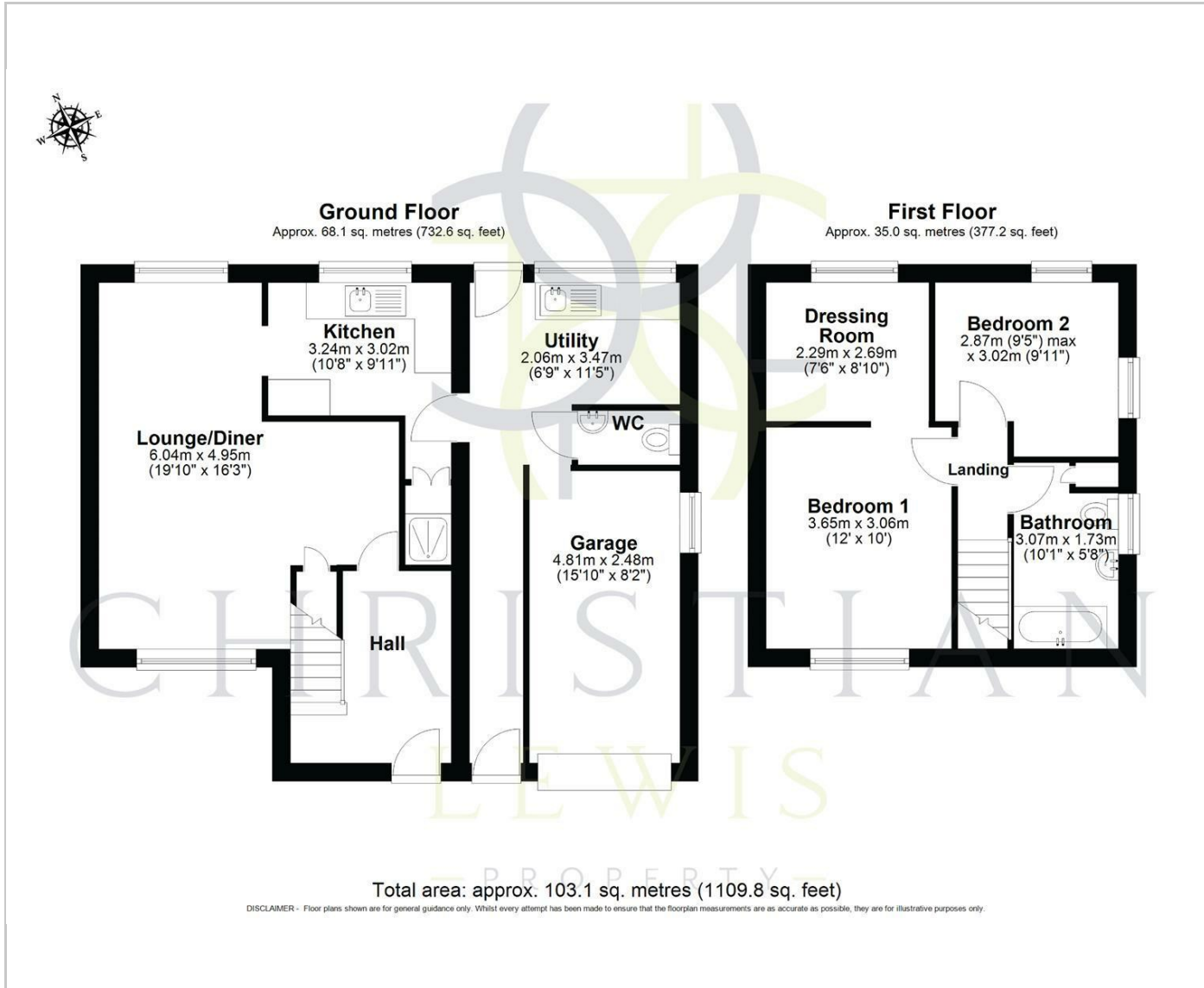

Area Map

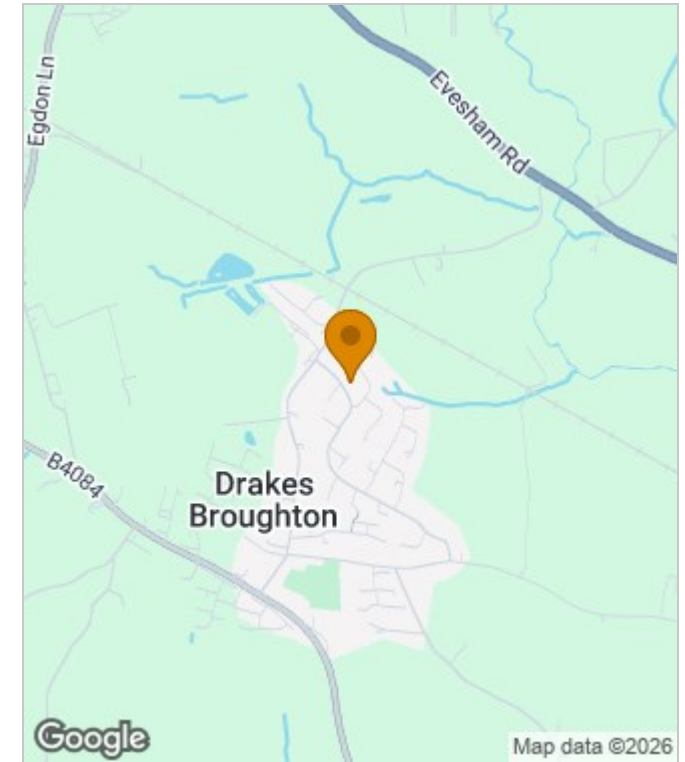

Energy Performance Graph

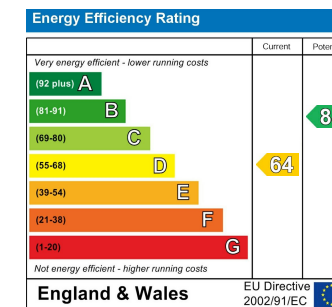

These particulars, whilst believed to be accurate are set out as a general outline only for guidance and do not constitute any part of an offer or contract. Intending purchasers should not rely on them as statements of representation of fact, but must satisfy themselves by inspection or otherwise as to their accuracy. No person in this firm's employment has the authority to make or give any representation or warranty in respect of the property.