



**121 Chamberlain Crescent, Shirley**  
Solihull

**£425,000**



## 121 Chamberlain Crescent

Shirley, Solihull

Refurbished four-bed home in central Shirley with modern kitchen, two reception rooms, study, utility, en-suite, and family bathroom. Close to schools, shops, and transport links.

Council Tax band: D

Tenure: Freehold

EPC Energy Efficiency Rating: C

EPC Environmental Impact Rating:

- Four well-proportioned bedrooms
- En-suite to main bedroom
- Spacious lounge diner
- Additional reception room
- Separate study/home office
- Modern fitted kitchen with high-quality finish
- Utility room and downstairs WC
- Stylish family bathroom
- Recently refurbished throughout
- Sought-after Shirley location close to amenities and transport links





Approx Gross Internal Area  
121 sq m / 1297 sq ft



Ground Floor  
Approx 69 sq m / 744 sq ft

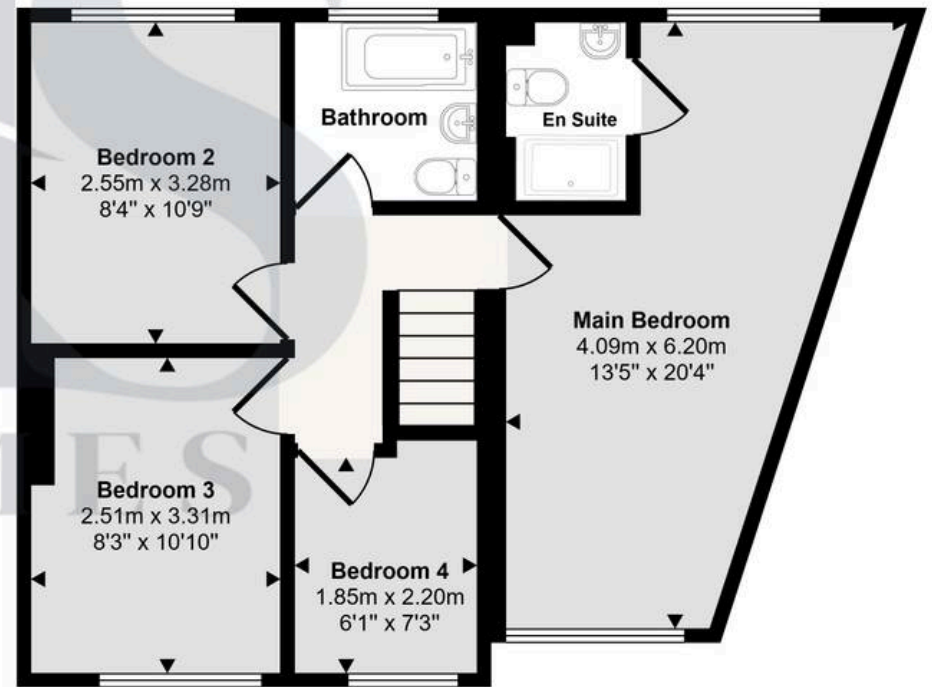

First Floor  
Approx 51 sq m / 553 sq ft