



Flat 1 355 London Road, High Wycombe, Buckinghamshire, HP11 1EJ

Asking Price | £1,150

## Property Description

A modern one bedroom apartment located to the east side of High Wycombe within easy access to local amenities. The property comprises; private entrance, stairs leading to double bedroom with built in storage, open plan living/kitchen space with a range of appliances and breakfast bar and new bathroom. The property further benefits from private garden to the front, electric heating and off-street parking for one car. Available from the end of August on a furnished basis.

COUNCIL TAX B

EPC RATING E

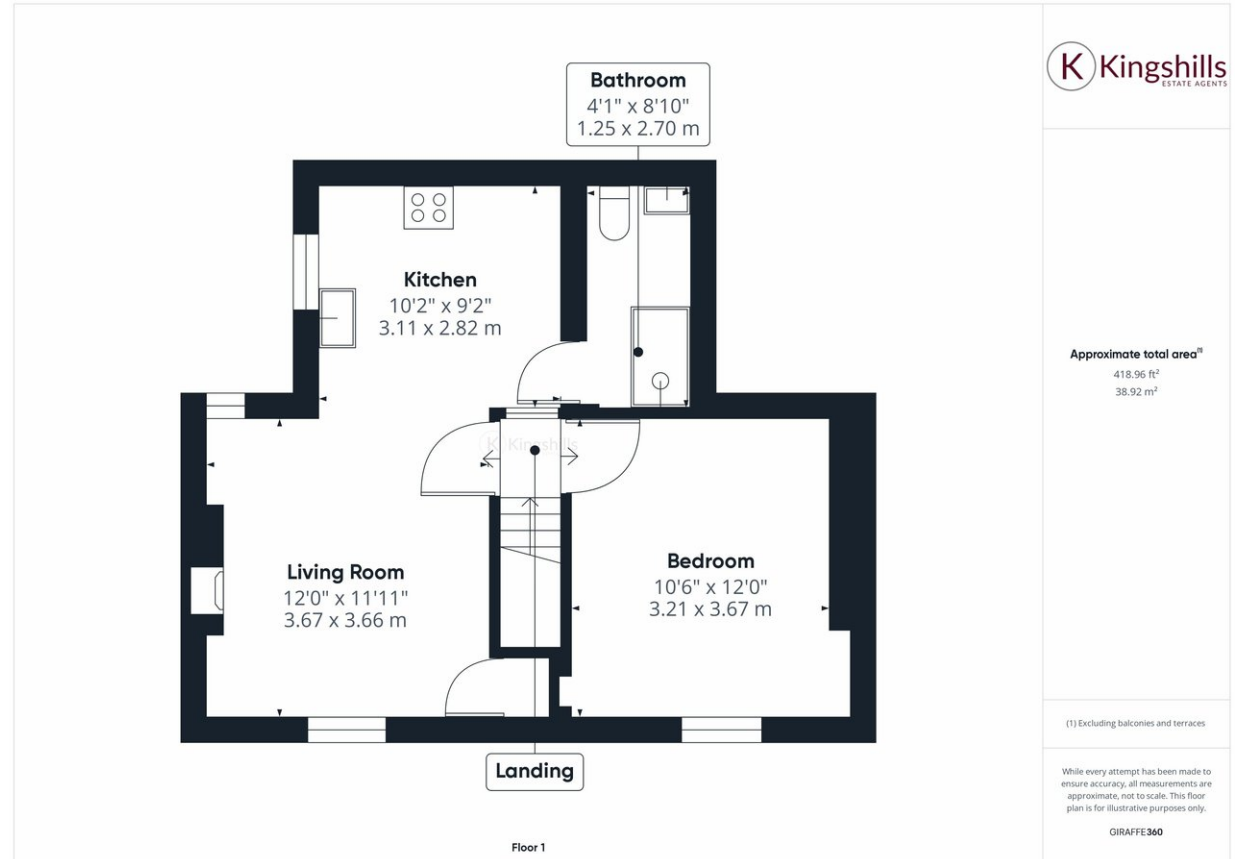

Kingshills Estate Agents  
C1C Comet Studios  
Amersham  
Buckinghamshire  
HP7 0PX

01494 939868  
hello@kingshills.co.uk  
kingshills.co.uk

Agents Note: Whilst every care has been taken to prepare these particulars, they are for guidance purposes only. All measurements are for general guidance purposes only and whilst every care has been taken to ensure accuracy, they should not be relied upon and potential buyers/tenants are advised to recheck the measurements