



15 Roslyn Road, Hathersage, Hope Valley, Derbyshire, S32 1BY

Saxton Mee

# 15 Roslyn Road Hathersage

Offers Over

## £725,000

A Beautiful Edwardian Family Home Nestled In The Stunning Hope Valley.

A substantial five bedroom Edwardian residence with attractive easily managed, enclosed rear garden and a garage/workshop. Occupying a peaceful picturesque setting with views across the impressive Peak District countryside. Within easy reach of the excellent range of local shops, cafes, restaurants and local Primary school alongside the wealth of outdoor pursuits beautiful Derbyshire has to offer. Within easy commutability of major commercial centres and local rail links.

Beautifully presented throughout, retaining many original features that have been skilfully restored by the present owners, including sash windows and impressive fireplaces.

With accommodation set over four floors comprising: entrance hallway, a bay windowed sitting room with a feature fireplace and original decorative tiles, dining room with a stove and a fitted kitchen. Cellarage split into two sections with a utility area. At first floor: landing, a double bedroom with a decorative fireplace, a family bathroom and a double bedroom with a W/C. At second floor: three bedrooms and a W/C.

Exterior: an easily managed front garden, a shared driveway leads to the garage/workshop, an enclosed courtyard garden to the rear.

- Fabulous Far Reaching Views
- Original Period Features
- Flexible Family Living Space
- Centrally Postioned Close To Excellent Local Facilities
- Highly Regarded School Catchment
- Close To The Historic Outdoor Pool & A Wealth Of Outdoor Pursuits
- Garage/Workshop
- No upward chain
- EPC: E
- Viewings: Hathersage Office





## 15 Roslyn Road

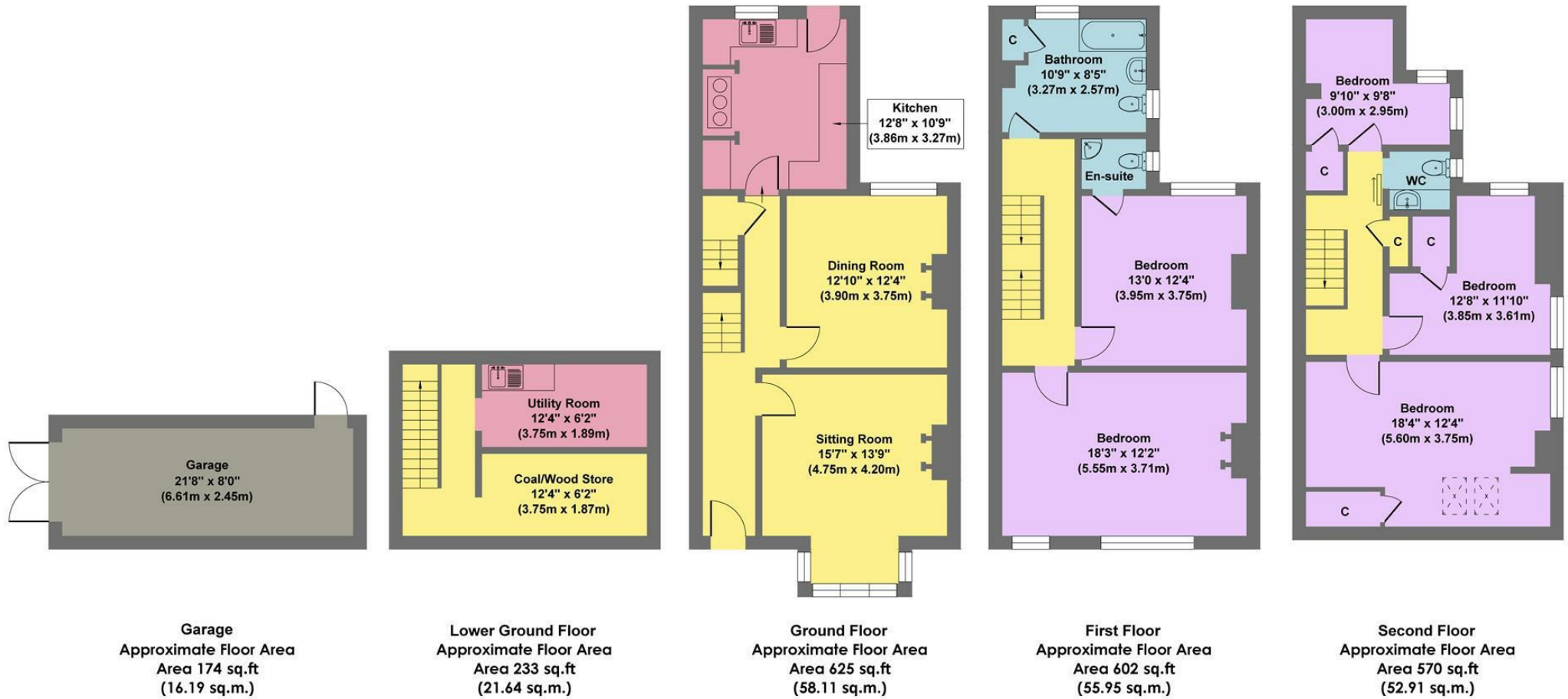

**Approx. Gross Internal Floor Area 2204 sq.ft / 204.80 sq.m**

Illustration for identification purposes only, measurements are approximate, not to scale

While we endeavour to make our sales particulars fair, accurate and reliable, they are only a general guide to the property and, accordingly, if there is any point, which is of particular importance to you, please contact the relevant office. The Agents have not tested any apparatus, equipment, fittings or services and so cannot verify they are in working order. The buyer is advised to obtain verification. Please note all the measurement details are approximate and should not be relied upon as exact. All plans, floor plans and maps are for guidance purposes only and are not to scale. Under no circumstances should they be relied upon as exact or for use in planning carpets and other such fixtures, fittings or furnishings. YOUR HOME IS AT RISK IF YOU DO NOT KEEP UP REPAYMENTS ON A MORTGAGE OR OTHER LOAN SECURED ON IT. 'A Life Assurance policy may be requested.' 'Written Quotations of credit terms available on request.'

Banner Cross  
T: 0114 268 3241  
E: [bannercross@saxtonmee.co.uk](mailto:bannercross@saxtonmee.co.uk)  
[www.saxtonmee.co.uk](http://www.saxtonmee.co.uk)

Hathersage  
T: 01433 650009  
E: [hathersage@saxtonmee.co.uk](mailto:hathersage@saxtonmee.co.uk)

Bakewell  
T: 01629 815307  
E: [bakewell@saxtonmee.co.uk](mailto:bakewell@saxtonmee.co.uk)

Matlock  
T: 01629 828250  
E: [matlock@saxtonmee.co.uk](mailto:matlock@saxtonmee.co.uk)

