



**NEW ZEALAND AVENUE WALTON-ON-THAMES**  
**£1,150 PER MONTH** AVAILABLE 31/03/2026

**Hamptons**  
THE HOME EXPERTS



# { THE PARTICULARS

New Zealand Avenue  
Walton-on-Thames KT12

£1,150 Per Month  
Unfurnished

 1 Bedroom  
 1 Bathroom  
 1 Reception

## Features

- Newly refurbished, - One Bedroom, -  
Town Centre Location, - Modern Finish, -  
Council Tax Band B

## Council Tax

Council Tax Band B

Hamptons  
26 High Street  
Weybridge, KT13 8AB  
01932639001  
WeybridgeLettings@hamptons.co.uk  
www.hamptons.co.uk

# { ONE BEDROOM APARTMENT IN THIS REGENCY STYLE BUILDING, EPC C

## The Property

This recently refurbished regency style building accommodates a range of apartments finished to a superb specification. Here we have available a one bedroom apartment with open plan living and kitchen areas, one double bedroom with built wardrobe and shower room.

## Location

Situated in the town centre of Walton-On-Thames, this spacious one bedroom apartment is ideally located for all of the towns' restaurants, bars, cafes and shopping centre. Walton-On-Thames train station is just one mile away which services London Waterloo frequently in under 25 minutes. The A3 and M25 are also easily accessed by a short drive.

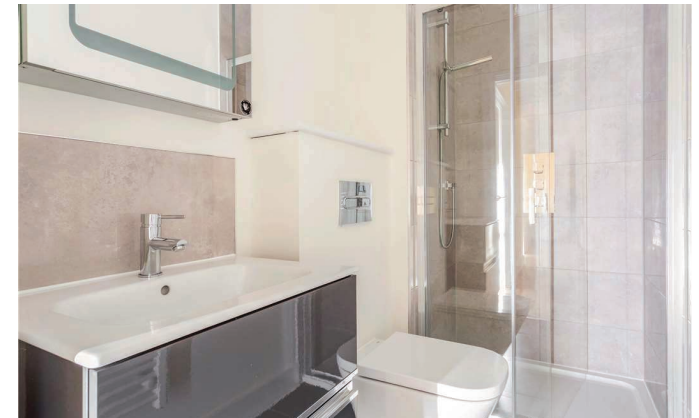

# New Zealand Avenue, Walton-on-Thames

Approximate Gross Internal Area = 33.9 sq m / 365 sq ft

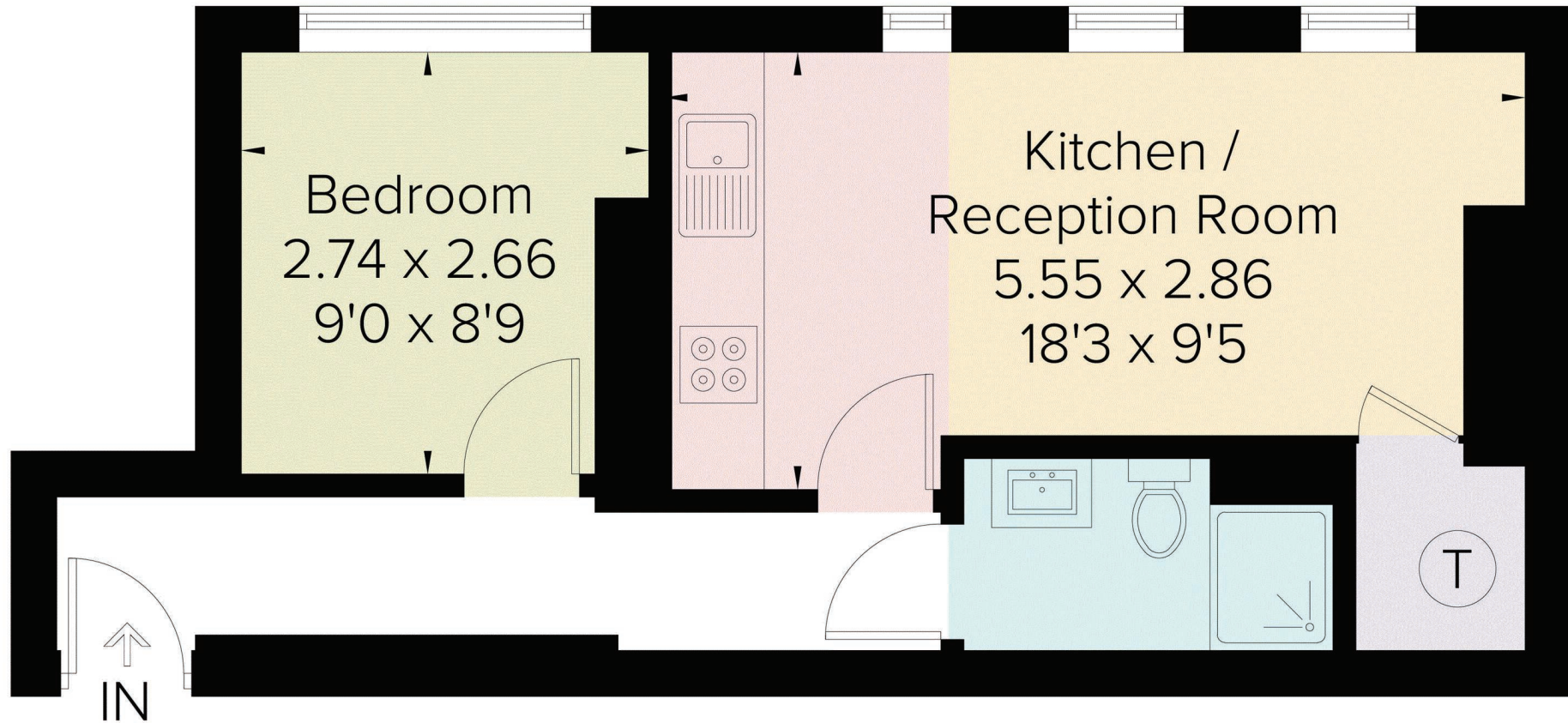

## Second Floor

FLOORPLANZ © 2018 0203 9056099 Ref: 223682

This plan is for layout guidance only. Drawn in accordance with RICS guidelines. Not drawn to scale unless stated. Windows & door openings are approximate. Whilst every care is taken in the preparation of this plan, please check all dimensions, shapes & compass bearings before making any decisions reliant upon them.

### For Clarification

We wish to inform prospective tenants that we have prepared these particulars as a general guide and they have been confirmed as accurate by the landlord. We have not verified permissions, nor carried out a survey, tested the services, appliances and specific fittings. Room sizes are approximate and measurement figures rounded: they are taken between internal wall surfaces and therefore include cupboards/shelves, etc. Accordingly, they should not be relied upon for

carpets and furnishings. It should also be noted that all fixtures and fittings, carpeted, curtains/blinds, kitchen equipment and garden statuary, whether fitted or not, are deemed removable by the landlord unless specifically itemised with these particulars. Please enquire in office or on our website for details on holding deposit and tenancy deposit figures.

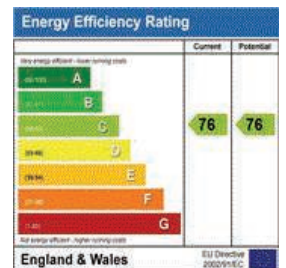



Awaiting Photograph