

ROBERTSON PHILLIPS
Estate Agents, Valuers,
Lettings and Property Management

40 Station Road, North Harrow,
Middlesex, HA2 7SE
Tel: 0208 863 1122

Email: harrow@robertsonphillips.co.uk

Harrow Lettings: 0208 092 4045
Hatch End/Pinner Sales: 0208 428 7161

**ROBERTSON
PHILLIPS**
Est. 1991

BROADFIELDS, NORTH HARROW



Three Bedroom Semi Detached House GUIDE PRICE £550,000



www.robertsonphillips.co.uk



Description

A three bedroom semi detached house offered for sale in need of refurbishment with lots of potential to extend to the rear and into the loft (stpp). No Upper Chain and located within moments of Headstone Lane BR station the house has two reception rooms and a shared driveway leading to a concrete base suitable for a garage or similar outbuilding. Benefits to the property include gas central heating and double glazed windows and an enviable location close to facilities.



Location: Broadfields can be reached via Headstone Lane. Headstone Lane runs between Old Hatch End and North Harrow. Is just a moments walks from Headstone Lane Station on the Overground Line and is within the catchment area to sought after schooling.





- *Three bedroom semi detached house*
- *Gas central heating and double glazed windows*
- *Ample scope to extend (stpp)*
- *No Upper Chain*
- *In need of updating,*



Additional Information

TENURE. FREEHOLD
LOCAL AUTHORITY. LONDON BOROUGH OF HARROW
ENERGY EFFICIENCY RATING. D

Ground Floor

Approx. 39.1 sq. metres (420.6 sq. feet)

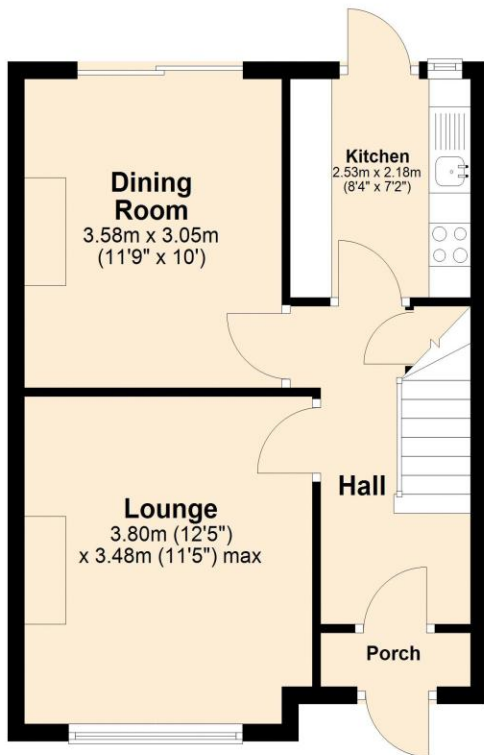

First Floor

Approx. 38.9 sq. metres (418.5 sq. feet)

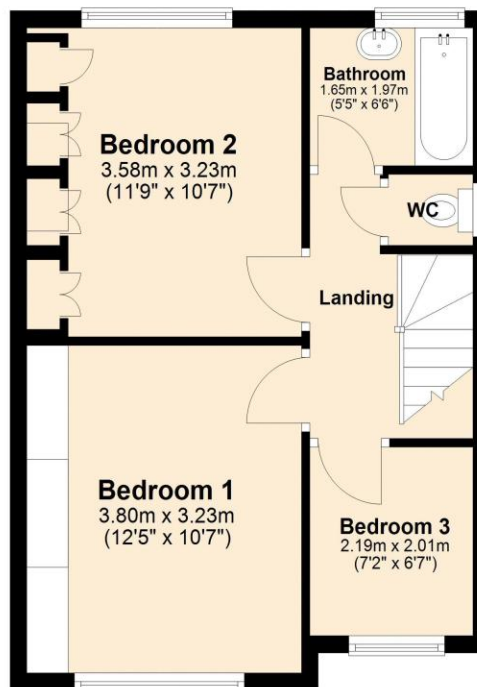

Total area: approx. 78.0 sq. metres (839.1 sq. feet)



We have not sought to verify the legal title of the property, the existence of planning permissions and/or building regulation approvals and have been unable to check the working condition of any services or appliances.

Property layouts are for general guidance and are not drawn exactly to scale. Measurements are taken at the widest points and bays, alcoves, wardrobes etc. may not be shown.