

Situated in a private sought-after location in Alverstone on a substantial plot with possible development potential (subject to relevant permissions), is this four bedroom detached property.

The Accommodation Comprises:-

Front door to:

Entrance Porch:- 10' 3" x 8' 0" (3.12m x 2.44m)

Windows to front and side elevation, solid door to:

Entrance Hall:-

Parquet flooring, stairs to first floor, under-stairs storage cupboard with further recess under-stairs, storage cupboard with hanging rail, radiator, door to:

Cloakroom:- 6' 10" x 3' 0" (2.08m x 0.91m)

Window to entrance porch, low level WC, wash hand basin, radiator, lino flooring.

Lounge/ Diner:- 27' 10" x 21' 9" (8.48m x 6.62m) maximum measurements (L-shaped)

Lounge area 21' 9" x 12' 5" (6.62m x 3.78m) Dining area 13' 0" x 9' 10" (3.96m x 2.99m)

Double doors and windows to rear garden, window to front and side elevation, continuation of parquet flooring, serving hatch from kitchen, open fire set in stone surround.

Kitchen:- 12' 11" x 9' 10" (3.93m x 2.99m) maximum measurements

Window to rear elevation, fitted with a range of base cupboards and matching eye level units, stainless steel sink unit with mixer tap, space for oven, fridge/ freezer, radiator, tiled flooring, door to:

Utility Room:- 10' 5" x 8' 9" (3.17m x 2.66m) maximum measurements

Door and window to rear garden, space and plumbing for washing machine, space for tumble dryer, worksurface over, butlers sink, storage cupboard with shelving.

Second Reception Room:- 18' 11" x 13' 0" narrowing to 12' 1" (5.76m x 3.96m)

Window to front elevation, window to entrance porch, radiator, door to:

Inner Hall:-

Door to:

Bedroom Four:- 13' 4" x 8' 5" (4.06m x 2.56m) maximum measurements

Window to front and side elevation, radiator, built-in storage cupboard with shelving.

Shower Room:- 7' 4" x 5' 2" (2.23m x 1.57m) maximum measurements

Obscured window to side elevation, low level WC, wash hand basin set in vanity unit, shower unit, tiled flooring, radiator.

First Floor Landing:-

Access to loft space, airing cupboard with shelving.

Bedroom One:- 14' 4" x 13' 0" (4.37m x 3.96m) maximum measurements

Window to side elevation, built-in wardrobes, access to eaves storage, radiator.

Bedroom Two:- 13' 0" x 11' 3" (3.96m x 3.43m) plus eaves recess

Window to side elevation, built-in wardrobes, eaves recess, access to further eaves storage, radiator.

Bedroom Three:- 11' 8" x 8' 0" plus recess (3.55m x 2.44m)

Window to front elevation.

Bathroom:- 9' 3" x 5' 5" (2.82m x 1.65m)

Two windows to rear elevation, four-piece suite comprising low level WC, bidet, pedestal wash hand basin, panelled bath with shower connection off, chrome ladder style radiator, two further radiators.

Outside:-

The property is set within an extensive and attractive plot (approximately 0.8 of an acre) with wrap around gardens laid to lawn, a vast range of mature trees and bushes, garage, ample parking and turning area.



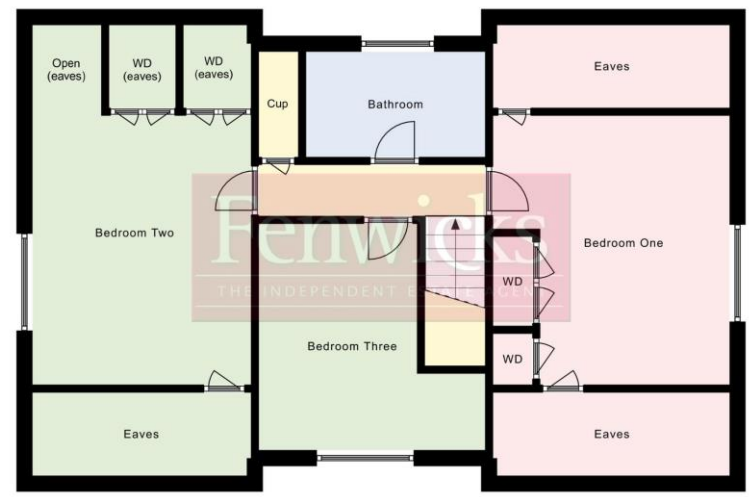

Guide only This may not represent the exact shape and size of the plot. We would strongly suggest before any purchase or expense that all interested parties view the official title plan for a better understanding.

Score	Energy rating	Current	Potential
92+	A		
81-91	B		
69-80	C		80 C
55-68	D	57 D	
39-54	E		
21-38	F		
1-20	G		

Tenure: Freehold

Council Tax Band: G

Disclaimer: These particulars are set out as a general outline in accordance with the Consumer Protection from Unfair Trading Regulations 2008 (CPR's) and Business Protection from Misleading Marketing Regulations 2008 (BPR's) only for the guidance of intending purchasers or lessees, and do not constitute any part of an offer or contract. Details are given without any responsibility, and any intending purchasers, lessees or third parties should not rely on them as statements or representations of fact, but must satisfy themselves by inspection or otherwise as to the correctness of each of them.

We have not carried out a structural survey and the services, appliances and specific fittings have not been tested. All photographs, measurements, floor plans and distances referred to are given as a guide only and should not be relied upon for the purchase of carpets or any other fixtures or fittings. Gardens, roof terraces, balconies and communal gardens as well as tenure and lease details cannot have their accuracy guaranteed for intending purchasers. Lease details, service ground rent (where applicable) are given as a guide only and should be checked and confirmed by your solicitor prior to exchange of contracts.

No person in the employment of Fenwicks Estates Ltd has any authority to make any representation or warranty whatever in relation to this property. Purchase prices, rents or other prices quoted are correct at the date of publication and, unless otherwise stated, exclusive of VAT.

Data Protection: We retain the copyright in all advertising material used to market this Property.

Money Laundering Regulations 2017: Intending purchasers will be required to produce identification documentation once an offer is accepted.



£705,000

Kennedy Crescent, Alverstoke, Gosport, PO12 2NN

Draft Details

Fenwicks - Gosport Office: 02392 529889 www.fenwicks-estates.co.uk

Fenwicks

THE INDEPENDENT ESTATE AGENT