



Ashtons

Heath Moor Drive, Fulford, York, YO10 4NQ

Heath Moor Drive Fulford, York YO10 4NQ

£325,000



Located in the ever popular residential area of Fulford, this two bedroom semi detached bungalow offers well proportioned accommodation and sits within easy reach of the University of York, a range of local amenities and excellent transport links into York city centre and the A64.

The property is accessed via an entrance hallway which opens into a generous living room located at the front of the home, providing a bright and welcoming space for both relaxing and entertaining.

Leading off the living room is the fitted kitchen, offering a range of wall and base units with complementary work surfaces, as well as space for freestanding appliances.

Continuing through the property offers a modern shower room fitted with a three piece suite, along with a useful dressing room which provides excellent additional storage and could easily be utilised as a study or hobby space.

Externally, the property occupies a great corner plot, offering generous outdoor space with gardens to the front, side and rear, which enhance both the privacy and overall appeal of the home. The rear garden provides a particularly pleasant and private outdoor area, ideal for relaxing or entertaining. A driveway provides convenient off-street parking and leads to a detached garage, offering useful additional storage or secure parking. The combination of the corner position, multiple garden areas and ample parking makes the external space a standout feature of this property.

Offered for sale with no onward chain, this property presents an excellent opportunity to acquire a bungalow in one of York's most sought after residential locations.

Early viewing is highly recommended.

Council Tax Band C





Heath Moor Drive Fulford, York YO10 4NQ

Freehold
Council Tax Band - C

- Semi-Detached Bungalow
- Two Bedrooms
- Spacious Living Room
- Conservatory
- Dressing Room / Study
- Driveway & Detached Garage
- Popular Fulford Location
- No Onward Chain
- EPC D

GROUND FLOOR
783 sq.ft. (72.8 sq.m.) approx.

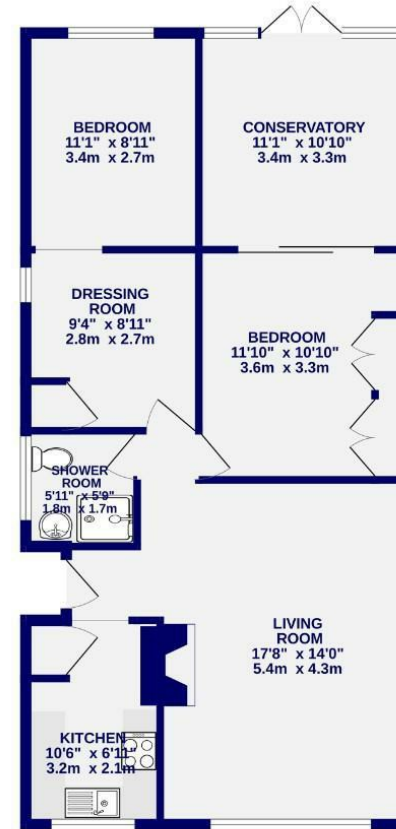

TOTAL FLOOR AREA - 783 sq.ft. (72.8 sq.m.) approx.
Whilst every attempt has been made to ensure the accuracy of the floorplan, measurements of rooms and any other items are approximate. If included in the plan the garage/porch will form part of the overall floor area and no responsibility is taken for any error, omission or mis-statement. This plan is for illustrative purposes only and should be used as such by any prospective purchaser. The services, systems and appliances shown have not been tested and no guarantee as to their operability.
Made with Metrepx ©2025

These particulars have been prepared as accurately and as reliably as possible, but should not be relied upon as 'statement of fact'. If there is any point which is of particular importance to you, please contact the office and we would be pleased to check the information. We have not tested any services, appliances, equipment or facilities and nothing in these particulars should be deemed to be a statement that they are in good working order, or that the property is in good structural condition or otherwise. Any areas, measurements, floor plans or distances referred to are given as a guide only and are not precise. Purchasers must satisfy themselves by inspection or by otherwise regarding the items mentioned above and as to the correctness of each of the statements contained in these particulars. No person in the employment of Ashtons has any authority to make or give any representation or warranty whatsoever in relation to this property or these particulars nor enter into any contract relating to the property on behalf of the vendor.