



**GASCOIGNE
HALMAN**

19 WATER GARDEN, ALDERLEY PARK, NETHER
ALDERLEY

THE AREAS LEADING ESTATE AGENT



19 WATER GARDEN, ALDERLEY PARK, NETHER ALDERLEY

An impressive two-bedroom apartment, situated within this exclusive development. Boasting accommodation presented to the highest possible standard, with a generous, south-facing covered terrace with views overlooking the water garden and beyond.

Alderley Park development which is a truly magnificent site unlike any other in the area. Residents enjoy unrestricted use of the 200+ acres of parkland, with mature woodland, rolling fields and a lake. As well as open space to explore there is also on site amenities such as the popular public house, The Churchill tree. Furthermore, there is an on site state of the art gym and access to hot-desking opportunities within the business site.



Alderley Edge offers a wide range of high quality shops and restaurants, with more extensive facilities in nearby Wilmslow. Marks and Spencer, Tesco and John Lewis are a short drive away. The village has a range of social and recreational facilities, and local schools cater for children of all ages. Alderley Edge is well placed for easy access to Manchester and Stockport, the M56 is accessible at Ringway and the M6 at Holmes Chapel. Alderley Edge train station offers a fast electric commuter service with Inter City links available in Wilmslow. Manchester International Airport is only a short drive away.



DESCRIPTION

A remarkable second-floor apartment within an exclusive, executive development constructed by the highly regarded property developers PJ Livesey. Crafted with attention to detail, the property is oriented to capture stunning views over the water gardens to the rear, ensuring a luxurious living environment. The development itself is a true sanctuary, combining architectural elegance with beautifully landscaped surroundings, making it highly sought after for those who value both privacy and refinement.

Upon entering the building, residents are welcomed into an impressive communal reception area, styled with lounge seating and direct access to the secure car parking garage. With lift access to all floors, the sophisticated design of this shared space sets the tone for the quality of the development as a whole, creating an inviting ambiance that feels immediately welcoming.

A private entrance hall provides access to all rooms. Practicality has also been prioritised, with multiple storage cupboards. The principle living space offers generous open plan living. The lounge area enjoys a large, glazed window and sliding glazed door that both frame the views over the water garden, filling the space with natural light and providing seamless access to the covered terrace. An ideal dining area flows effortlessly into a state of the art kitchen, fitted with quartz worktops and a wide array of eye and base units. Integrated Siemens appliances and high-quality fixtures elevate the kitchen to the highest specification, embodying both style and functionality. Beyond the kitchen lies a dedicated utility room, designed to discreetly house additional white goods and provide practical storage.

The property features two well-appointed bedrooms, each thoughtfully designed to maximize space and comfort. The master bedroom is a true retreat, complete with a walk-in wardrobe and a private sliding door that opens onto the terrace, allowing for views of the water garden and surrounding landscape. The luxurious ensuite includes underfloor heating, a walk-in wet area and matching double sinks, adding to the suite's refined feel. The second bedroom, generous in size, also benefits from direct access to the terrace and similar picturesque views. The main bathroom, styled to the same high standard, offers both a bath and an overhead shower, completing the property's impressive array of amenities.

One of the most captivating features is the south-facing covered terrace, which can be accessed from all the main living areas. This terrace offers a peaceful spot to relax and enjoy the views over the water gardens, creating a perfect blend of indoor and outdoor living. The property comes with two dedicated secure parking space within the garage, adding further convenience.

Beyond the development itself, residents have access to a wealth of outdoor amenities within Alderley Park, from walking trails and footpaths to beautifully landscaped communal gardens. Nearby, the Churchill Tree gastropub provides a cosy spot for dining, and additional facilities such as paddle courts and a gym add to the appeal of this vibrant community. This exceptional property offers an unparalleled combination of privacy, luxury, and a connection to the natural beauty surrounding it.

DIRECTIONS

SAT NAV: SK10 4JY

LOCAL AUTHORITY

Cheshire East Council

TAX BAND

Band: F

TENURE

Leasehold. 991 years remaining. Ground Rent £1pa

SERVICE CHARGE

£280 pm

VIEWINGS

Viewing strictly by appointment through the Agents.

GROUND FLOOR
1218 sq.ft. (113.1 sq.m.) approx.

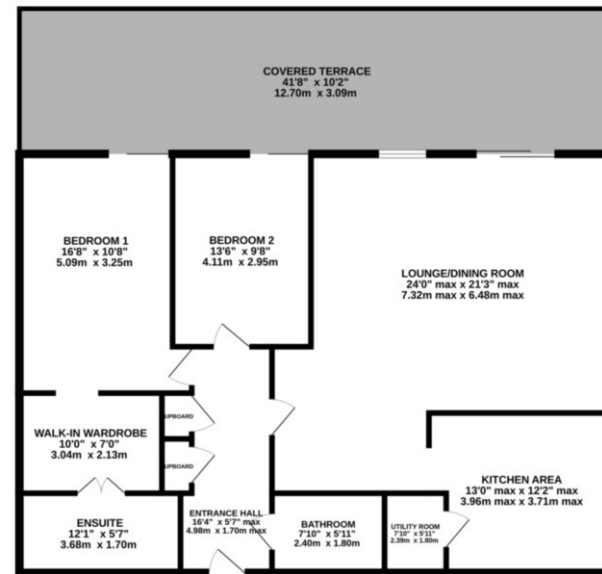

TOTAL FLOOR AREA: 1218 sq ft. (113.1 sq.m.) approx.
Measurements are approximate. Not to scale. Illustrative purposes only.
Made with Hergo 12/23.

NOTICE Gascoigne Halman for themselves and for the vendors or lessors of this property whose agents they are give notice that: (i) the particulars are set out as a general outline only for the guidance of intending purchasers or lessees, and do not constitute, nor constitute part of, an offer or contract; (ii) all descriptions, dimensions, references to condition and necessary permissions for use and occupation, and other details are given in good faith and are believed to be correct but any intending purchasers or tenants should not rely on them as statements or representations of fact but must satisfy themselves by inspection or otherwise as to the correctness of each of them; (iii) no person in the employment of Gascoigne Halman has any authority to make or give any representation or warranty whatever in relation to this property.

ALDERLEY EDGE OFFICE

01625 590 373

alderley@gascoignhalman.co.uk

6 London Road, Alderley Edge, Cheshire, SK9 7JS

**GASCOIGNE
HALMAN**