

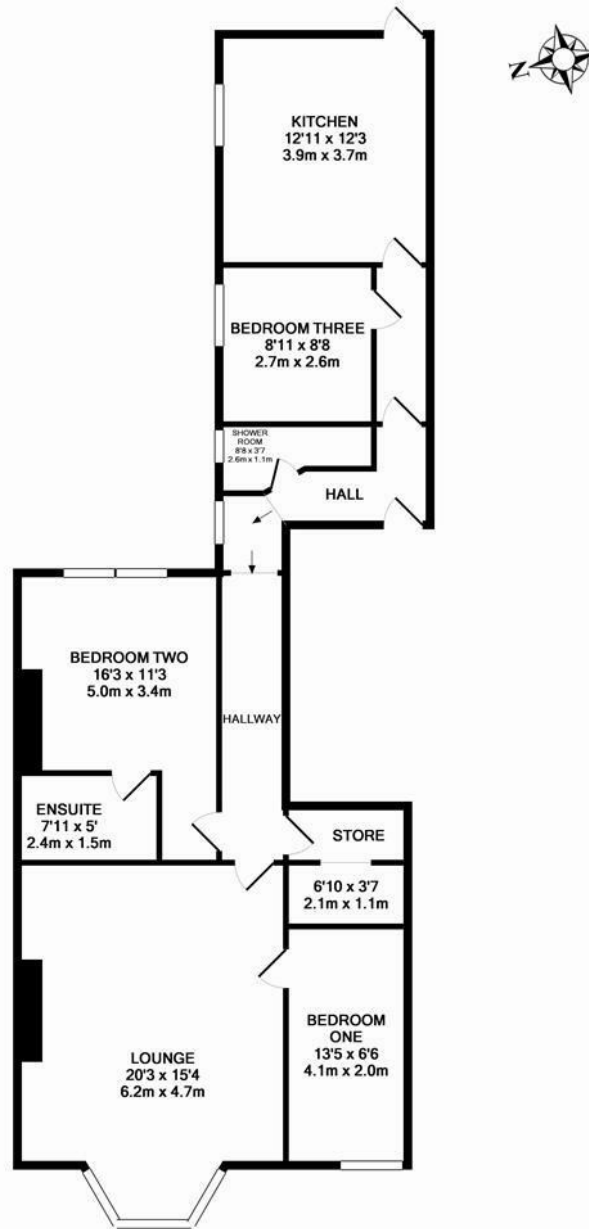

**\*\*AVAILABLE AUGUST 2026\*\*** **\*\*£145pppw\*\***  
**\*\*FURNISHED\*\*** A smart and spacious first floor conversion flat, with three double bedrooms, found in central Jesmond!

The accommodation briefly comprises an entrance hall. Three large double bedrooms one with en suite bathroom. There is a large lounge at the front of the apartment with feature fireplace, a modern fitted dining kitchen with integrated appliances and a dining table & chairs. There is also a separate shower room WC. Externally there is a shared rear yard and on street permit parking to the front.

Available 13th August 2026 | £145pppw/  
 £1,885pcm | First Floor Apartment | 975 Sq. ft  
 (90.6m<sup>2</sup>) | Furnished | Lounge | Dining Kitchen |  
 Shower Room WC | Three Double Bedrooms |  
 En Suite Bathroom | Permit Parking | Great  
 Location | Student Sharers | Council Tax Band: C  
 | EPC Rating: C



TOTAL APPROX. FLOOR AREA 975 SQ.FT. (90.6 SQ.M.)

Whilst every attempt has been made to ensure the accuracy of the floor plan contained here, measurements of doors, windows, rooms and any other items are approximate and no responsibility is taken for any error, omission, or mis-statement. This plan is for illustrative purposes only and should be used as such by any prospective purchaser. The services, systems and appliances shown have not been tested and no guarantee as to their operability or efficiency can be given.  
 Made with Metropix ©2016

**£1,885 PCM**

**IMPORTANT NOTE:** These particulars and the descriptions and measurements herein do not constitute representation and whilst every effort has been made to ensure accuracy, this cannot be guaranteed.

