



Broom Road, TW11

£809,950

A wonderful cottage situated beside Teddington Lock and presented in excellent condition. There is exceptional living / entertaining space and two double bedrooms.

Broom Road is situated just off Ferry Road, running parallel to Kingston Road. Teddington High Street and mainline station are close by.

Features

- No Onward Chain
- Freehold
- Off Street Parking
- Close To The River
- Two Double Bedrooms
- Central Location



Broom Road, TW11

You enter the house into an impressive split level kitchen/dining room with a pretty fireplace and a built in snug area under the stairs, it is exceptionally spacious and light. The reception room is off to the side with another fireplace and doors onto the secluded garden which if preferred could be used as an off street parking space.

Upstairs there are two double bedrooms, both including fitted wardrobes and then a bathroom. A loft room with Velux window provides plenty of storage or could be made into a study for a perfect area to work from home.

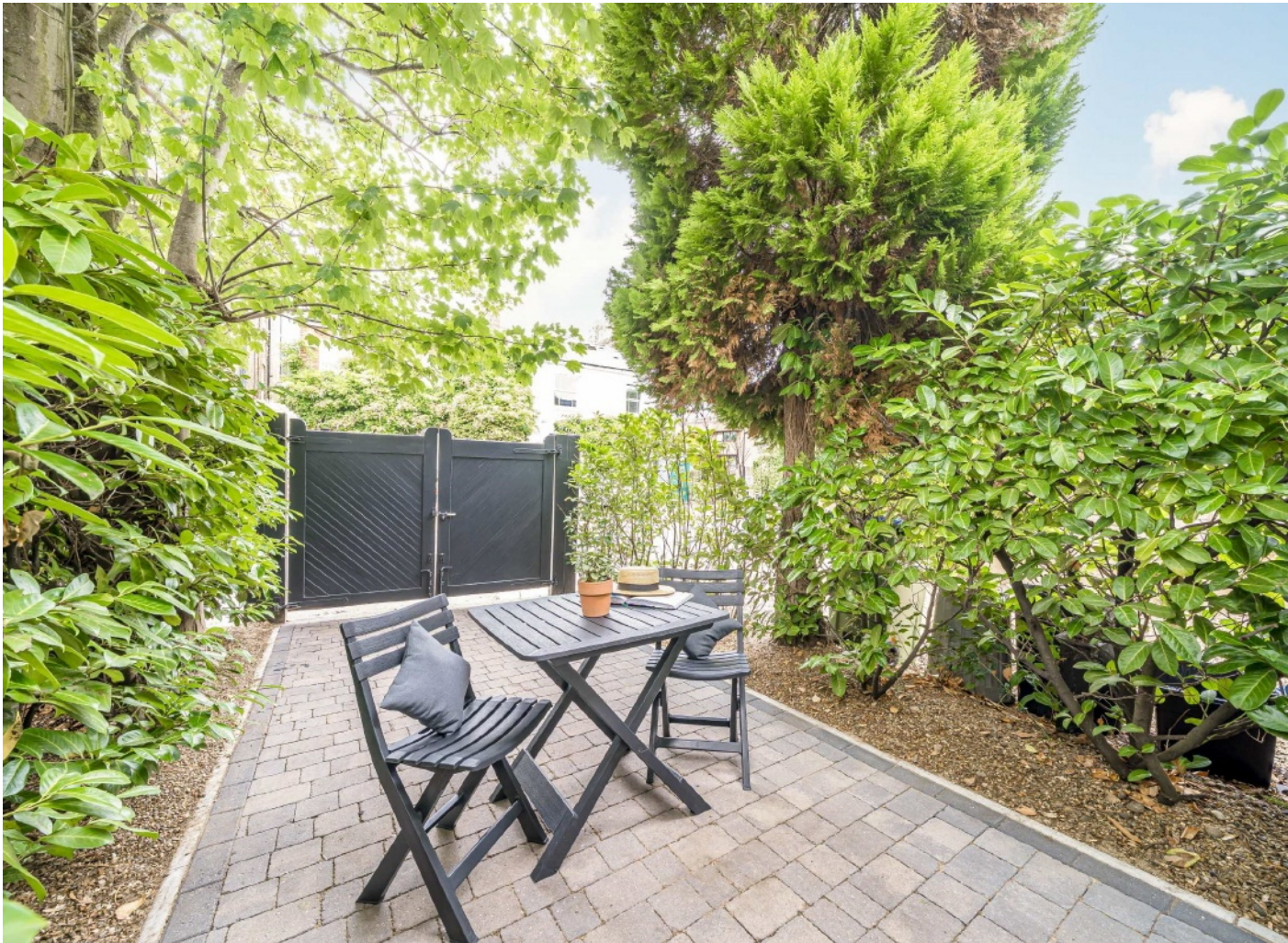

Broom Road, Teddington, TW11

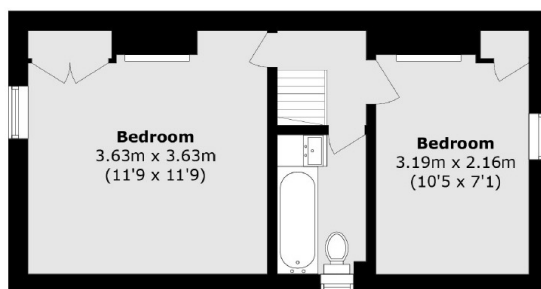

First Floor

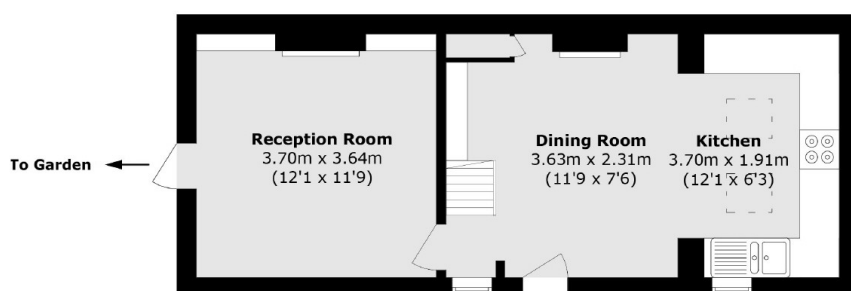

Ground Floor

Total area (approx.): 64.2 sq. m (691.0 sq. ft)