



212 Herlwyn Avenue, Ruislip - HA4 6HJ  
£350,000



**LAWRENCE RAND**



## 212 Herlwyn Avenue

Ruislip, Ruislip

- Ground Floor
- Two Bedrooms
- Garden
- Close To Local Amenities
- New lease

This well-presented and generously proportioned ground-floor maisonette offers bright and spacious accommodation throughout with direct access to garden. The property is accessed via a private entrance leading directly into a spacious reception room, creating a welcoming and open feel and is being sold with a new lease.

Further into the property, a central hallway provides access to the principal bedroom, featuring a large bay window overlooking the rear garden, a fitted kitchen with direct access to the outside, and a modern bathroom comprising a white three-piece suite, the property is suitable for first time buyers, buy to let investors and downsizers.



The property benefits from a private rear garden, featuring a paved patio area, a well-maintained lawn, and a pathway—ideal for outdoor relaxation and entertaining.

Herlwyn Avenue is a sought-after residential road, perfectly positioned just moments from Ruislip High Street, offering a wide selection of shops, cafés, and restaurants. Excellent transport links are nearby, including Metropolitan and Piccadilly Line services providing direct access into London. Additional Central Line and National



## 212 Herlwyn Avenue

Ruislip, Ruislip

Nearest Stations Ruislip Manor Station – approx 0.3 miles  
Ruislip Station – approx 0.7 miles South  
Ruislip Station – approx 0.9 miles

Nearest Stations Ruislip Manor Station – approx 0.3 miles  
Ruislip Station – approx 0.7 miles South  
Ruislip Station – approx 0.9 miles  
Council Tax band: C

Tenure: Leasehold

EPC Energy Efficiency Rating: D

EPC Environmental Impact Rating: D



## Herlwyn Avenue, Ruislip, HA4

APPROX. GROSS INTERNAL FLOOR AREA 525 SQ FT 48.7 SQ METRES

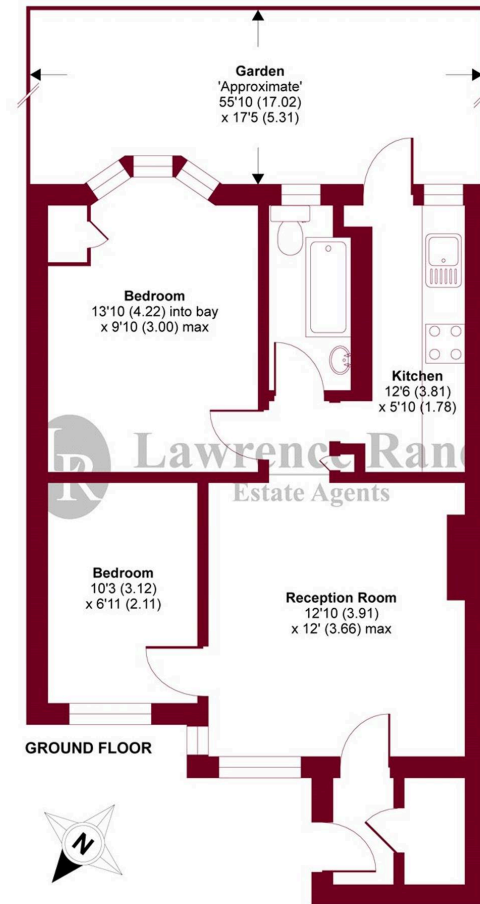

Whilst every attempt has been made to ensure the accuracy of the floor plan contained here, measurements of doors, windows and rooms are approximate and no responsibility is taken for any error, omission or misstatement. These plans are for representation purposes only as defined by RICS Code of Measuring Practice and should be used as such by any prospective purchaser. Specifically no guarantee is given on the total square footage of the property if quoted on this plan. Any figure given is for initial guidance only and should not be relied on as a basis of valuation.

Copyright nichecom.co.uk 2015 Produced for Lawrence Rand Estate Agents REF : 42914

**Lawrence Rand**  
51 Victoria Road, Ruislip - HA4 9BH

01895 632211

Info@lawrence-rand.co.uk

www.lawrence-rand.co.uk/

Lawrence Rand Limited has made every reasonable effort to ensure the accuracy of the information provided. However, we accept no responsibility for errors, omissions, or misstatements. All measurements, distances, and descriptions are approximate and for guidance only. Prospective purchasers or tenants must verify all details independently. Some images may include AI-generated virtual staging to illustrate the potential of the property and are for visual guidance only. No warranty is given or implied, and these particulars do not form part of any offer or contract. Lawrence Rand reserves the right to amend or withdraw any property without notice.