



honners & babingtons

Wallace Close
Marlow



Wallace Close
Marlow
Buckinghamshire
SL7 1TY

Tenure: Freehold
Price: OIEO £400,000
Local Authority: BCC
Tax Band: C
EIR: 71



A three-bedroom terraced home located approximately one mile east of Marlow Town Centre, offering an ideal opportunity for first-time buyers or investors.

This delightful property features a welcoming living room, a separate dining room, and a functional kitchen, providing versatile spaces perfect for everyday living and entertaining. Upstairs, you'll find three good-sized bedrooms and a family bathroom. To the rear, the property boasts a low-maintenance garden, ideal for relaxing or al fresco dining, and enjoys the added benefit of views overlooking a park, enhancing the sense of space and greenery.

With its convenient location, practical layout, and attractive outlook, this home represents an excellent purchase for those seeking comfort, convenience, and long-term potential in the Marlow area.

Marlow town centre is a thriving and stylish riverside community with a comprehensive range of shops and excellent pubs and restaurants. Nearby Marlow Station has a regular train service to London Paddington via Maidenhead (from 44 mins) with links to the City of London, via the Elizabeth Line. Access to the M4 and M40 is via the A404(M) and London Heathrow is approximately 22 miles away. There is a wide range of educational and recreational facilities in the area. Excellent local schools are numerous and include Sir William Borlase in Marlow.





Ground Floor

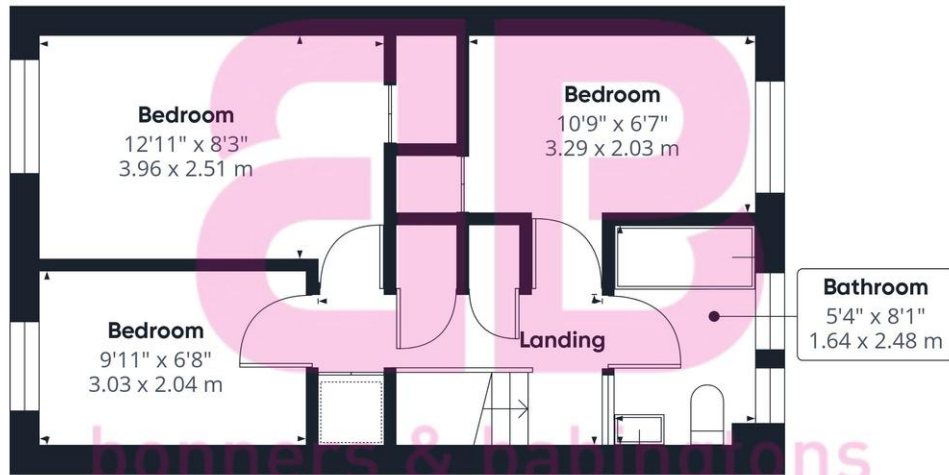

Floor 1



Approximate total area⁽¹⁾
774 ft²
71.8 m²

(1) Excluding balconies and terraces

Calculations reference the RICS IPMS 3C standard. Measurements are approximate and not to scale. This floor plan is intended for illustration only.

GIRAFFE360



bonners & babingtons

Anglers Court, Spittal Street, Marlow, Buckinghamshire, SL7 3HJ

01628 333800

marlow@bb-estateagents.co.uk



Disclaimer

We endeavour to make our particulars accurate and reliable. They are for guidance only and are intended to give a fair overall summary of the property. They do not form part of any contract or offer, and should not be relied upon as a statement or representation of fact. Measurements, areas and distances are approximate and photographs provided for guidance only. No undertaking is given as to the structural condition of the property, or any necessary consents, or the operating ability or efficiency of any service, system or appliance. Prospective purchasers must satisfy themselves with regard to each of these points. If there is any particular aspect of the property about which you would like further information, please contact us, especially, before you travel to the property. B2170