



Harwood Court

Upper Richmond Road, SW15

Asking Price £550,000

A bright and spacious three-bedroom apartment ideally located in central Putney, close to excellent transport links, local amenities and the River Thames.

CHESTERTONS



Harwood Court

Upper Richmond Road, SW15

- Ground-floor apartment
- Three well-proportioned bedrooms
- Spacious reception room
- Large open-plan kitchen and dining area
- Family bathroom with bath and shower facilities
- Chain Free
- Located in the heart of central Putney
- Moments from Putney High Street shops, cafés, bars and restaurants
- Close to Putney mainline station (Waterloo)
- Convenient for East Putney Underground station (District Line)
- Within easy reach of the River Thames and surrounding green spaces
- Excellent local bus routes nearby



Located within the popular Harwood Court development, this bright and spacious three-bedroom ground floor apartment offers generous living space in the heart of Putney, just moments from excellent amenities and transport links.

The apartment features a large reception room, ideal for both relaxing and entertaining, alongside an open-plan kitchen and dining, creating a fantastic social space at the centre of the home.

All three bedrooms are well proportioned, offering flexibility for families, guests or home working. The property is served by a family bathroom complete with both bath and shower facilities, while the overall layout provides a comfortable and practical flow throughout.

Perfectly positioned in central Putney, Harwood Court is only a short stroll from cafés, restaurants, bars and shops. Putney mainline station and East Putney Underground station are both nearby, providing fast and convenient access into Central London, while the River Thames and surrounding green spaces are also within easy reach.

Tenure: Leasehold (Expiry: 19/09/2197)

Service Charge: £2,954 p.a.

Ground Rent: Peppercorn

Local Authority: London Borough of Wandsworth

Council Tax Band: C

Score	Energy rating	Current	Potential
92+	A		
81-91	B		
69-80	C	73 c	77 c
55-68	D		
39-54	E		
21-38	F		
1-20	G		

Chestertons Putney Sales

153 Upper Richmond Road
 London
 SW15 2TX
 putney@chestertons.co.uk
 020 8246 5959
 chestertons.co.uk

Harwood Court, Upper Richmond Road, SW15

Approximate Gross Internal Area 97 sq m / 1044 sq ft

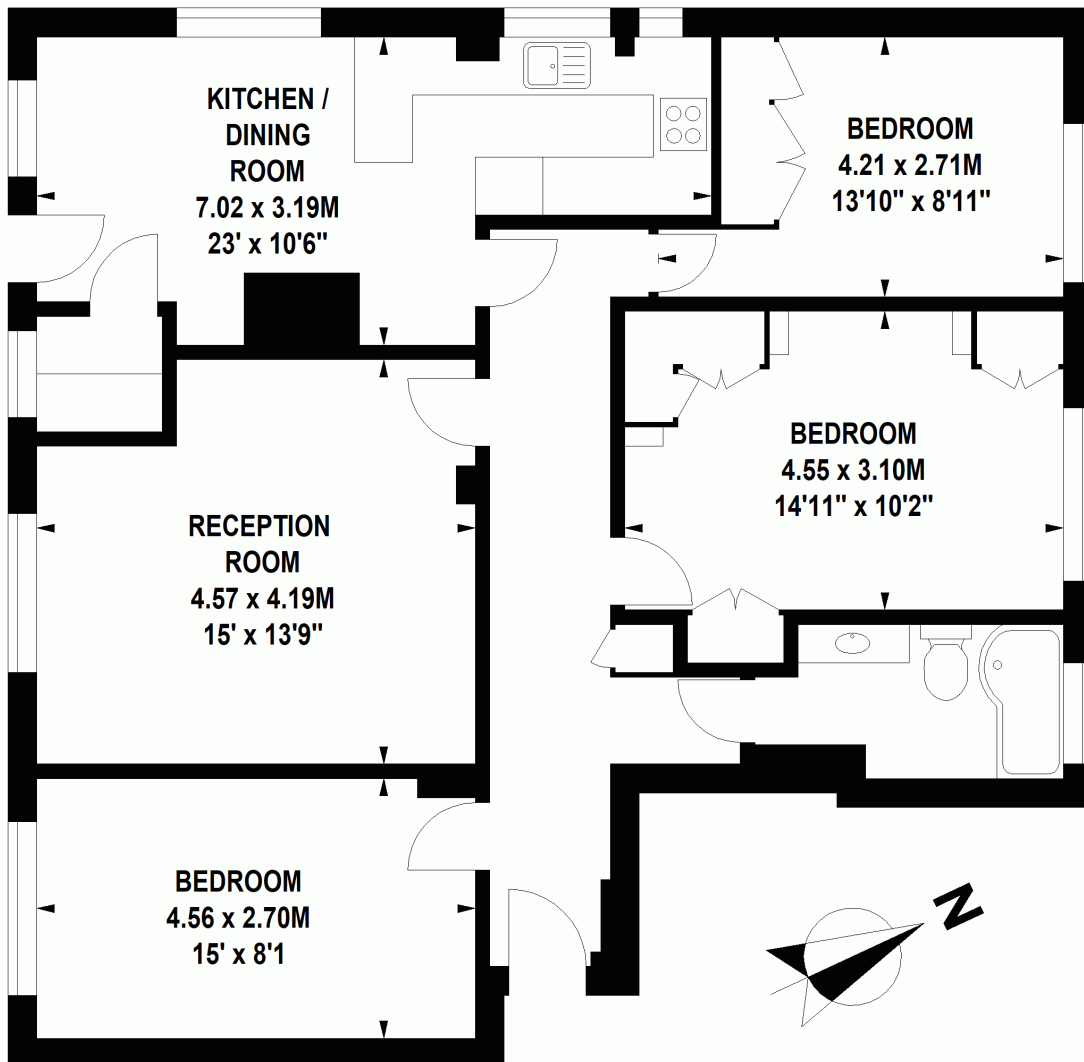

Ground Floor

Floor Plan produced for Chestertons by Mays Property Marketing © . Tel 020 3397 4594

Illustration for identification purposes only. Not to scale.

Orientation, measurements, and other details are approximate and for guidance only, purchasers should verify details independently.

Where a room has a sloping ceiling the dotted line marks 1.50M height, and all measurements shown are at floor level.

