

**TOWN & COUNTRY**  
ESTATES



**6 Nightingale Road, Trowbridge, Wiltshire, BA14 9TP**

**£360,000**

## LOCATION

Located within a sought after residential development, off of Wingfield Road, on the Bradford-on-Avon side of Trowbridge. Ideally positioned close to both Primary and Secondary Schools, bus routes and local amenities.

Trowbridge town centre and train station are also within easy reach, making this area popular with families and commuters alike.

## DESCRIPTION

NO ONWARD CHAIN - A much loved four bedroom, detached family home, found within a sought after location. The ground floor accommodation comprises a porch, entrance hall, lounge, dining room, kitchen with Worcester boiler (last serviced January 2026), conservatory and cloakroom toilet. On the first floor, there are three double bedrooms, a single bedroom with shower and a bathroom. Further benefits include gas central heating, uPVC double glazing, an enclosed rear garden, garage and driveway parking.

## ENTRANCE HALL

### LOUNGE

15'8" x 10'5"

### DINING ROOM

10'2" x 8'6"

### KITCHEN

9'10" x 8'6"

### CONSERVATORY

10'9" x 10'2"

### CLOAKROOM TOILET

### FIRST FLOOR LANDING

### BEDROOM ONE

10'2" x 9'10"

### BEDROOM TWO

9'10" x 8'10"

### BEDROOM THREE

9'6" x 7'10"

### BEDROOM FOUR

10'2" max x 7'6"

### BATHROOM

### EXTERIOR

#### FRONT

Driveway providing off road parking for one car, lawn, path to front door, gate to rear garden and outside light.

#### REAR GARDEN

Enclosed rear garden with paved patio, lawn, attractive planted borders, outside tap and wooden shed.



**GARAGE**

15'8" max x 8'10"

Up and over door, power and light.

**ADDITIONAL INFORMATION**

Council Tax Band -D

EPC to follow

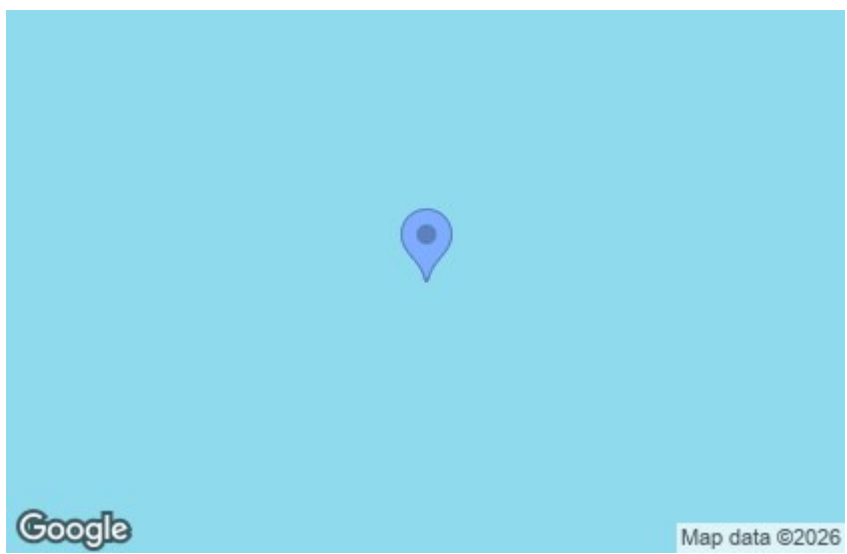





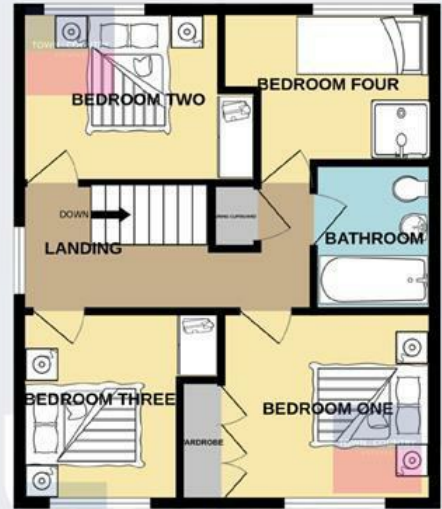

COLLIER  
 ESTATES  
 SALES & MARKETING



