



Energy Rating		
	Current	Potential
running costs		
	67	79
	D	C
	E	
	F	
	G	
sales	EU Directive 2002/91/EC	

Environmental Impact (CO ₂)	
Very environmentally friendly - lower CO ₂ emissions	
(92-100)	A
(81-91)	B
(69-80)	C
(56-68)	D
(39-54)	E
(21-38)	F
(1-20)	G
Not environmentally friendly - higher CO ₂ emissions	
England & Wales	



123 Nailsworth Crescent, Surrey, RH1 3JE
£1,100 Per Calendar Month

**** AVAILABLE JULY **** A ground floor apartment located within close proximity to local shops and amenities and Merstham railway station with mainline links to London, Brighton and the South coast. The property features a separate living and bedroom, re-fitted modern kitchen and bathroom and entry phone system.

Floor Plan

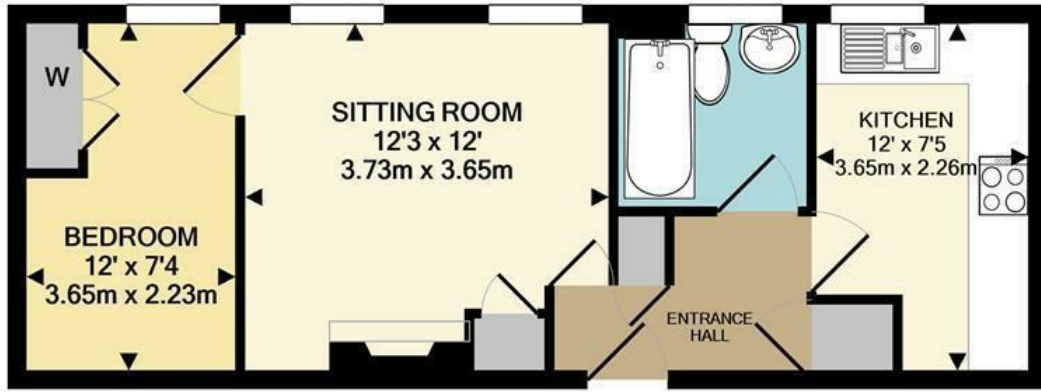

TOTAL APPROX. FLOOR AREA 399 SQ.FT. (37.1 SQ.M.)

Whilst every attempt has been made to ensure the accuracy of the floor plan contained here, measurements of doors, windows, rooms and any other items are approximate and no responsibility is taken for any error, omission, or mis-statement. This plan is for illustrative purposes only and should be used as such by any prospective purchaser. The services, systems and appliances shown have not been tested and no guarantee as to their operability or efficiency can be given
Made with Metropix ©2020

THOMAS & MAY

Area Map

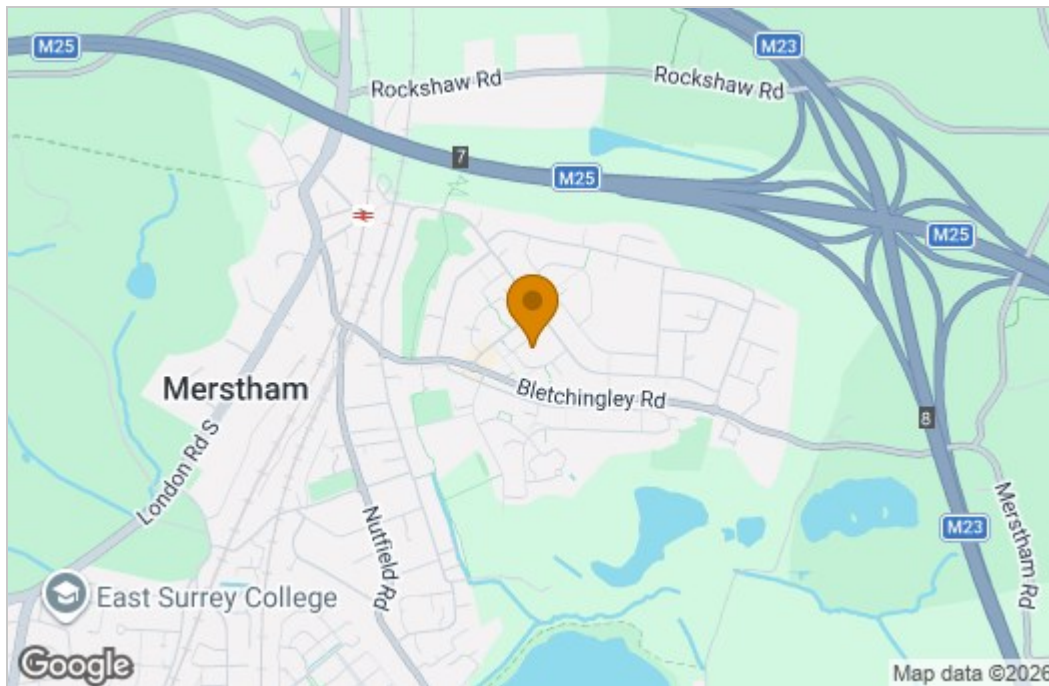

Energy Efficiency Graph

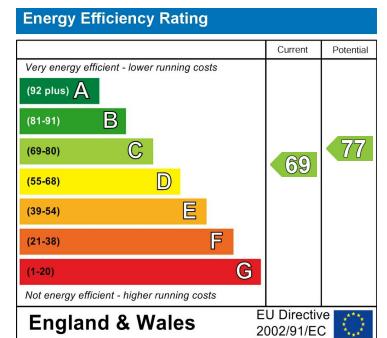

These particulars, whilst believed to be accurate are set out as a general outline only for guidance and do not constitute any part of an offer or contract. Intending purchasers should not rely on them as statements of representation of fact, but must satisfy themselves by inspection or otherwise as to their accuracy. No person in this firm's employment has the authority to make or give any representation or warranty in respect of the property.