



**£825 (From) Per Month**  
**1 Bed Apartment**  
**located in**  
**Wolverhampton Street**



  
**REDSTONES**  
The Property Experts

## Ground Floor

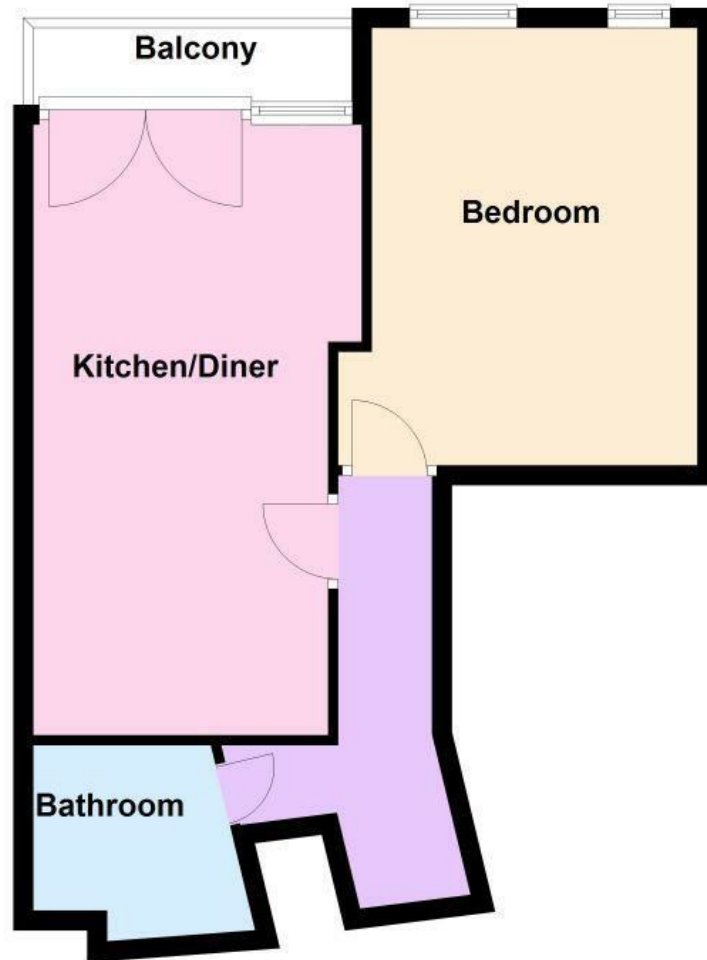

## DIRECTIONS

### CONTACT

West Midlands House  
Gipsy Lane  
Willenhall  
West Midlands  
WV13 2HA

E: [info@redstones.co.uk](mailto:info@redstones.co.uk)

T: 01922 235 350

<http://www.redstones.co.uk>

Energy Efficiency Rating		Current	Potential
<i>Very energy efficient - lower running costs</i>			
(92 plus) A			
(81-91) B			82
(69-80) C		69	
(55-68) D			
(39-54) E			
(21-38) F			
(1-20) G			
<i>Not energy efficient - higher running costs</i>			
England & Wales		EU Directive 2002/91/EC	

  
**REDSTONES**  
The Property Experts