



26 De Beauvoir Wharf 16 Hertford Road, London, N1 5QR

£490,000

- Modern apartment
- Open plan living
- Close to local amenities
- One spacious bedroom
- Private roof terrace
- An array of transport links

26 De Beauvoir Wharf 16 Hertford Road, London N1

50R

Nestled on Hertford Road in the vibrant N1 area, this modern apartment offers a perfect blend of comfort and convenience. The property features a well-appointed bedroom, a stylish bathroom, and a welcoming open plan reception / kitchen / diner that provides an ideal space for relaxation or entertaining guests. From the reception room you access the ample roof terrace with far reaching views. The contemporary design and thoughtful layout make this apartment an excellent choice for individuals or couples seeking a stylish urban retreat. With its prime location, residents will enjoy easy access to local amenities, transport links, and the lively atmosphere of the surrounding area. This property presents a wonderful opportunity for those looking to embrace modern living in a sought-after location.



Council Tax Band: C

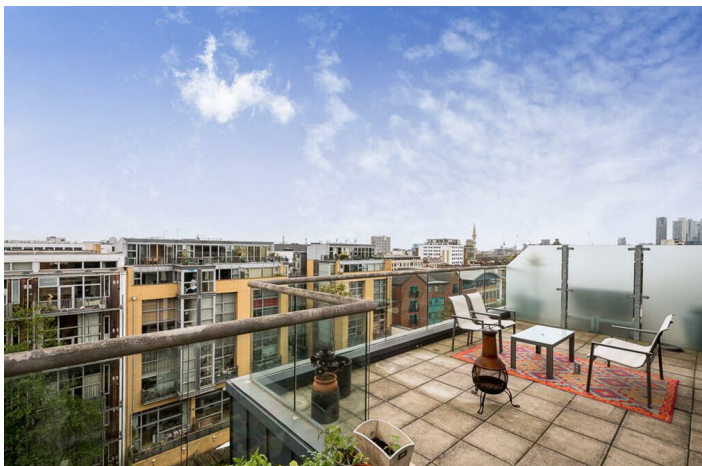

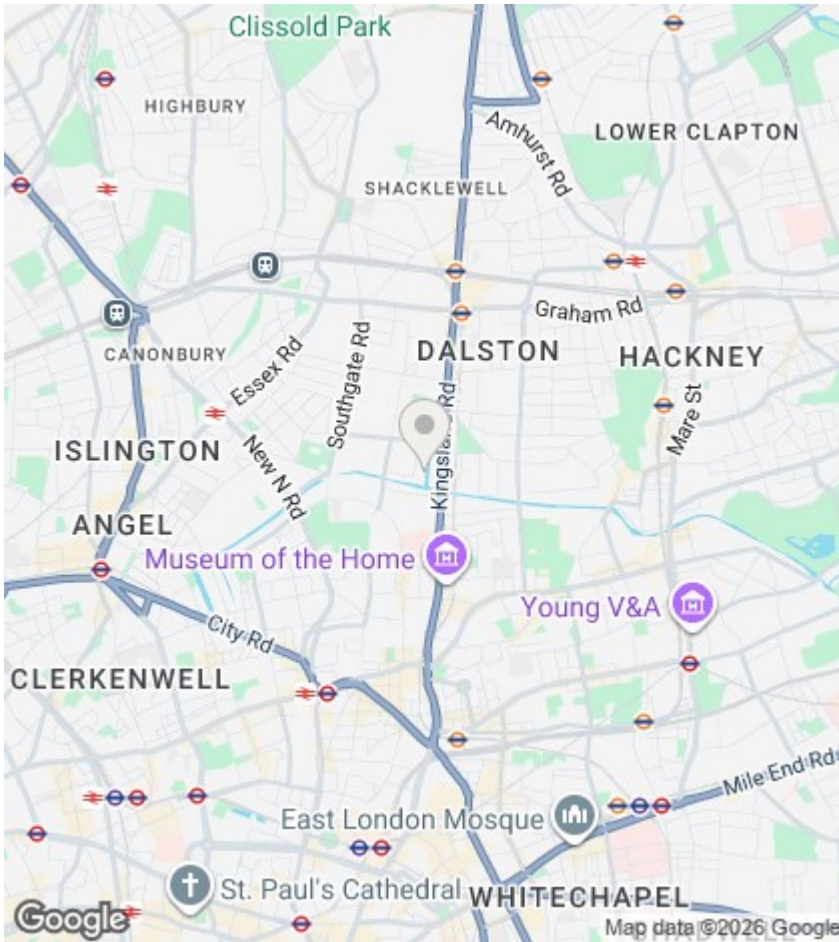

Directions

Viewings

Viewings by arrangement only. Call 020 7254 7554 to make an appointment.

EPC Rating:

Energy Efficiency Rating		Current	Potential
Very energy efficient - lower running costs			
(92 plus) A			
(81-91) B			
(69-80) C			
(55-68) D			
(39-54) E			
(21-38) F			
(1-20) G			
Not energy efficient - higher running costs			
England & Wales		EU Directive 2002/91/EC	

