



White City Estate, W12

£325,000

A spacious and well-proportioned three-bedroom purpose-built flat, ideally located in the heart of Shepherd's Bush. Recently renovated throughout by the current owner, the property offers bright and airy living spaces filled with natural light. An excellent opportunity for first-time buyers or investors alike.

Blaxland House is ideally located near Westfield White City, the BBC Centre, and a wide range of shops, restaurants, and bars. Wormholt Park is also within easy reach. Excellent transport links include quick access to the A40 and nearby Central and Hammersmith & City line stations.

Features

Offer In Excess Of
Three Double Bedrooms
No Onward Chain
Westfields Shopping Centre
Central Line
Residents Parking

White City Estate, London, W12

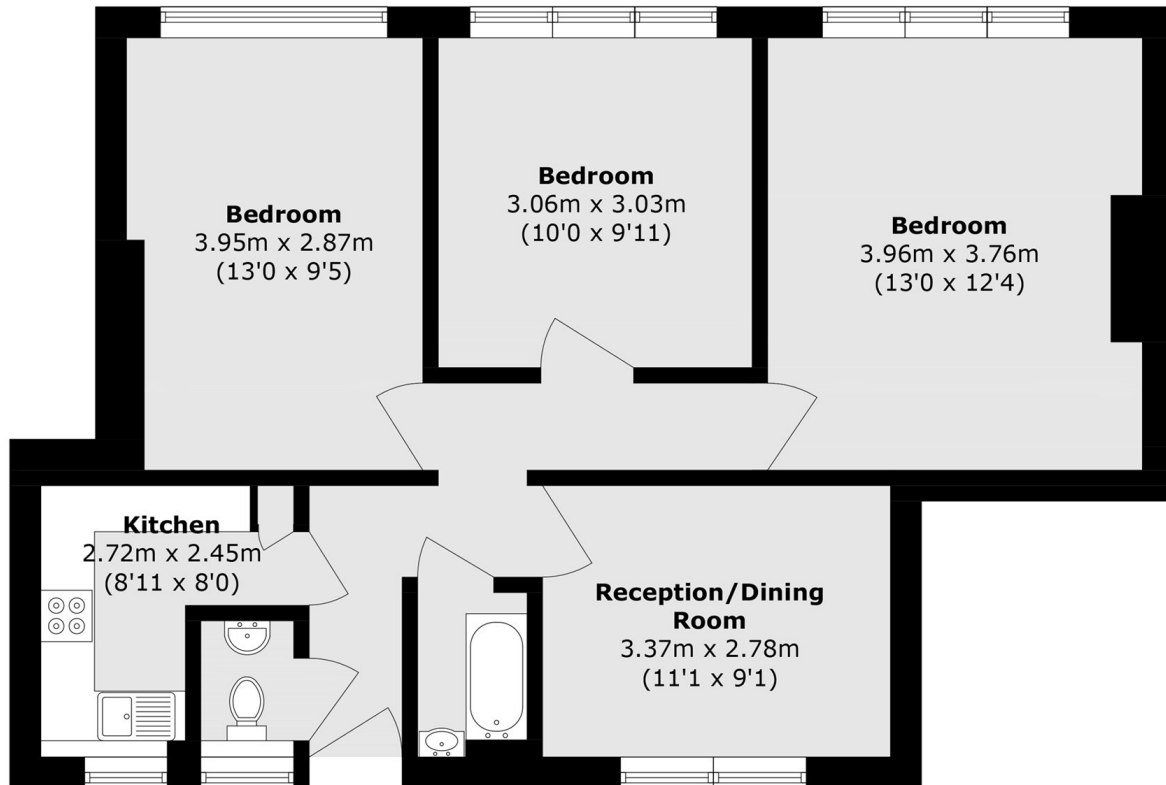

Fourth Floor

Total area (approx.): 64.1 sq. m (690.0 sq. ft)