



**Park Hill Court Park Hill Drive, Leicester LE2 8HS**

**welcome to**

## **Park Hill Court Park Hill Drive, Leicester**

Well-presented ground floor flat in Park Hill Court with two double bedrooms, a private garden area, and a practical layout. Includes intercom entry, permit parking and is ready to move into, making it ideal for first-time buyers or investors.

### **Entrance Hall**

Two storage cupboards and access to all rooms

### **Lounge**

Patio door leading to the garden and laminate flooring.

### **Kitchen**

Fitted kitchen comprising of wall and base units with work surfaces over, sink drainer unit, integrated oven, hob and extractor fan and space for further appliances. Double glazed window to the rear.

### **Bedroom One**

Double glazed window to the front and laminated flooring.

### **Bedroom Two**

Double glazed window to the front and laminated flooring.

### **Bathroom**

Bath with shower over, WC, hand wash basin, tiled flooring and partly tiled walls.

### **Parking**

To the front of the property are off road parking bays for residents.

### **Rear Of Property**

To the rear of the property is a small garden.





***view this property online*** [williamhbrown.co.uk/Property/LHS120840](http://williamhbrown.co.uk/Property/LHS120840)



welcome to

## Park Hill Court Park Hill Drive, Leicester

- Ground floor flat
- Two double bedrooms
- Private, low-maintenance garden area
- Secure fob/intercom entry
- Permit parking

Tenure: Leasehold EPC Rating: Awaited

Council Tax Band: A Service Charge: 2035.00

Ground Rent: Ask Agent

This is a Leasehold property with details as follows; Term of Lease 125 years from 28 Aug 1987.

Should you require further information please contact the branch. Please Note additional fees could be incurred for items such as Leasehold packs.

offers over

**£135,000**

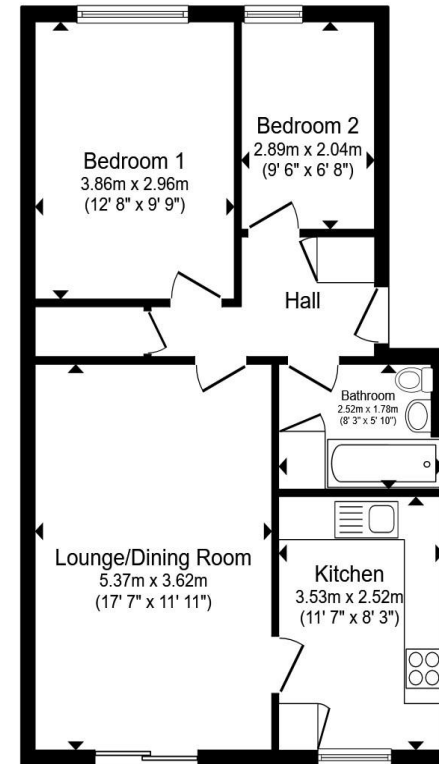

Total floor area 58.2 m<sup>2</sup> (626 sq.ft.) approx

This floor plan is for illustrative purposes only. It is not drawn to scale. Any measurements, floor areas (including any total floor area), openings and orientation are approximate. No details are guaranteed, they cannot be relied upon for any purpose and they do not form part of any agreement. No liability is taken for any error, omission or misstatement. A party must rely upon its own inspection(s). Powered by [www.propertybox.io](http://www.propertybox.io)



**view this property online** [williamhbrown.co.uk/Property/LHS120840](http://williamhbrown.co.uk/Property/LHS120840)



Property Ref:

LHS120840 - 0002

1. MONEY LAUNDERING REGULATIONS Intending purchasers will be asked to produce identification documentation at a later stage and we would ask for your co-operation in order that there is no delay in agreeing the sale. 2. These particulars do not constitute part or all of an offer or contract. 3. The measurements indicated are supplied for guidance only and as such must be considered incorrect. Potential buyers are advised to recheck measurements before committing to any expense. 4. We have not tested any apparatus, equipment, fixtures or services and it is in the buyers interest to check the working condition of any appliances. 5. Where an EPC, or a Home Report (Scotland only) is held for this property, it is available for inspection at the branch by appointment. If you require a printed version of a Home Report, you will need to pay a reasonable production charge reflecting printing and other costs. 6. We are not able to offer an opinion either written or verbal on the content of these reports and this must be obtained from your legal representative. 7. Whilst we take care in preparing these reports, a buyer should ensure that his/her legal representative confirms as soon as possible all matters relating to title including the extent and boundaries of the property and other important matters before exchange of contracts.

William H Brown is a trading name of Sequence (UK) Limited which is registered in England and Wales under company number 4268443, Registered Office is Cumbria House, 16-20 Hockliffe Street, Leighton Buzzard, Bedfordshire, LU7 1GN. VAT Registration Number is 500 2481 05.

 **william h brown**



**0116 251 4131**



[Leicester@williamhbrown.co.uk](mailto:Leicester@williamhbrown.co.uk)



16-18 Halford Street, LEICESTER, Leicestershire,  
LE1 1JB



[williamhbrown.co.uk](http://williamhbrown.co.uk)