



## Crawthew Grove, SE22

### £475,000

A beautifully presented two bedroom purpose built apartment with a private garden on one of East Dulwich's most desirable residential streets. This bright and stylish home offers a generous reception room with space for dining, a modern separate kitchen, two well proportioned bedrooms and a contemporary bathroom. The interiors have been finished to a high standard throughout, with gorgeous herringbone flooring and thoughtful design touches that create a warm and inviting feel. A standout feature is the private garden, providing an ideal space for outdoor dining, relaxing or entertaining a rare benefit for a property of this type.

Positioned on quiet and leafy Crawthew Grove, you are moments from the independent shops, cafés and restaurants of Lordship Lane, as well as excellent transport links from East Dulwich and Peckham Rye stations. Goose Green, Dulwich Park and local amenities are also close by, making this an exceptional home in a highly sought after

### Features

- Two Double Bedrooms
- Large Private Garden
- Turnkey Conditions
- Herringbone Floors
- Moments from Lordship Lane
- Long Lease

# Crawthew Grove, London, SE22

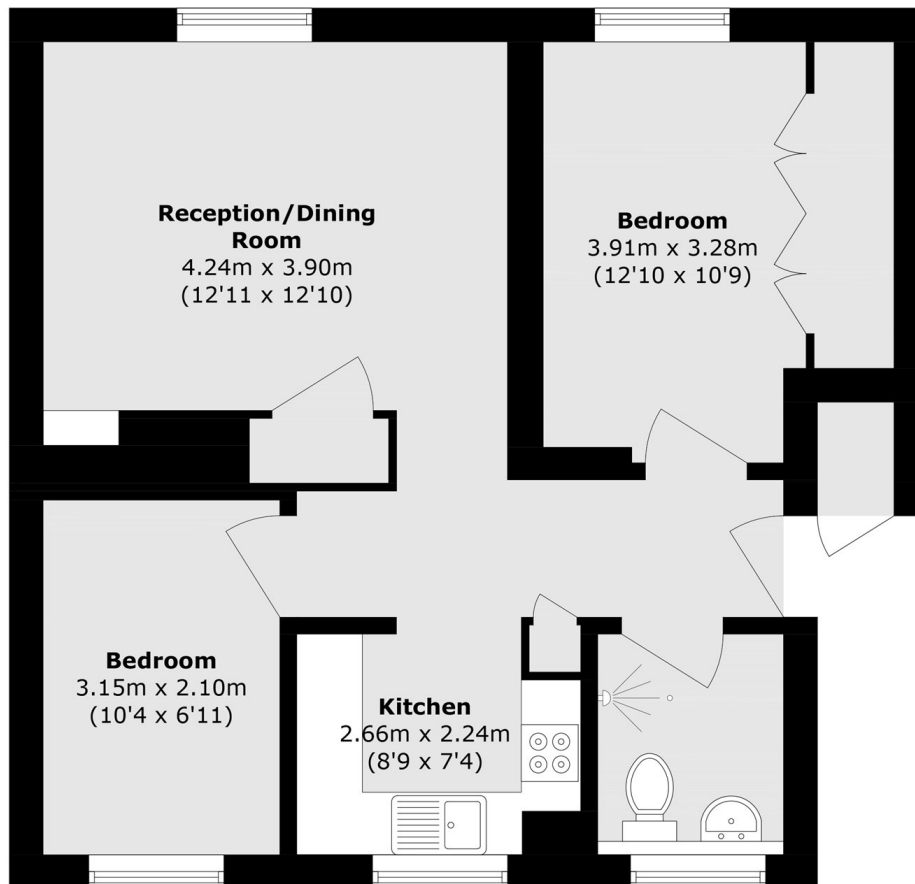

Total area (approx.): 50.2 sq. m (540.3 sq. ft)  
External Storage area (approx.): 0.7 sq. m (7.5 sq. ft)