



Luscombe Maye

Since 1873

Flat 1, Porch House, Fore Street,  
£160,000

3 1 1



- First Floor Apartment
- Well presented throughout
- Feature Entrance Porch
- No Onward Chain
- 3 Bedrooms
- Close to local amenities
- Light Sunny Spacious Apartment





Spacious 3 bed apartment in the centre of Kingsbridge ideal for a first time buyer or a investment property.

Approximate Gross Internal Area 751 sq ft - 70 sq m

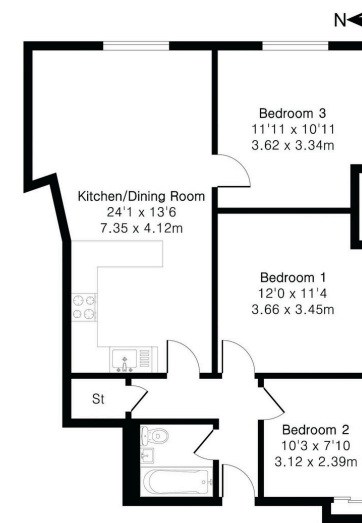

First Floor Flat

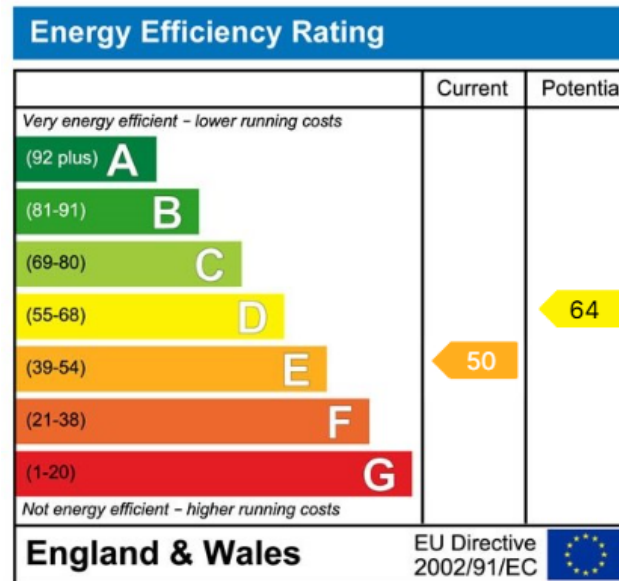

**Kingsbridge:**  
62 Fore Street, Kingsbridge TQ7 1PP  
01548 857474  
kingsbridge@luscombemaye.com  
[www.luscombemaye.com](http://www.luscombemaye.com)

Important Notice: Luscombe Maye gives notice that: 1. These particulars do not constitute an offer or contract or part thereof. 2. All descriptions, photographs and plans are for guidance only and should not be relied upon as statements or representations of fact. All measurements are approximate and not necessarily to scale. Any prospective purchaser must satisfy themselves of the correctness of the information within the particulars by inspection or otherwise. 3. Luscombe Maye does not have any authority to give any representations or warranties whatsoever in relation to this property (including but not limited to planning/building regulations), nor can it enter into any contract on behalf of the Vendor.